



FOR SALE:

2781 INNIS RD
COLUMBUS, OH 43224



CONFIDENTIALITY AND DISCLAIMER

The information contained in the following Marketing Brochure is proprietary and strictly confidential. It is intended to be reviewed only by the party receiving it from Re/Max Town Center and should not be made available to any other person or entity without the written consent of Re/Max Town Center. This Marketing Brochure has been prepared to provide summary. The information in this Marketing Brochure has been obtained from sources we believe to be reliable; however, Re/Max Town Center has not verified, and will not verify, any of the information contained herein, nor has Re/Max conducted any investigation. Information provided. All potential buyers must take appropriate measures to verify all of the information set forth herein. ALL PROPERTY SHOWINGS ARE BY APPOINTMENT ONLY.



Roya Ghodsi
(614) 470-7138
roya_ghodsi@hotmail.com

RE/MAX Town Center Commercial
4215 Worth Avenue, Suite 230
Columbus, Ohio 43219





Property Highlights

Discover a prime development opportunity with exceptional location in fast growing Columbus. This rare opportunity offers 3 contiguous parcels in the Columbus area! This property offers endless development potential—whether for residential or Multi Family. One of the last large urban tracts inside of I-270. More than eleven acres. 3.5 miles from Easton Town Center. The site is near Morse Rd and Stelzer Rd. A prime location. Easy access to I-670, I-270, I-70, I-71.

11 Acres of rare residential development land

As the Columbus continues to grow, properties with approved multifamily zoning and development-ready attributes are becoming increasingly rare. This 11-acre parcel presents an excellent opportunity for an impactful, high-return investment. This property is an ideal opportunity for developers seeking to address the growing demand for affordable housing. The site is particularly well-suited for residential or senior housing and other affordable living options, with its location offering access to essential amenities .

Water and sewer available. Multi family zoning possible.

Roya Ghodsi

(614) 470-7138 • roya_ghodsi@hotmail.com

RE/MAX Town Center Commercial

4215 Worth Avenue, Suite 230 • Columbus, Ohio 43219

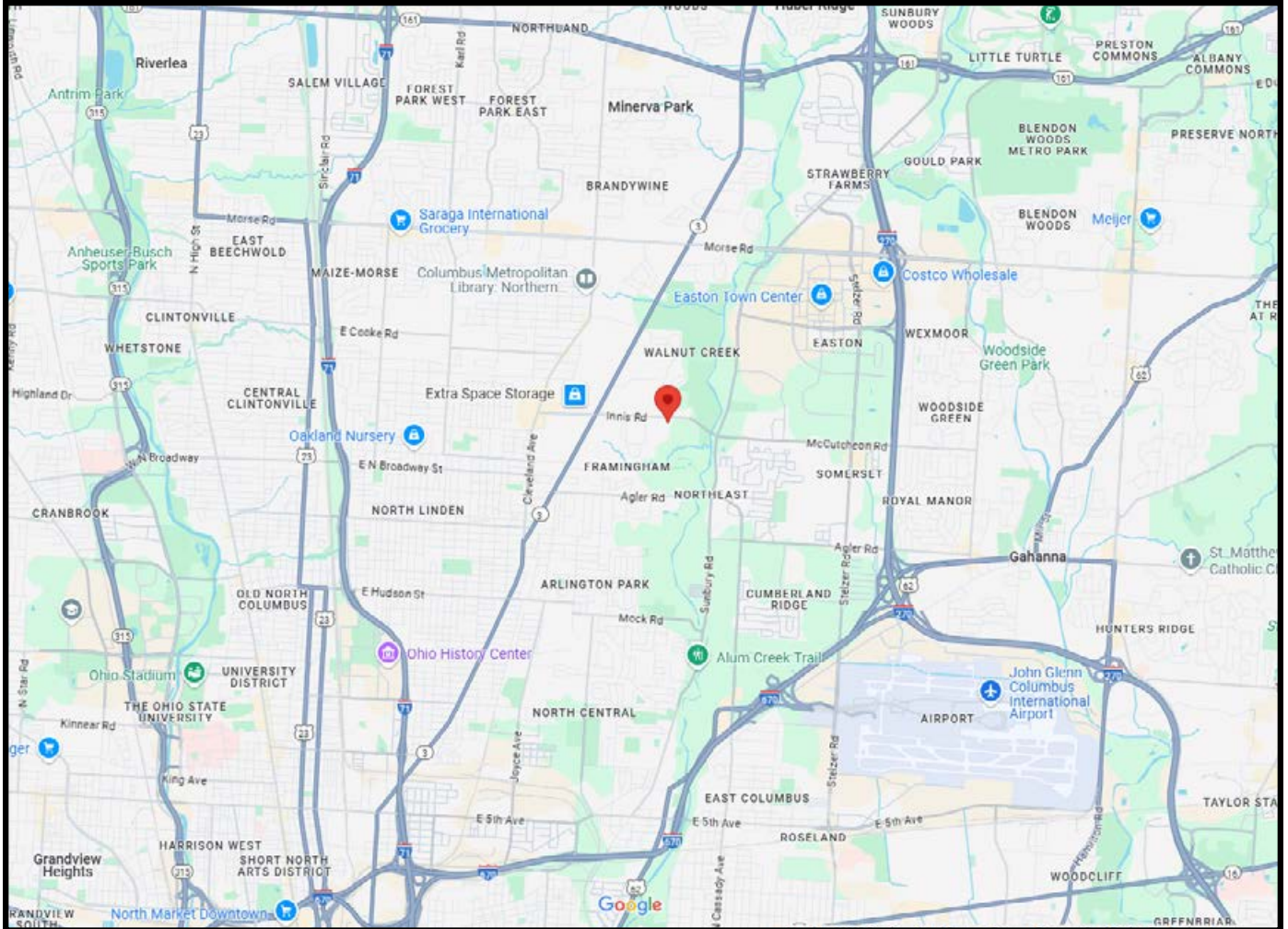

Roya Ghodsi
(614) 470-7138 • roya_ghodsi@hotmail.com
RE/MAX Town Center Commercial
4215 Worth Avenue, Suite 230 • Columbus, Ohio 43219

Area Highlights

Zip code 43224 is located in Columbus, Ohio, and covers an area of 15.958 square miles.

It's situated in Franklin County and has a population of 30,457, according to the 2020 U.S. Census. The area is home to John Glenn Columbus International Airport and Easton Town Center. The GreatData.com lists the population as 30,457, with a population density of 2,820 people per square mile. The median home value is \$173,600, and the median household income is at \$65,327, as well as the need for additional 88,000 housing units.

Columbus is attracting investors and homebuyers looking for affordability and growth potential. The city's tech scene has grown by 22% in recent years, with companies like JPMorgan Chase, Accenture, and startups like AndHelth and Tandem and other tech companies, creating amazing opportunities by bringing 3000 jobs to Columbus by the end of 2025.

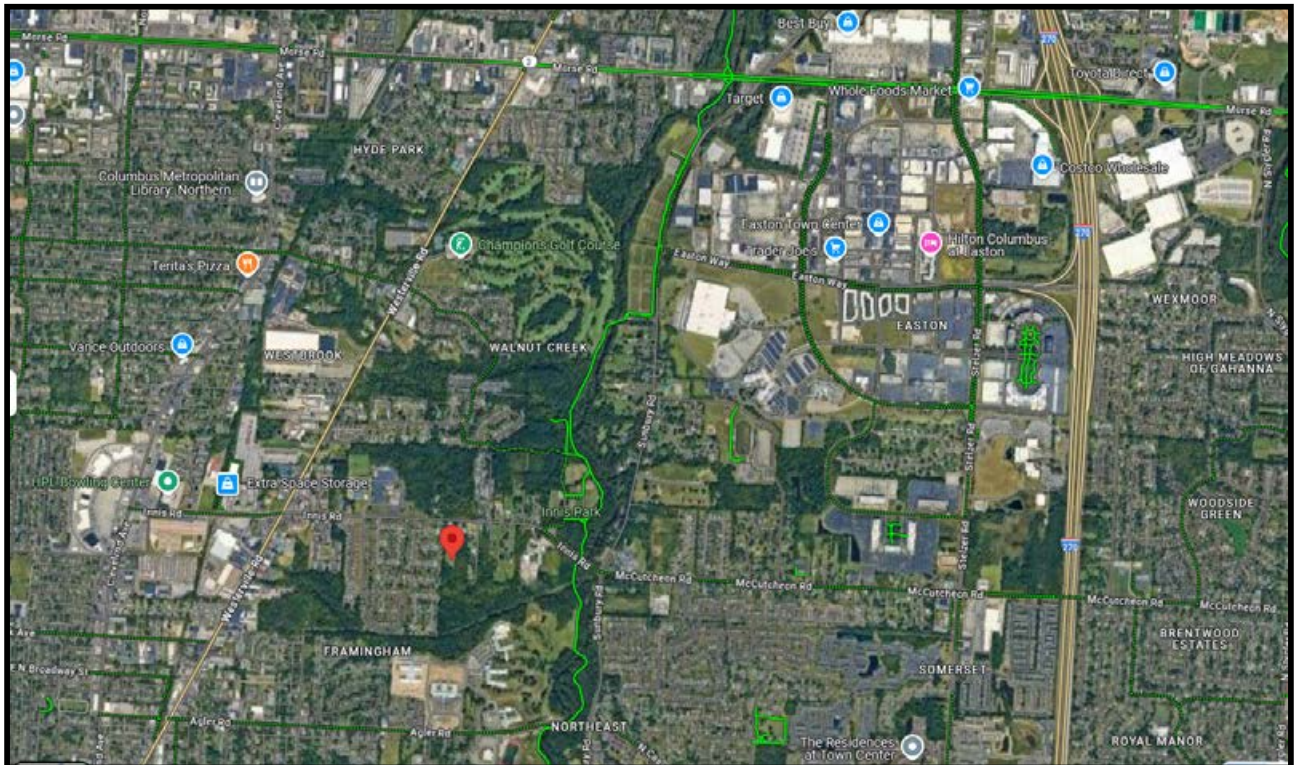

Roya Ghodsi
(614) 470-7138 • roya_ghodsi@hotmail.com
RE/MAX Town Center Commercial
4215 Worth Avenue, Suite 230 • Columbus, Ohio 43219



Roya Ghodsi
(614) 470-7138 • roya_ghodsi@hotmail.com
RE/MAX Town Center Commercial
4215 Worth Avenue, Suite 230 • Columbus, Ohio 43219



Roya Ghodsi
(614) 470-7138 • roya_ghodsi@hotmail.com
RE/MAX Town Center Commercial
4215 Worth Avenue, Suite 230 • Columbus, Ohio 43219