



FOR LEASE
1501 S 19TH ST

166,928 SF
MATTOON, IL



PHOENIX
INVESTORS

Opportunity. Execution. Value Creation.

MICHAEL JENSEN | 414-260-0577 | MJENSEN@PHOENIXINVESTORS.COM

This document has been prepared by Phoenix Investors for advertising and general information only. Phoenix Investors makes no guarantees, representations, or warranties of any kind, expressed or implied, regarding the information including, but not limited to, warranties of content, accuracy, and reliability.



PROPERTY HIGHLIGHTS



**FULLY FENCED WITH
GUARD SHACK**



**CLOSE PROXIMITY
TO I-57**



**RENOVATED IN
2025**



**HEAVY POTENTIAL
POWER (1 - 5 MW)**

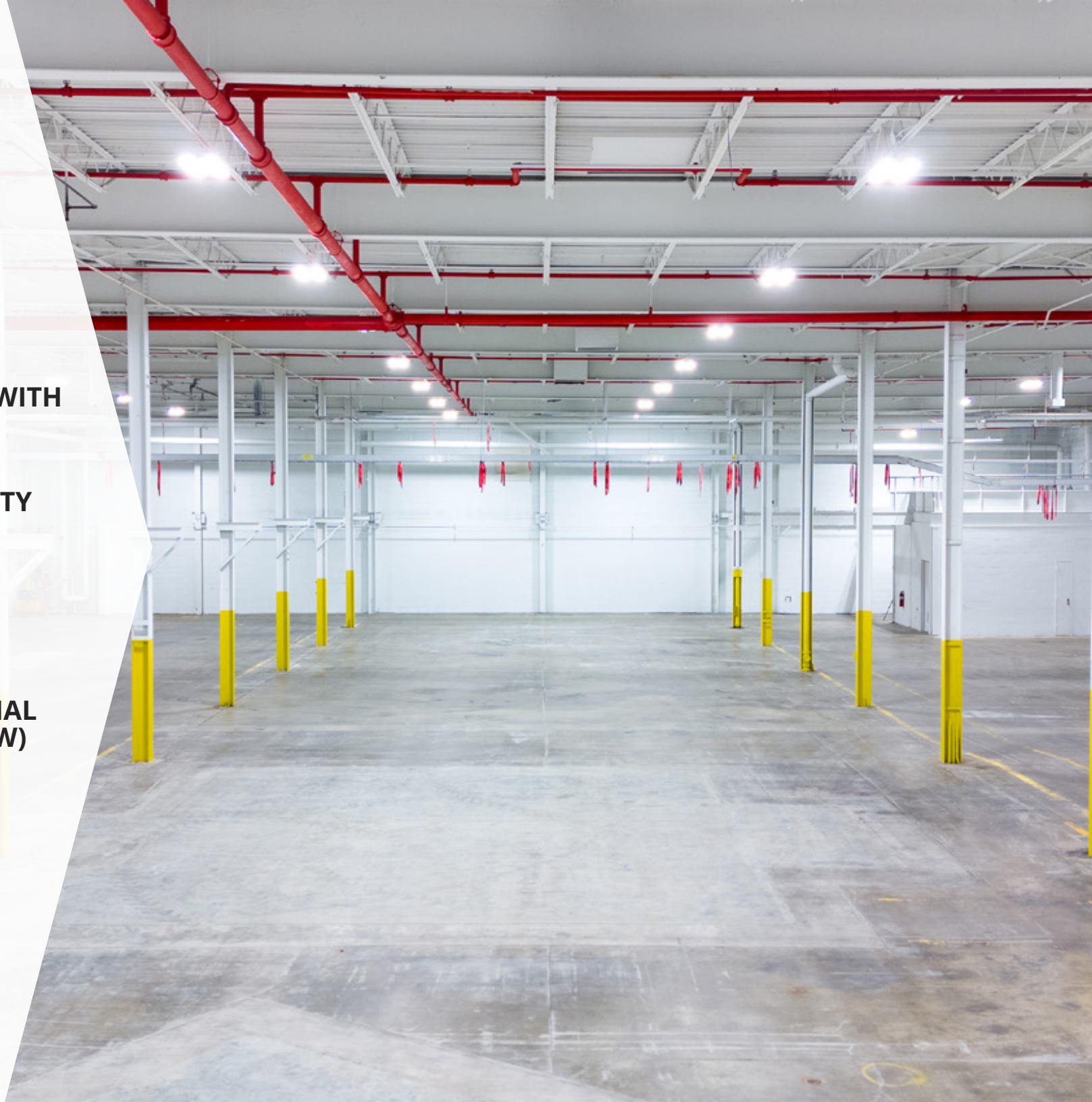

PROPERTY DETAILS

1501 S 19TH ST | MATTOON, IL

AVAILABLE SPACE	166,928 SF
WAREHOUSE SPACE	111,516 SF
OFFICE SPACE/MECHANICAL	55,412 SF
DOCK DOORS	3
DRIVE-IN DOORS	3
CLEAR HEIGHT	15' 2" - 22' 4"
ROOF	TPO (2025)
WALLS	Masonry Brick & Concrete Block
FLOORS	6" Reinforced Concrete
YEAR BUILT	1967 - 1993
YEAR RENOVATED	2025
FIRE SUPPRESSION	Wet
EXISTING POWER	3-Phase
ELECTRICAL PROVIDER	Ameren
POTENTIAL POWER	1 - 5 MW Via Adjacent Ameren Substation
PARKING	285 Parking Spaces
LAND AREA	43.32 Acres
ZONING	I: Industrial District
PARCEL ID	07-1-00846-001 07-1-00846-002
RAIL	Possible via old spur (Adjacent to CN Rail Network)
OPEX ESTIMATE	\$0.65 - \$0.75/SF

[VIEW A VIDEO OF THIS PROPERTY](#)



FLOOR PLAN

1501 S 19TH ST | MATTOON, IL

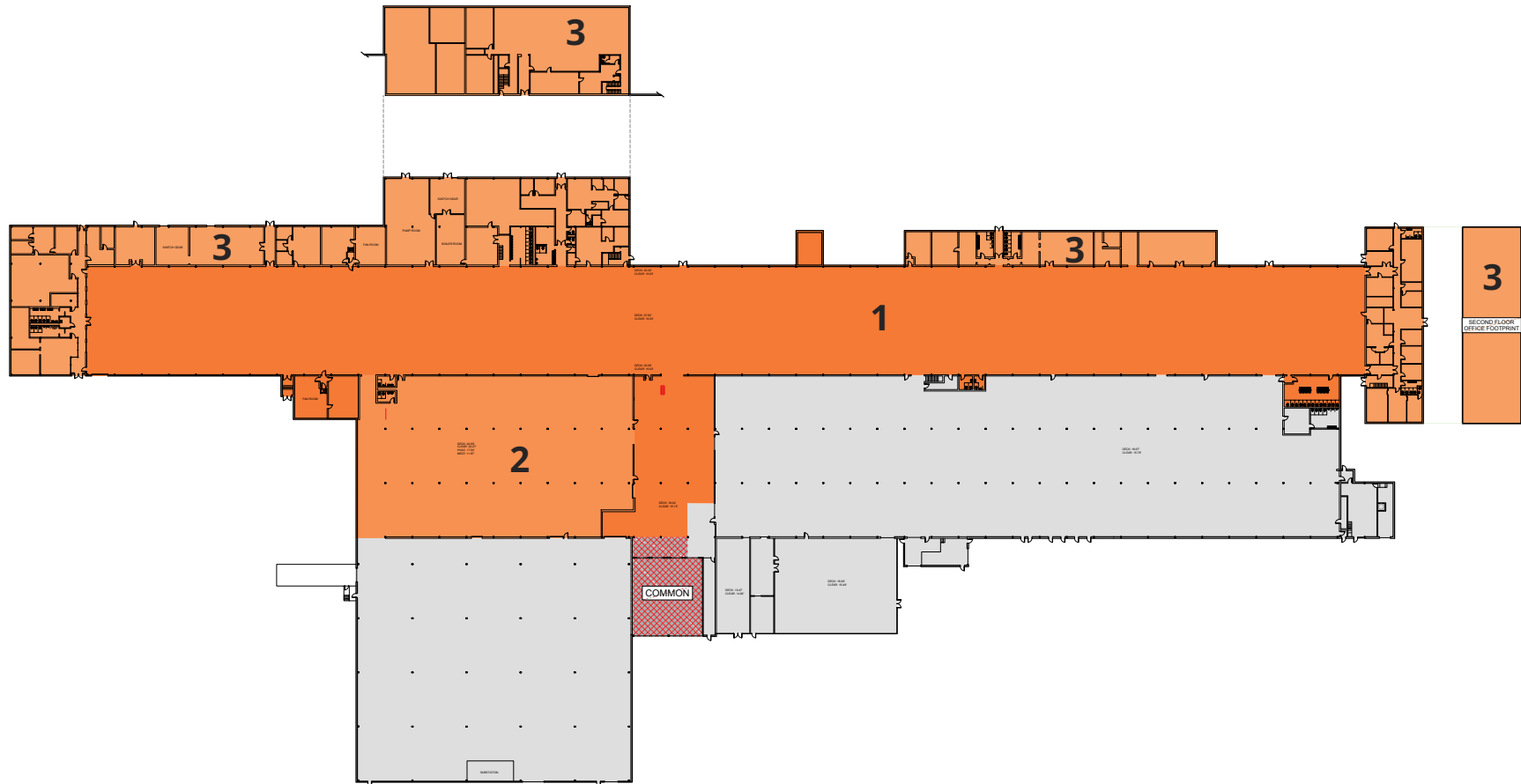

NUMBER	SPACE DESIGNATION	CLEAR HEIGHT	SQUARE FEET
1	WAREHOUSE	15' 2" - 16'	87,445 SF
2	WAREHOUSE	22' 4"	24,071 SF
3	OFFICE/MECHANICAL	DROP CEILING	55,412 SF
TOTAL			166,928 SF

[VIEW A MATTERPORT WALK-THROUGH](#)

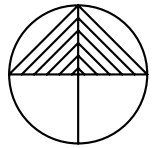

SITE PLAN

1501 S 19TH ST | MATTOON, IL

AMEREN
SUBSTATION

2

Excess Land (~20 Acres)

NUMBER	SPACE DESIGNATION	SQUARE FEET
1	WAREHOUSE	275,566 SF
2	LAND AREA	43.32 ACRES



LOCATION MAP

1501 S 19TH ST | MATTOON, IL

I-57	5 MILES
SPRINGFIELD	85 MILES
INDIANAPOLIS	133 MILES
ST. LOUIS	128 MILES
CHICAGO	186 MILES

