

For Lease

2,089 SF | Negotiable Lease Rate

Free-Standing Office Space East Wichita



Former Fidelity Bank

1306 N Woodlawn St Wichita, Kansas 67208

Property Highlights

- Former Fidelity Bank Branch
- 2,089 SF Building, 22,645 SF Lot
- 29 Parking Spaces
- Monument & Building Signage
- Year Built: 2001
- Quality Interior Finishes
- 3 Manager Offices
- Zoned: LC
- 2024 RE Taxes: \$14,070
- Lease Rate: Negotiable NN

Offering Summary

Lease Rate:	Negotiable NN
Building Size:	2,089 SF
Lot Size:	22,642 SF

For More Information

Troy Farha

O: 316 847 4904

tfarha@naimartens.com

| Former Fidelity Bank Branch 1306 N Woodlawn St Wichita, KS 67208

For Lease

2,089 SF | Negotiable Lease Rate

Free-Standing Office Space East Wichita



Former Fidelity Bank Branch 1306 N Woodlawn St Wichita, KS 67208

For Lease

2,089 SF | Negotiable Lease Rate

Free-Standing Office Space East Wichita

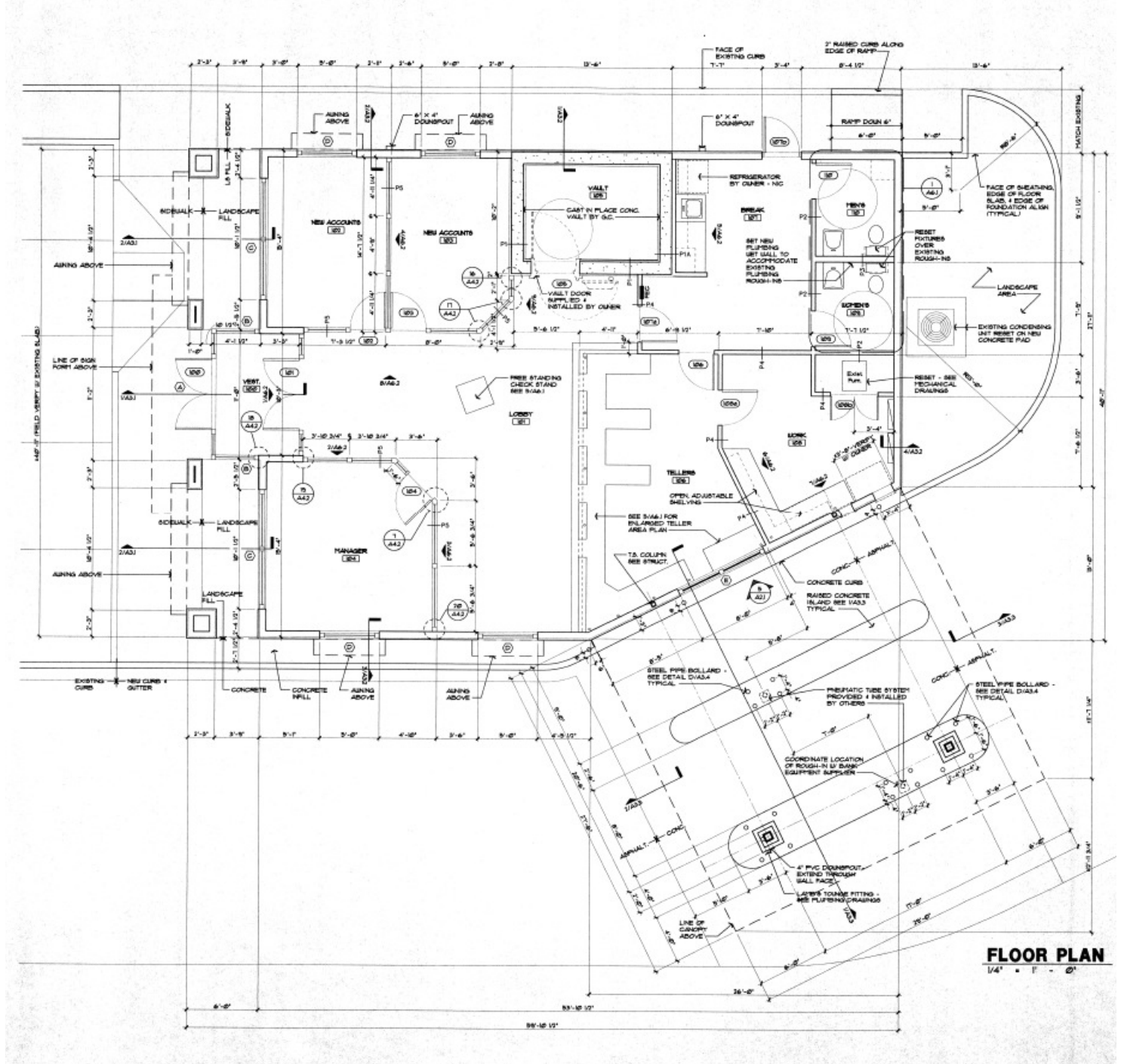

Former Fidelity Bank Branch 1306 N Woodlawn St Wichita, KS 67208



For Lease

2,089 SF | Negotiable Lease Rate

Free-Standing Office Space East Wichita



| Former Fidelity Bank Branch 1306 N Woodlawn St Wichita, KS 67208