



**Land & Development in CB10**

Radwinter Road, Swards End, Saffron Walden, Essex, CB10 2LR

**£135,000** Starting Bid

Tenure

**Freehold**

**Property features**

- ✓ Freehold Land
- ✓ Full Planning Permission: UTT/25/1803/FUL
- ✓ Plans For A 4 Bedroom Self-Build Detached Home

## Arrange a viewing

Lisa Neil  
Branch Manager  
Commercial National

---

0191 737 1154  
commercial@pattinson.co.uk

---

- ✓ Flexible viewing slots
- ✓ Accompanied viewings

## Description

FOR SALE BY AUCTION: terms and conditions apply.

Pattinsons are please to offer for sale via online auction this parcel of land. The plot measures approximately with an area of 995.61m<sup>2</sup> and a perimeter of roughly 184.2m.

The freehold plot comes with full planning permission for a self build four bedroom, detached home. For more details on the plans please get in touch.

Sewards End is an attractive village just to the east of the market town of Saffron Walden which has a good range of facilities including a wide selection of restaurants, coffee bars and boutiques. The town is also well served with private and state schooling; the popular Saffron Walden County High School and Dame Bradbury's which is part of the Stephen Perse Foundation are within 2 – 3 miles.

Please note we have not inspected this site.

Price: Starting Bid £135,000

Property Type: Land & Development

Business Type: Other/Unspecified

Parking: None

## Description

Pattinsons are please to offer for sale via online auction this parcel of land. The plot measures approximately with an area of 995.61m<sup>2</sup> and a perimeter of roughly 184.2m. This parcel of land comes with full planning for a self - build four bedroom home.

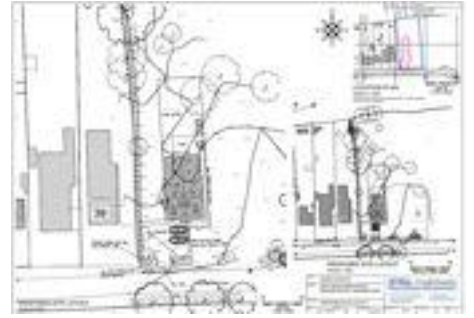

## Location

Sewards End is an attractive village just to the east of the market town of Saffron Walden which has a good range of facilities including a wide selection of restaurants, coffee bars and boutiques. The town is also well served with private and state schooling; the popular Saffron Walden County High School and Dame Bradbury's which is part of the Stephen Perse Foundation are within 2 - 3 miles.

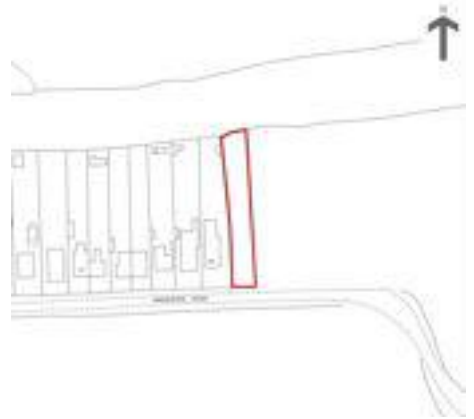

## Tenure

Title number: EX742656 - Freehold



## Additional Information

For further information please contact our office direct on 0191 737 1154, or alternatively via e-mail on [commercial@pattinson.co.uk](mailto:commercial@pattinson.co.uk). With regards to viewing the subject property, this is to be done strictly by appointment through Keith Pattinson Commercial department. Please contact us to arrange an internal inspection, or to register your interest.



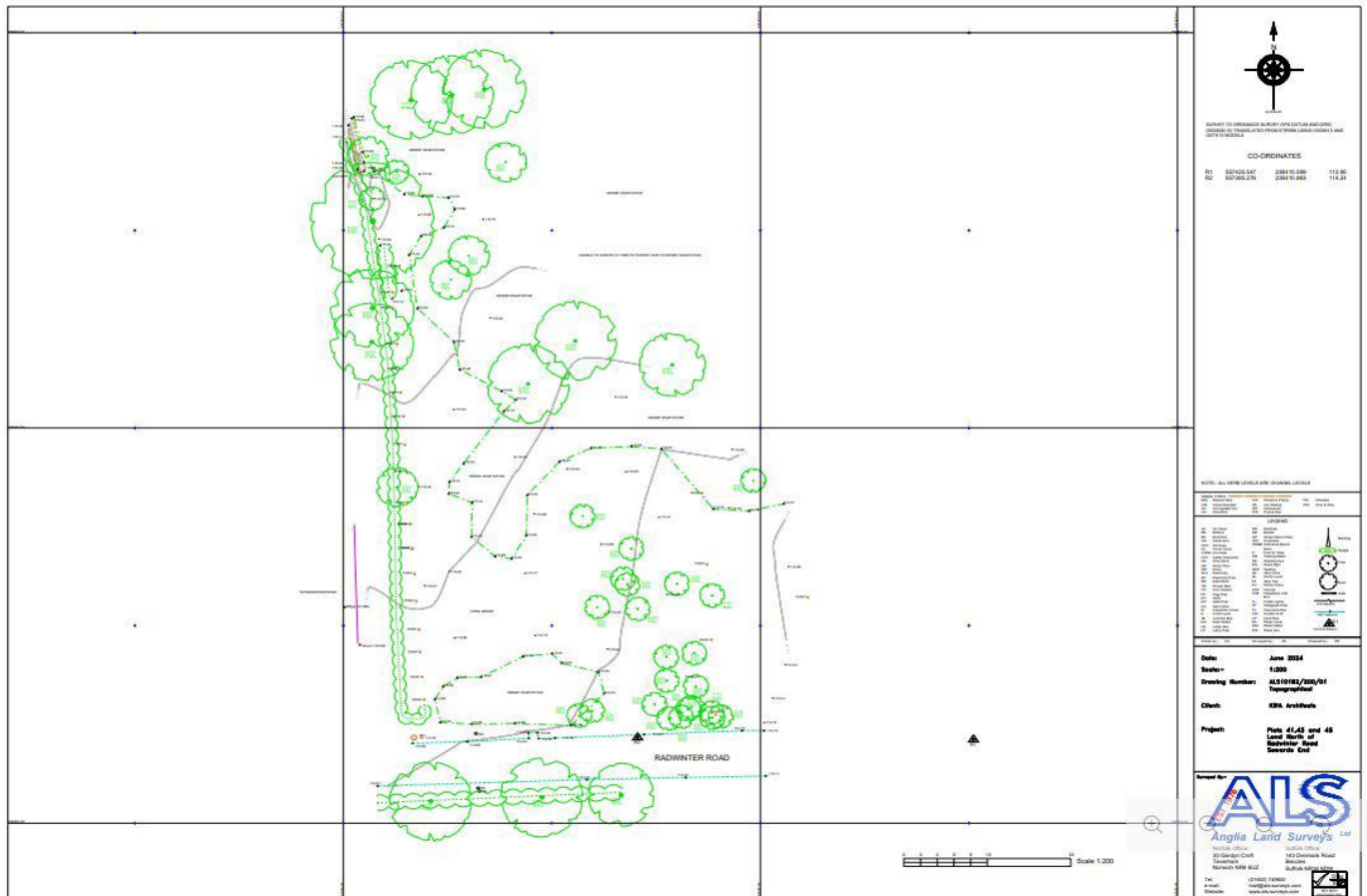

Radwinter Road, Swards End, Saffron Walden, Essex, CB10 2LR

Contact your local branch today for more information on this property:

**Keith Pattinson Silverlink, Wallsend, Tyne and Wear, NE28 9NY, Tel: 0191 737 1154 ,  
commercial@pattinson.co.uk, www.pattinson.co.uk**

These particulars, whilst believed to be accurate are set out as a general outline only for guidance and do not constitute any part of an offer or contract. Intending purchasers should not rely on them as statements of representation of fact, but must satisfy themselves by inspection or otherwise as to their accuracy. No person in this firms employment has the authority to make or give any representation or warranty in respect of the property.

