

5411 N. Mesa FOR LEASE

+/- 2,434 TO 12,245 SQUARE FEET AVAILABLE



PROPERTY DETAILS

- Landmark property fronts bustling Mesa St. thoroughfare providing prominent visibility to over 38,000 vehicles daily.
*Source: 2023 Kalibrate Technologies (Q4 2023).
- +/- 85,132 SF retail center on approx. 4.33 acres.
- Santa Fe architecture with wraparound courtyards.
- Ample parking.

SPACES AVAILABLE:

Upper Level - Suite 13B – +/-1,500 SF

Upper Level - Suite 19CD – +/-2,434 SF

Lower Level - Suite 31ABC – +/-3,008 SF

*NNN Plus Shared Water, dependent upon usage and SF

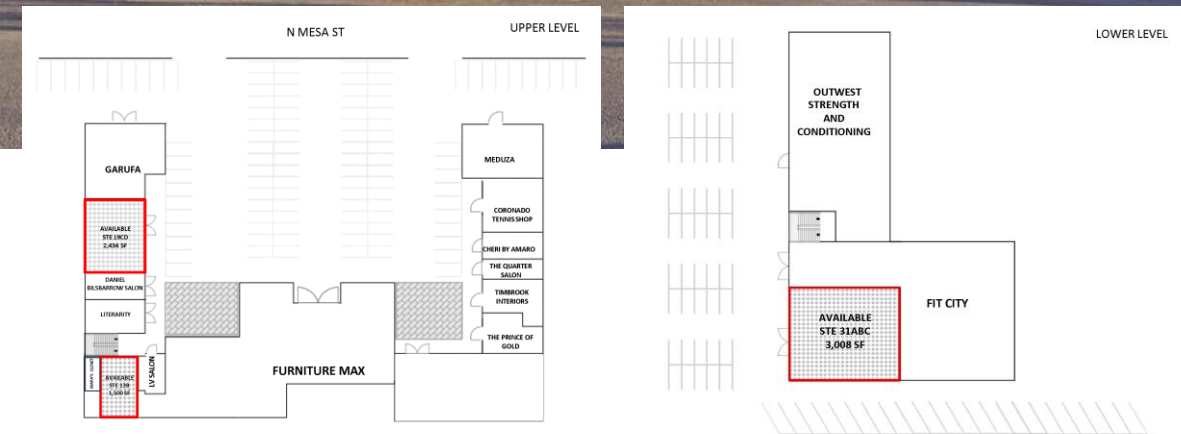

915-225-0903 | Natalia@PrimeCapital-EP.com
915-225-0906 | Michelle@PrimeCapital-EP.com



Prime Resource Team is an affiliate of Prime Management, Inc. as Broker licensed by the Texas Real Estate Commission and New Mexico Real Estate Commission. The information contained herein has been obtained from sources deemed reliable and is subject to errors, omissions, changes in terms and conditions, prior sale, lease, or financing or withdrawal without notice.

Prime Capital
MANAGEMENT

N MESA ST

UPPER LEVEL

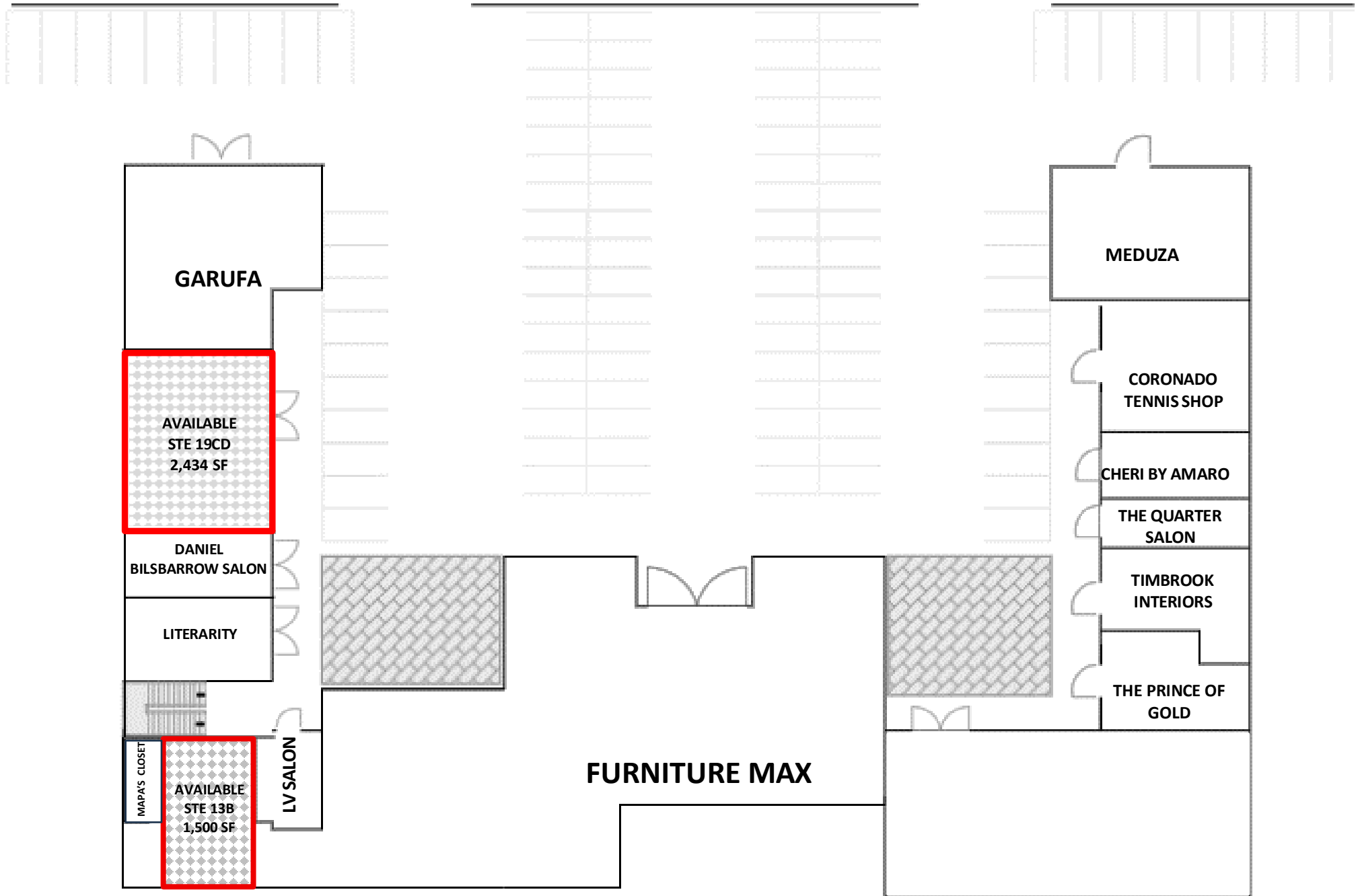

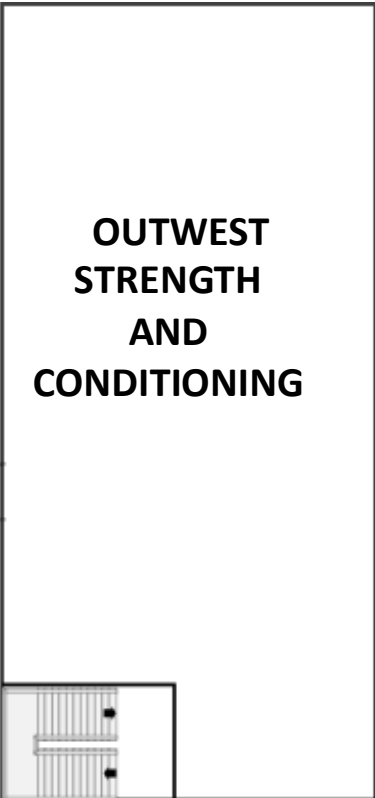
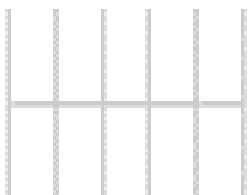
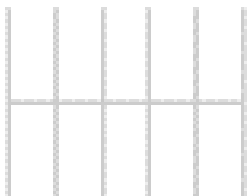
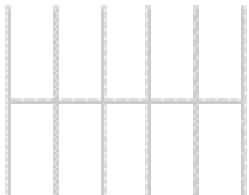
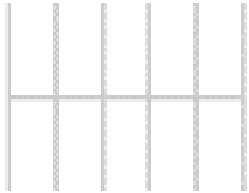
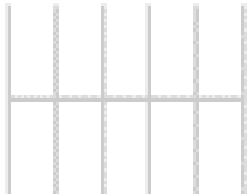

**OUTWEST
STRENGTH
AND
CONDITIONING**

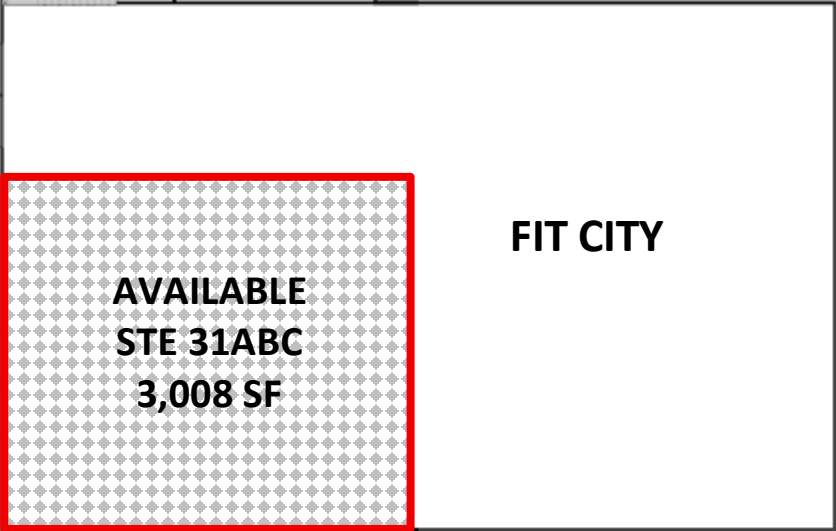

FIT CITY

**AVAILABLE
STE 31ABC
3,008 SF**



