

# CENTRAL PARK NORTH 404 W. POWELL LANE

## SUITE C205 FLOOR PLAN

Asking Rent: \$1.15 / SF

Drawing for:  
L.H. LAYNE COMPANY  
404 W. Powell, Ste. 202  
Austin, Texas 78753  
PH: 252-9900 Fax: 252-9902

SUITE 205  
CENTRAL PARK NORTH  
404 W. POWELL LN.  
RENTABLE AREA: 3,167 S.F.

THE REVISIONS AND  
TYPICAL PLANS ARE FOR  
CONSTRUCTION ONLY  
AND SHOULD NOT BE  
USED FOR ANY OTHER  
PROJECT.  
Project No.: 2020602  
Rev. Date: June 13, 2007  
©2007

DIMENSIONS  
FLOOR PLANS  
7301 Moten Rd.  
Austin, Texas 78731  
PH: 342-0114 Fax: 342-1865

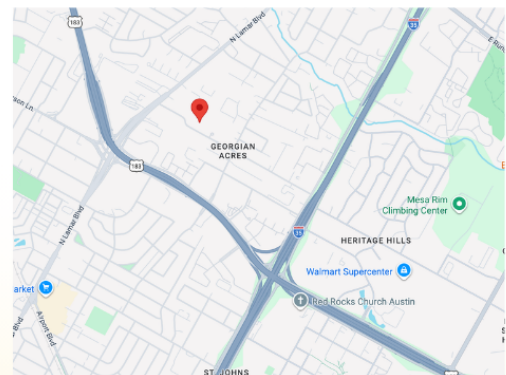
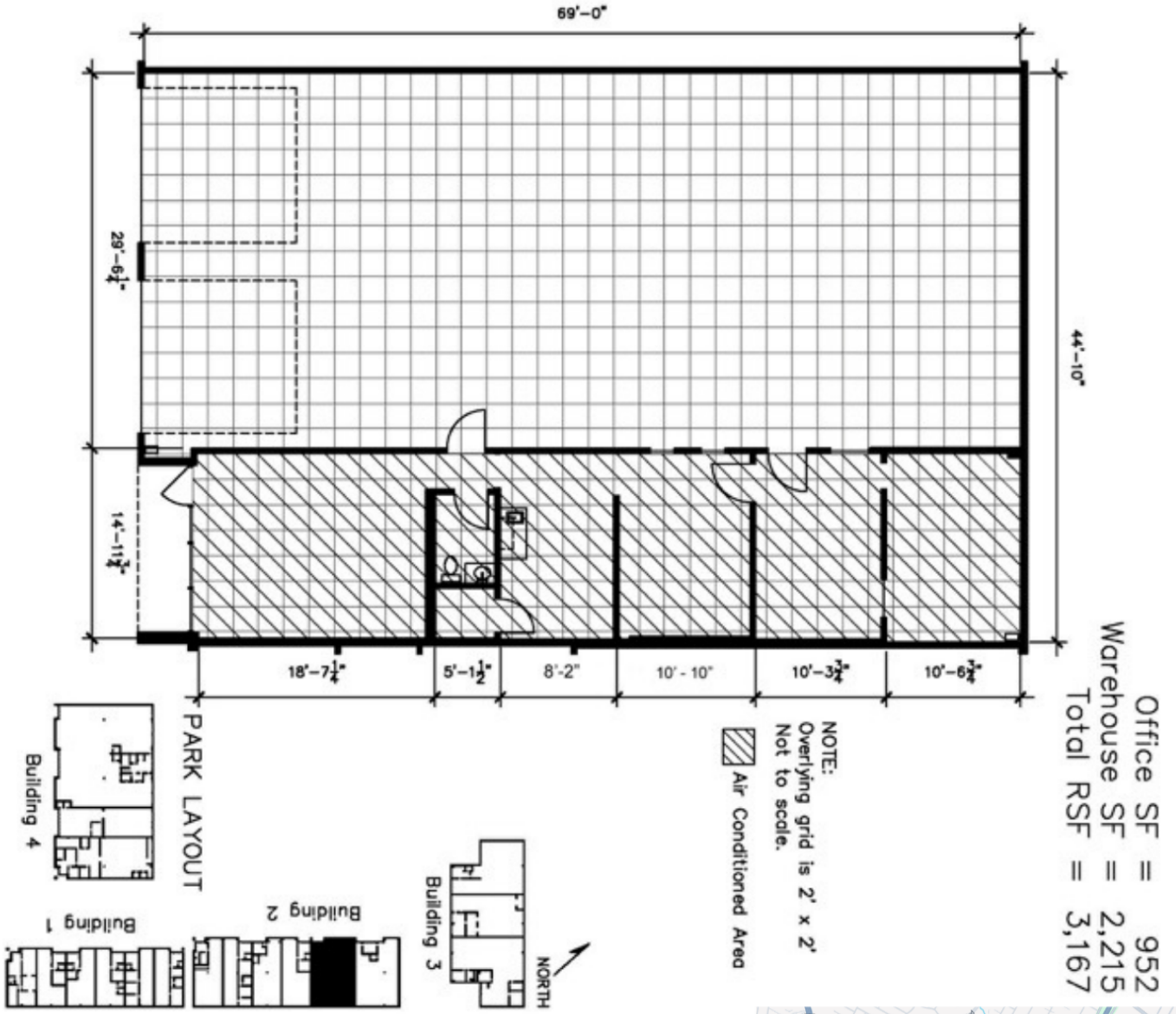

### Contact Information:

(512) 252-9900

404 W Powell Lane, Suite 202, Austin, TX 78753

laynecompany.com