

The image shows the exterior of a commercial building. The main sign on the brick corner reads "STRONG STYLE MARTIAL ARTS" in large letters, with "YOUTH DEVELOPMENT CENTER" in smaller letters below it. To the right, there are signs for "Space For Lease", "NAILS By MICHELLE", and "SPA PEDICURE FACIAL OPEN". A dark blue car is parked in the foreground. A semi-transparent blue rectangular box is overlaid on the center of the image, containing the text "NOTTINGHAM PROFESSIONAL CENTER" in white, bold, sans-serif font.

# NOTTINGHAM PROFESSIONAL CENTER

20701 Kingsland Boulevard, Katy, TX 77450

# PROPERTY DETAILS



## Parking Spaces

90 parking spaces



## Total LandArea

1.262 Acres



## Building Size

19,934 SF

# PROPERTY OVERVIEW

Convenience-based strip center with e-commerce resistant roster.

Located directly across James H. Taylor Highschool along Kingsland Boulevard & Dominion Drive.

Heavy Daytime Traffic with 16,476 Cars Per Day on Kingsland Blvd (Costar 2020).

Located on Wilcrest Drive at the Entrance to the Upscale Westsider Tennis Club.

Positioned in an area with rapid growth & high household incomes.

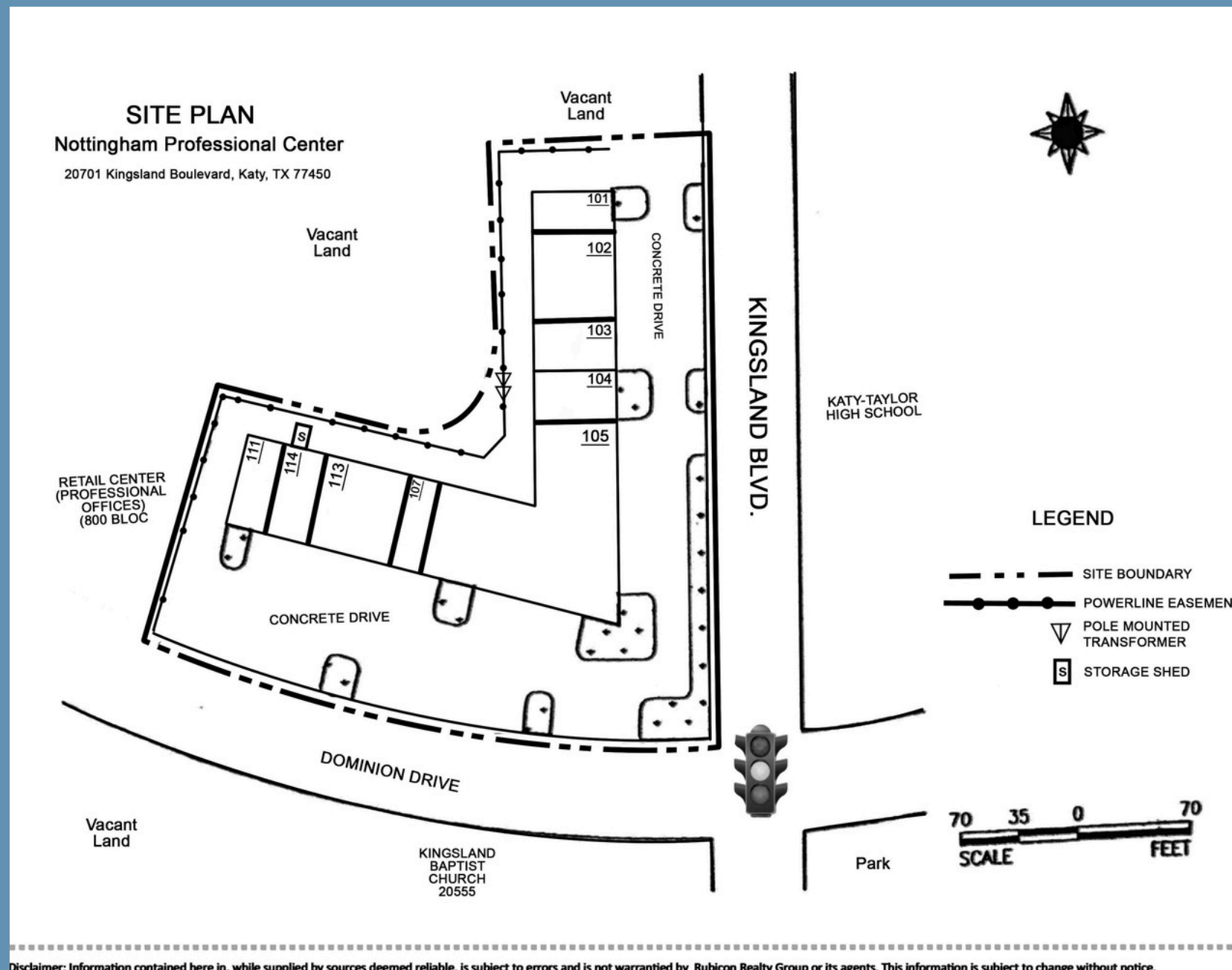

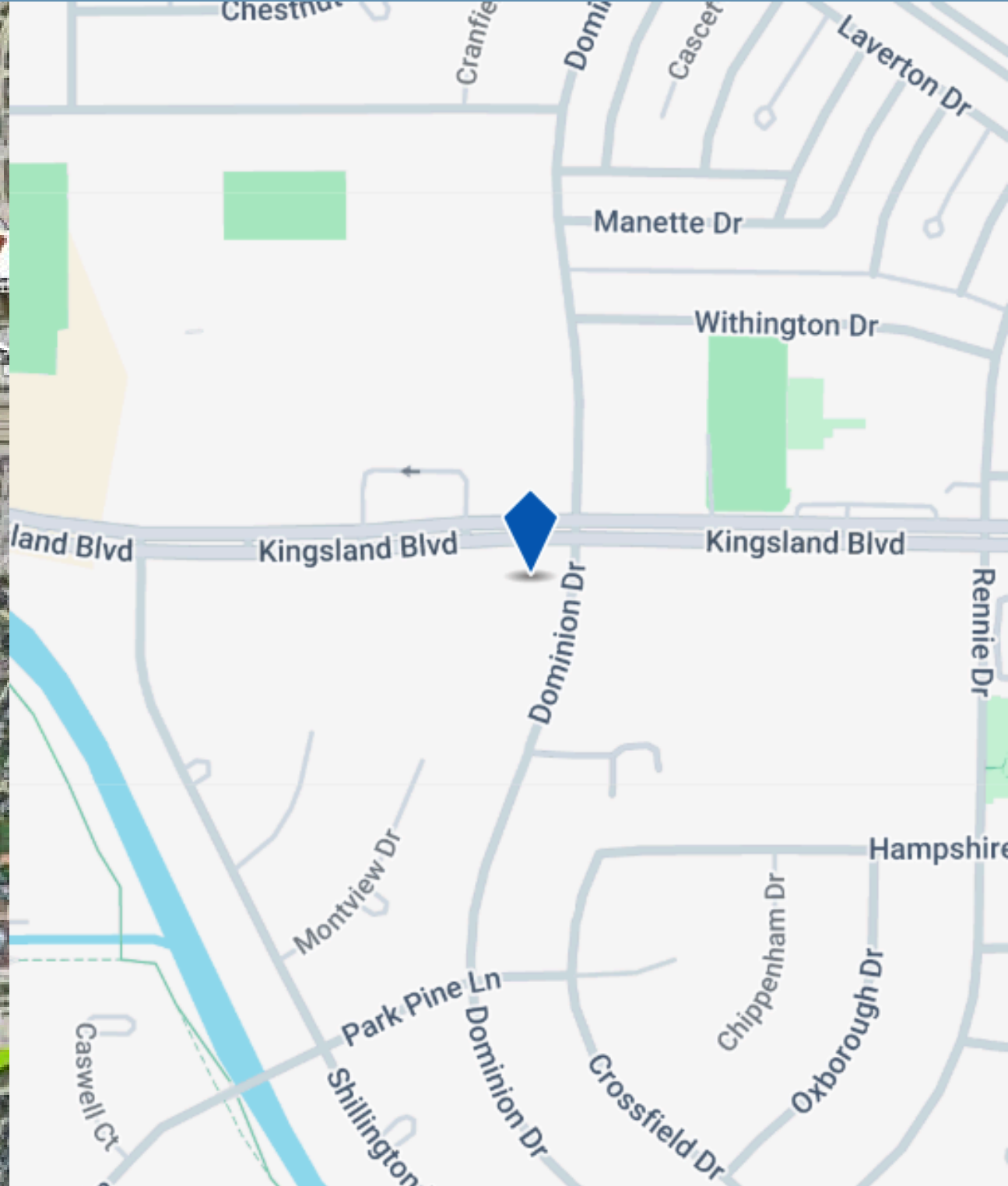

dashfordllc@gmail.com

832 679 4520