

FOR SUBLEASE

# 22441 72ND AVE S

Kent, WA 98032



## 17,536 SF INDUSTRIAL SPACE AVAILABLE

### FEATURES

SIZE	17,536 SF
DATE AVAILABLE	June 1, 2026
SUBLEASE EXPIRATION	January 31, 2027
FLEXIBLE TERM	Month-to-Month Storage Opportunity
CLEAR HEIGHT	24'
LOCATION	Accessible to I-5, I-405, & W Valley Hwy
SUBLEASE RATE	Call Broker for Rates

### CONTACT

**CONNOR CREE**  
Executive Director  
+1 206 521 0289  
connor.cree@cushwake.com

**ANDREW SHULTZ**  
Senior Director  
+1 206 215 1645  
andrew.shultz@cushwake.com

**CUSHMAN & WAKEFIELD**  
601 Union Street, Suite 1100  
Seattle, WA 98101  
cushmanwakefield.com

©2026 Cushman & Wakefield. All rights reserved. The information contained in this communication is strictly confidential. This information has been obtained from sources believed to be reliable but has not been verified. NO WARRANTY OR REPRESENTATION, EXPRESS OR IMPLIED, IS MADE AS TO THE CONDITION OF THE PROPERTY (OR PROPERTIES) REFERENCED HEREIN OR AS TO THE ACCURACY OR COMPLETENESS OF THE INFORMATION CONTAINED HEREIN. AND SAME IS SUBMITTED SUBJECT TO ERRORS, OMISSIONS, CHANGE OF PRICE, RENTAL OR OTHER CONDITIONS, WITHDRAWAL WITHOUT NOTICE, AND TO ANY SPECIAL LISTING CONDITIONS IMPOSED BY THE PROPERTY OWNER(S). ANY PROJECTIONS, OPINIONS OR ESTIMATES ARE SUBJECT TO UNCERTAINTY AND DO NOT SIGNIFY CURRENT OR FUTURE PROPERTY PERFORMANCE.

**FOR SUBLEASE**

# 22441 72ND AVE S

Kent, WA 98032



## LOCATION

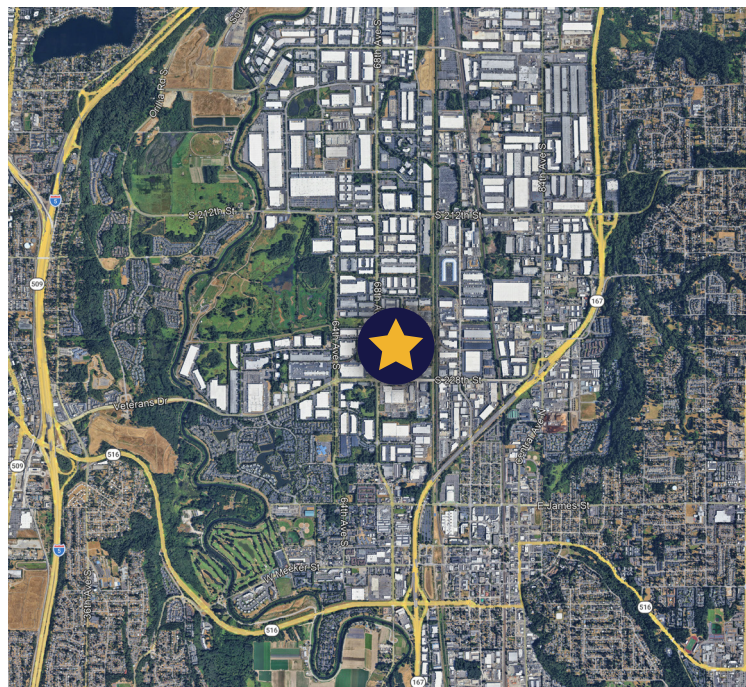
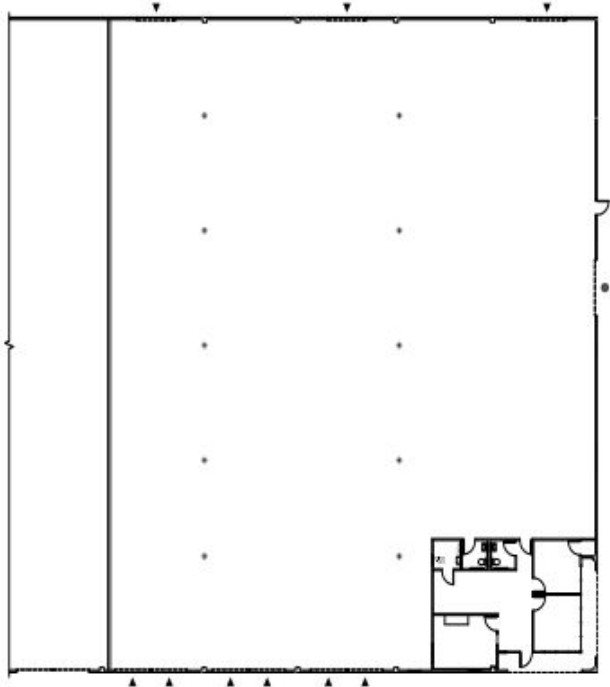
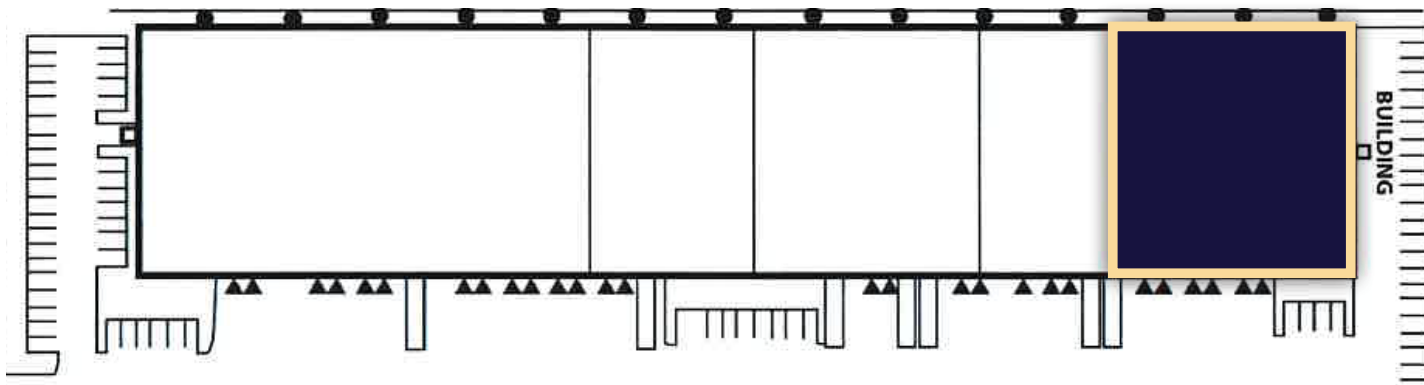

### CONTACT

**CONNOR CREE**  
Executive Director  
+1 206 521 0289  
connor.cree@cushwake.com

**ANDREW SHULTZ**  
Senior Director  
+1 206 215 1645  
andrew.shultz@cushwake.com

**CUSHMAN & WAKEFIELD**  
601 Union Street, Suite 1100  
Seattle, WA 98101  
cushmanwakefield.com

©2026 Cushman & Wakefield. All rights reserved. The information contained in this communication is strictly confidential. This information has been obtained from sources believed to be reliable but has not been verified. NO WARRANTY OR REPRESENTATION, EXPRESS OR IMPLIED, IS MADE AS TO THE CONDITION OF THE PROPERTY (OR PROPERTIES) REFERENCED HEREIN OR AS TO THE ACCURACY OR COMPLETENESS OF THE INFORMATION CONTAINED HEREIN, AND SAME IS SUBMITTED SUBJECT TO ERRORS, OMISSIONS, CHANGE OF PRICE, RENTAL OR OTHER CONDITIONS, WITHDRAWAL WITHOUT NOTICE, AND TO ANY SPECIAL LISTING CONDITIONS IMPOSED BY THE PROPERTY OWNER(S). ANY PROJECTIONS, OPINIONS OR ESTIMATES ARE SUBJECT TO UNCERTAINTY AND DO NOT SIGNIFY CURRENT OR FUTURE PROPERTY PERFORMANCE.