

Groupe Dumont

Version	Created: 05/21/2024
FP6A	Measured: 05/17/2024

100 Strowger Boulevard
Brockville, Ontario, Canada

Floor 1

WASHROOM SERVICES TABLE	
WASHROOM NUMBER	UNITS WITH ACCESS
W1	117
W2	124
W3	115/125/125A
W3A	100
W4	108
W5	106
W6	116
W7	201/201A/201B/202 204/204A/207
W8	107A/118
W9	110-111
W10	110-111
W11	114
W12	102/103
W13	101/102/103/105/105B/112/112A
W14	105
W15	112/112A/119/121/127
W16	117

DOCK ALLOCATION	
DOCK/RAMP	OCCUPANTS WITH ACCESS
N1 (DOCK 2)	112A/114/119/121/127
N1 (RAMP)	112A/114/119/121/127
S2	115/125

CORRIDOR NUMBERS AND ALLOCATION	
CORRIDOR NUMBER	OCCUPANTS WITH ACCESS
1	112A/114/117/119/121/124A/127
2	112A/114/117/119/121/124A/127
3	115/121/124A
4	114/115/124/125/125A
5	115/124/125/125A
6	101/102/103/105/105B/112/112A
7	101/102/103/105/112
8	102/103/110-111/114/121
9	107A/107B/110-111/114/121/124A
10	106/107A/107B/110-111/118
11	116/201/201A/201B/202 204/204A/207
12	112/112A/119/121/127

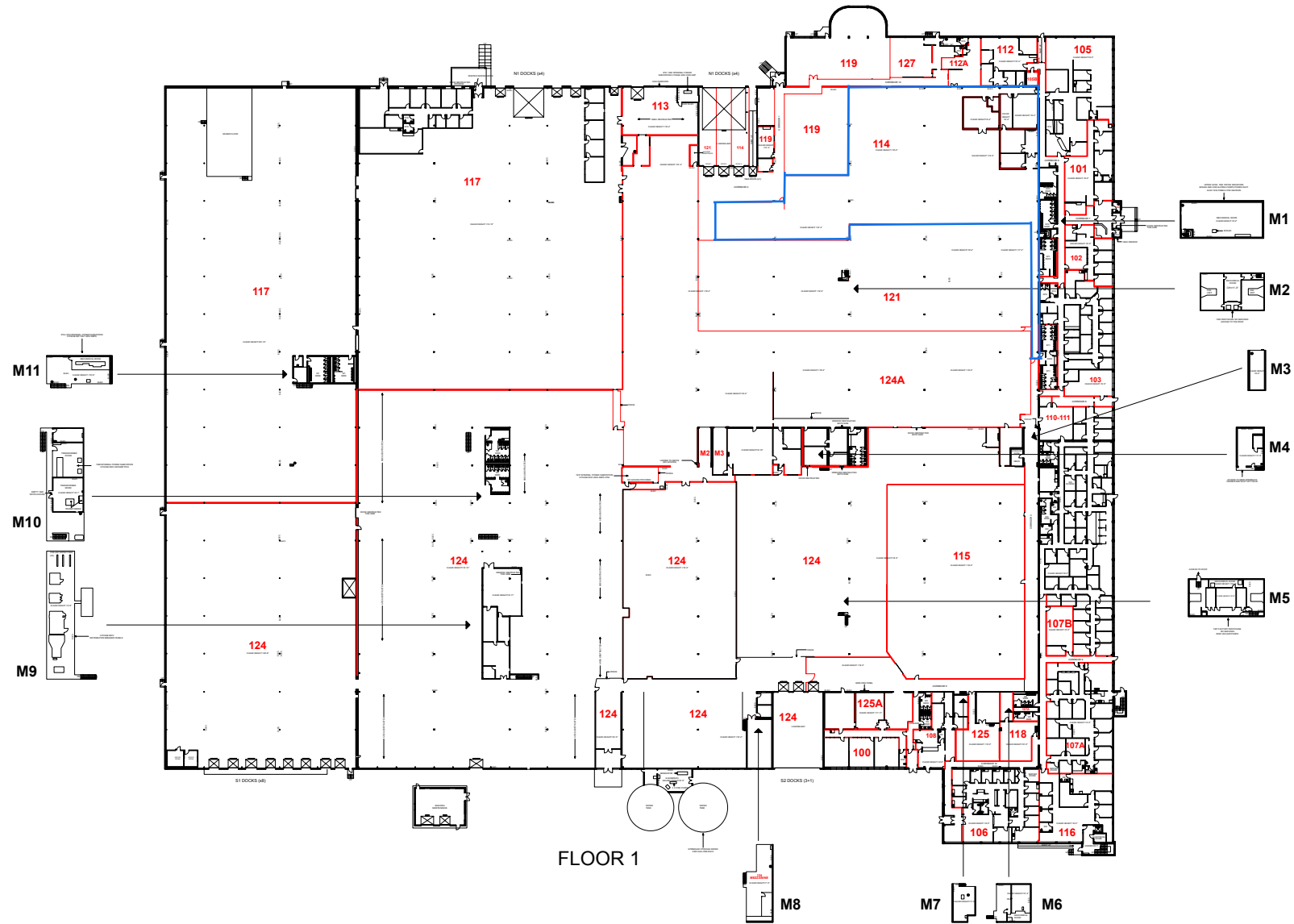

FLOOR 1

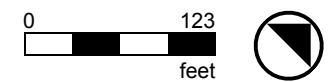

This work product has been prepared by Extreme Measures Inc. pursuant to a contract with the Client for the sole benefit of and use by the Client. No third party may rely on this work product without the receipt of a reliance letter from Extreme Measures Inc.

This work product or portions thereof relies upon information provided by the Client and/or from third parties introduced by the Client that has not been independently verified by Extreme Measures Inc. Extreme Measures Inc. is not liable for any errors, omissions or inaccuracies that may result from such information.