

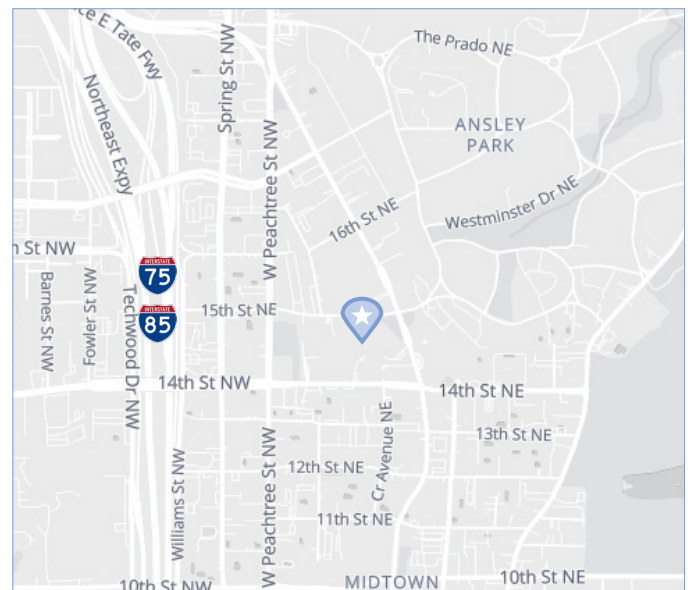

Suite 550 | 4,419 sf | \$29.00 FS

Property highlights

- Class A sublease
- Lease term thru 6/30/2027
- Furniture included
- 9 total private offices; 7 offices and oversized conference overlooking new Midtown Green park
- Building amenities include gym, food options on site, private outdoor park
- Convenient location across from Colony Square and High Museum of Art



For further information:

Ted Schwartz, SIOR, SVP
+1 770 713 2775
ted.schwartz@avisonyoung.com

George Bonvillain, J.D., SVP
+1 770 789 5234
george.bonvillain@avisonyoung.com

Sublease available

1230 Peachtree St, Suite 550, Atlanta, GA 30309

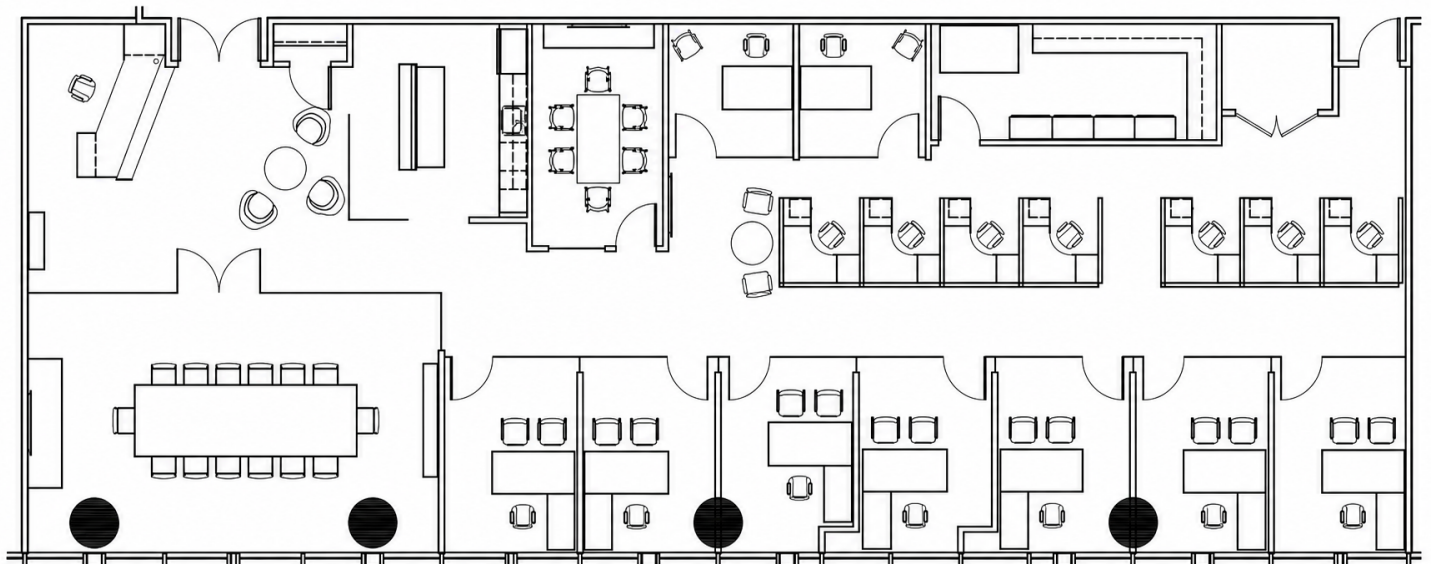

For further information:

Ted Schwartz, SIOR, SVP
+1 770 713 2775
ted.schwartz@avisonyoung.com

George Bonvillain, J.D., SVP
+1 770 789 5234
george.bonvillain@avisonyoung.com

**AVISON
YOUNG**