

FOR LEASE



John Bucher Paulina Salazar
Partner Senior Associate
T 949.468.2246 T 714.244.7310
C 949.463.5672 C 714.244.7310



4980
BARRANCA PKY
IRVINE, CA 92604

4980

BARRANCA PKY

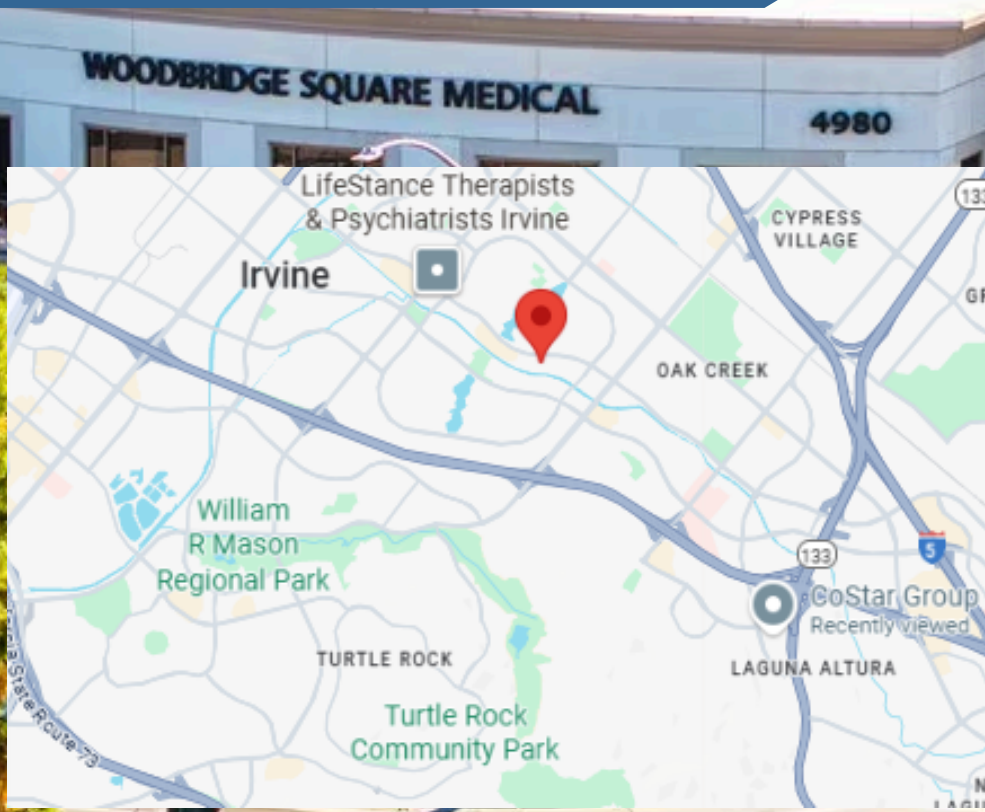

Suite 170 (3,123 SF)

*Divisible

Suite 201 (1,107 SF)

Medical Office

- Premier Class A medical office building
- Ample on-site parking designed for patient comfort and staff convenience
- Highly visible Barranca Parkway location with strong signage opportunities
- Active, hands-on ownership committed to tenant satisfaction and property excellence
- Medical-ready infrastructure with plumbing, accessibility, and flexible layouts

John Bucher
Partner

T 949.468.2246
C 949.463.5672

Paulina Salazar
Senior Associate

T 714.244.7310
C 714.244.7310



4980

BARRANCA PKY

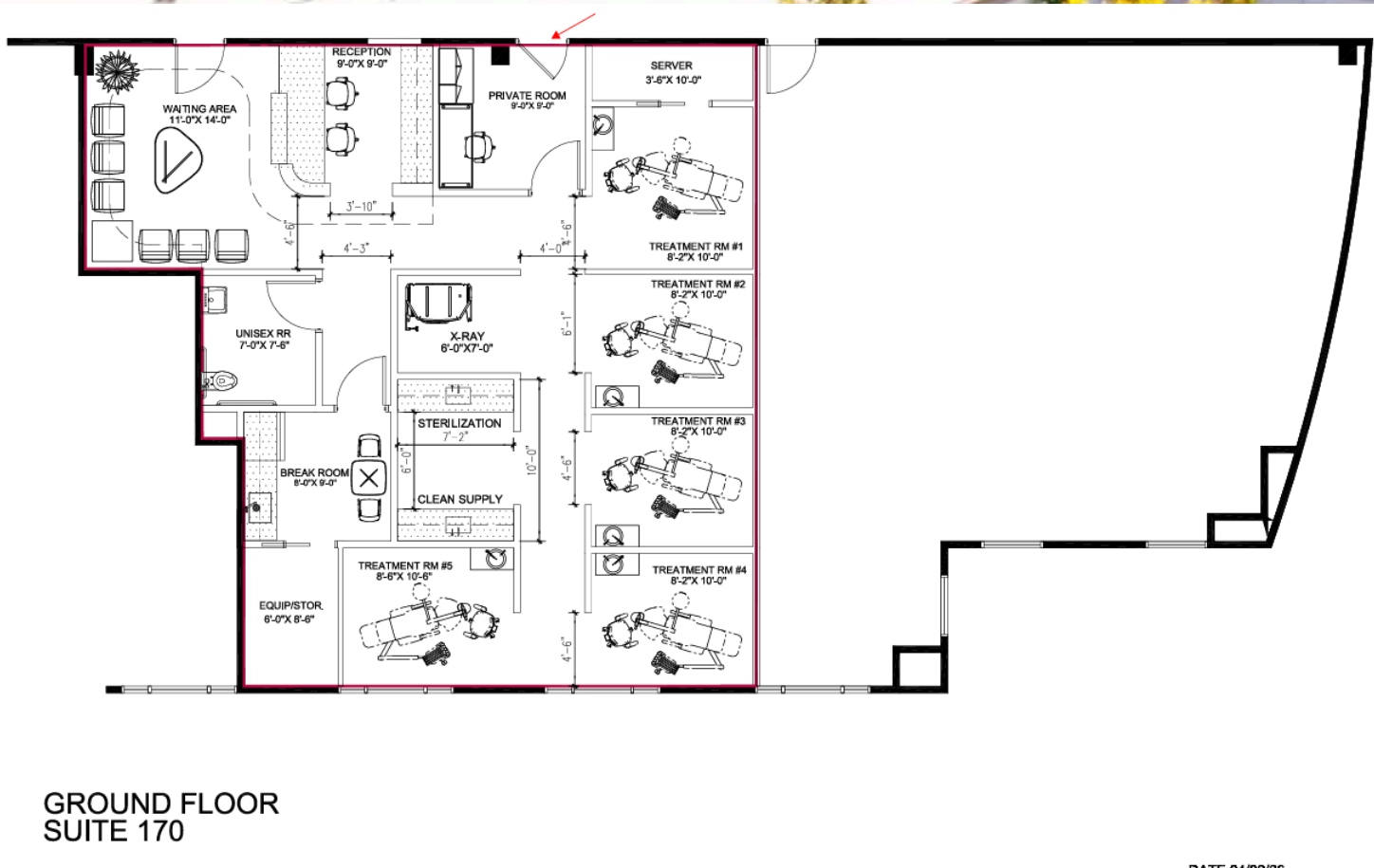

John Bucher
Partner
T 949.468.2246
C 949.463.5672

Paulina Salazar
Senior Associate
T 714.244.7310
C 714.244.7310



4980 BARRANCA PKY

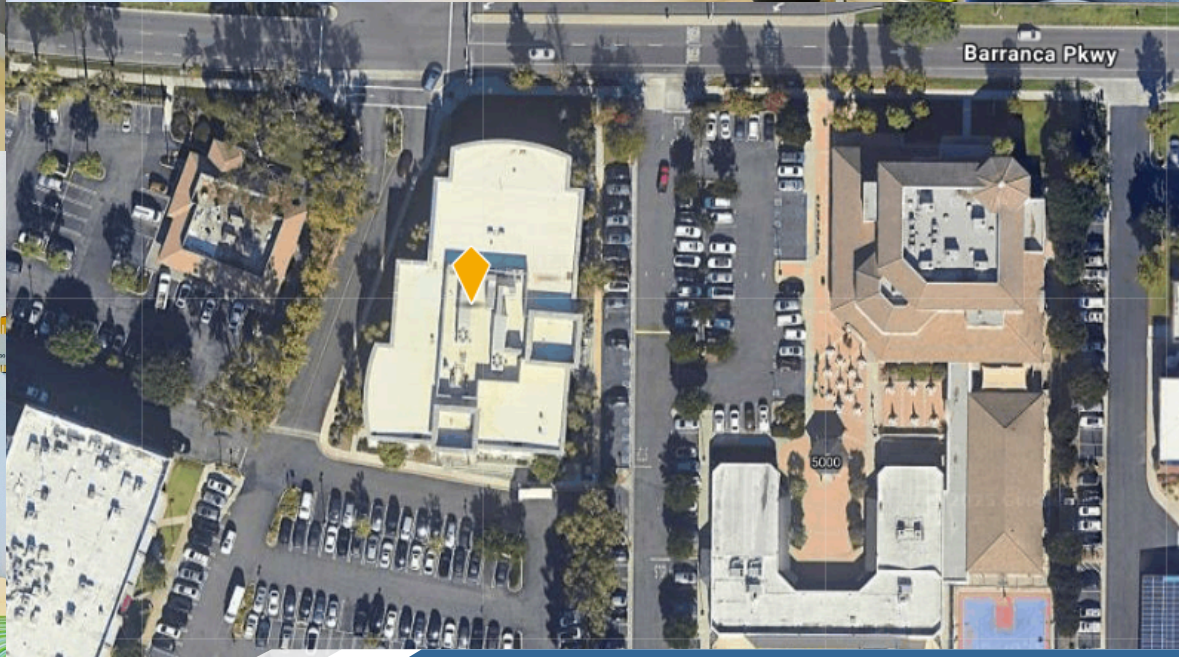

John Bucher
Partner
T 949.468.2246
C 949.463.5672

Paulina Salazar
Senior Associate
T 714.244.7310
C 714.244.7310

