

Office Space
For Lease

CBRE

1350

Sherbrooke Street West

Suite 1150 | Montréal



Lease Terms

Term	5 Years
Area	2,683 sq. ft.
Semi-Gross Rent	\$38.00
Hydro	Metered
In-Suite Cleaning	Included
Availability	Immediate



Floor Plans

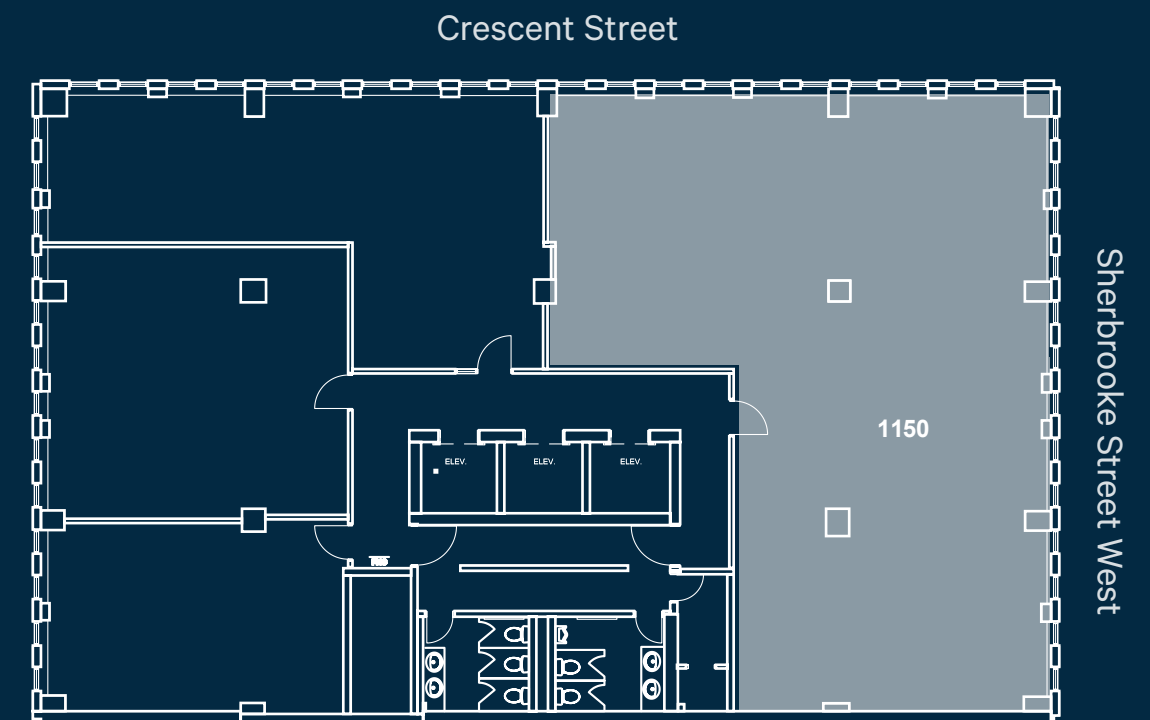



Property Details



Located on the corner of Sherbrooke and Crescent in the heart of the Golden Square Mile



Space benefits from abundant natural light and offers exceptional, direct mountain views



Steps from restaurants, coffee shops, and premium retail



Interior parking available



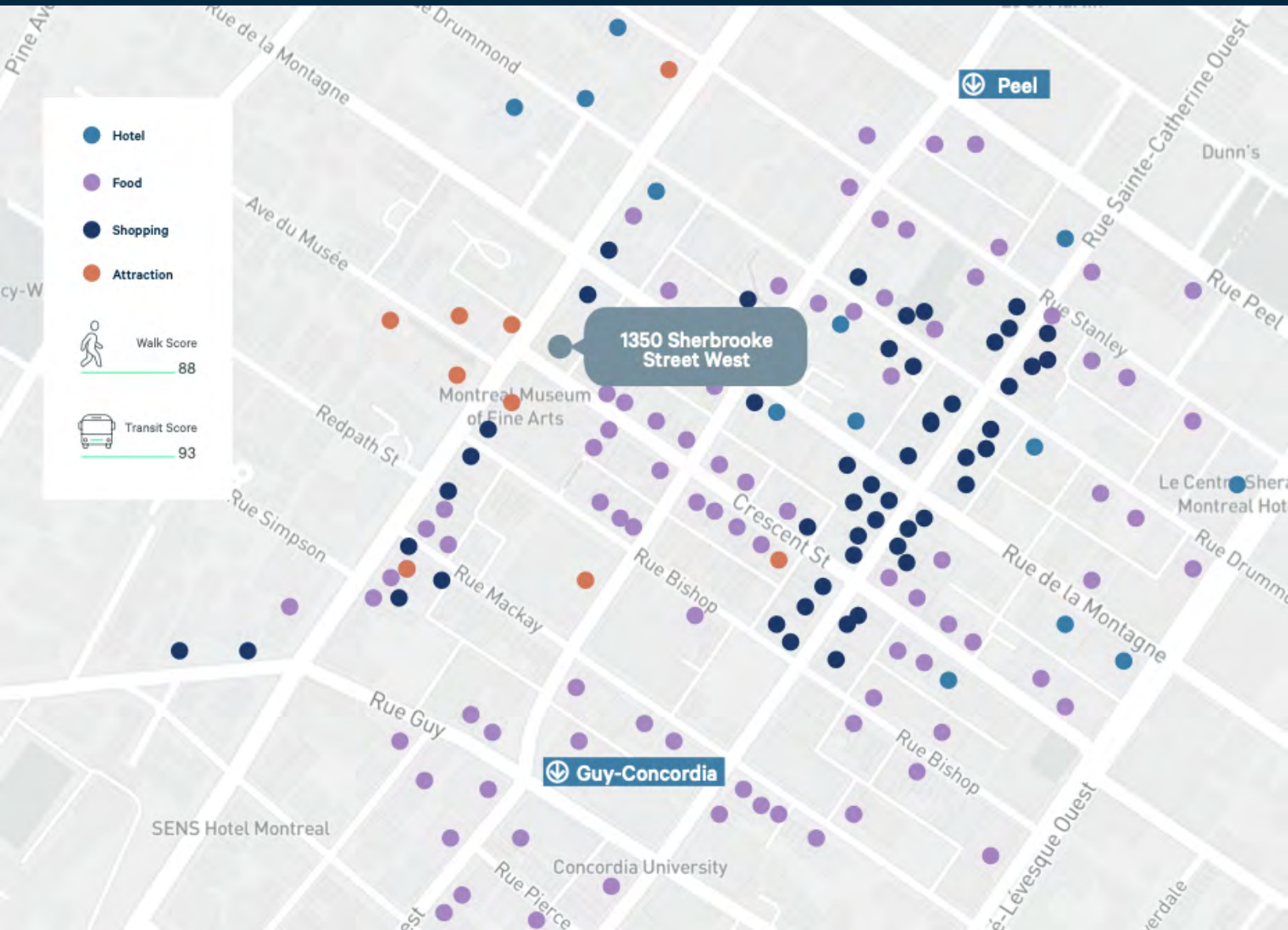

Contact Us

Christopher Rundle
 Vice President
 Real Estate Broker
 +1 514 375 0818
 christopher.rundle@cbre.com

Bryan Greenberg
 Associate Vice President
 Commercial Real Estate Broker
 +1 514 375 2507
 bryan.greenberg@cbre.com

Amanda Angela Herbu
 Associate
 Commercial Real Estate Broker
 +1 514 375 0456
 amanda.herbu@cbre.com

CBRE Limited, Real Estate Agency | 1250 René-Lévesque Blvd West, Suite 2800 | Montréal, Québec H3B 4W8 | +1 514 849 6000 | www.cbre.ca

This disclaimer shall apply to CBRE Limited, and to all divisions of the Corporation ("CBRE"). The information set out herein (the "Information") has not been verified by CBRE, and CBRE does not represent, warrant or guarantee the accuracy, correctness and completeness of the Information. CBRE does not accept or assume any responsibility or liability, direct or consequential, for the Information or the recipient's reliance upon the Information. The recipient of the Information should take such steps as the recipient may deem necessary to verify the Information prior to placing any reliance upon the Information. The Information may change and any property described in the Information may be withdrawn from the market at any time without notice or obligation to the recipient from CBRE.