

Valley View Farms Business Center

11,760 SF AVAILABLE
\$1.50 PSF NET | LOW NET FEES

14101 ROSECRANS AVENUE, UNIT J
LA MIRADA, CA 90638



BUILDING FEATURES

- ±11,760 Square Feet
- ±725 SF Office Area
- High Image Business Park
- 24' Minimum Clearance
- Four (4) Dock High Doors
- Two (2) Grade Level Loading
- Fire Sprinklers
- 200 Amps, 277/480 Volt Power
- Immediate Access to 5 and 91 Freeways
- Available on 30-Day Notice

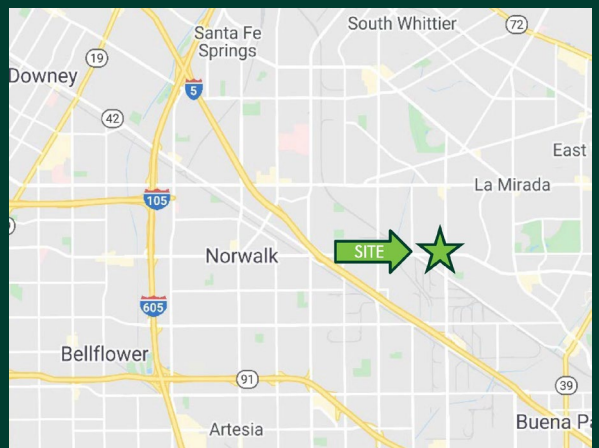

Valley View Farms Business Center

For Lease

11,760 SF AVAILABLE
\$1.50 PSF NET | LOW NET FEES

14101 ROSECRANS AVENUE, UNIT J
LA MIRADA, CA 90638

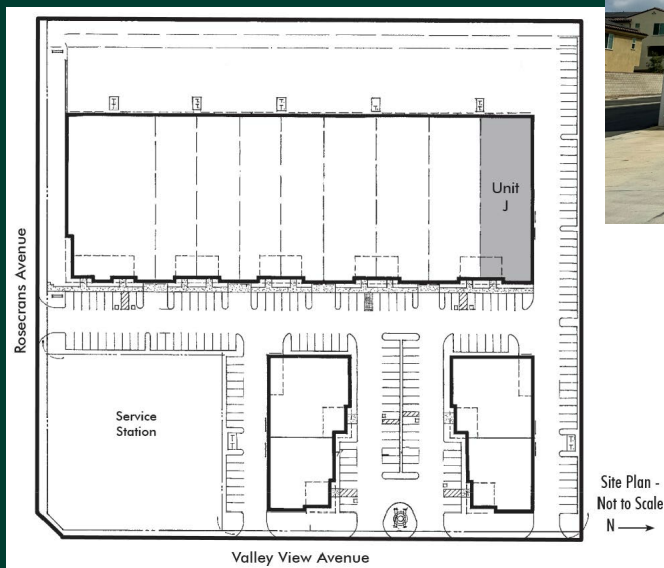

CONTACT US

Laird A. Perkins	Blake Wade
Senior Vice President	Senior Associate
Lic. 00966207	Lic. 02118407
+1 310 363 4920	+1 949 878 2933
laird.perkins@cbre.com	blake.wade@cbre.com

© 2026 CBRE, Inc. All rights reserved. This information has been obtained from sources believed reliable, but has not been verified for accuracy or completeness. You should conduct a careful, independent investigation of the property and verify all information. Any reliance on this information is solely at your own risk. CBRE and the CBRE logo are service marks of CBRE, Inc. All other marks displayed on this document are the property of their respective owners, and the use of such logos does not imply any affiliation with or endorsement of CBRE. Photos herein are the property of their respective owners. Use of these images without the express written consent of the owner is prohibited.

CBRE