

6316 & 6320 N Navarro St

7,791 RSF of Medical Office Space

6316 & 6320 N. Navarro Street
Victoria, TX 77904
www.cbre.com/properties

Available for Sublease



7,791 RSF

Available Immediately
Term through March 1, 2029

Highlights

- + Move-in ready
- + 2nd generation clinical and physical therapy space
- + Updated finishes throughout
- + Suite can be subdivided
- + Unfinished 2nd floor area for storage space and IT room
- + Parking Ratio: 4.8:1,000 SF
- + Monument Signage Available

Floor Plan - 7,791 RSF

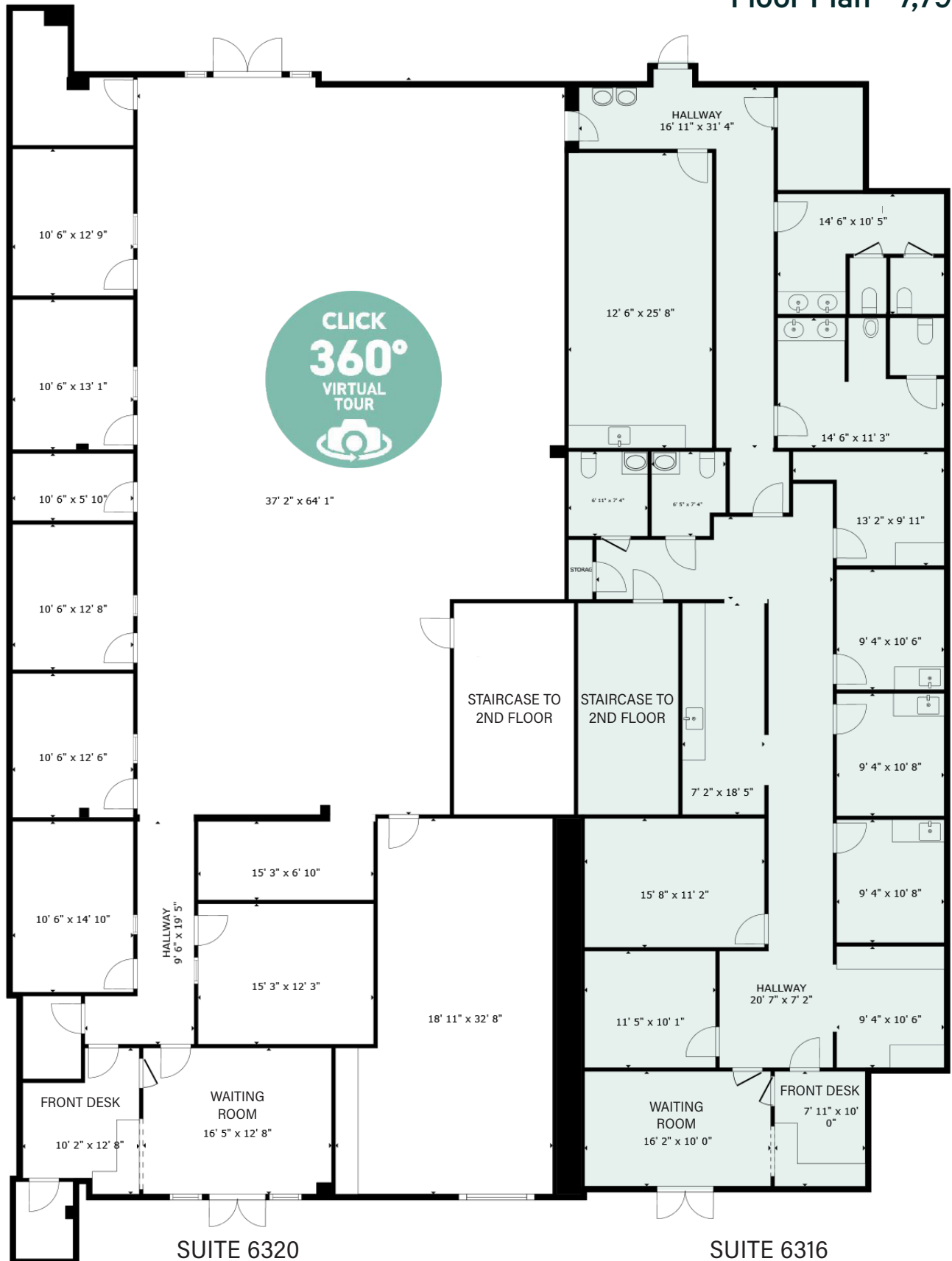



SUITE 6320

SUITE 6316

Interior Photos

Contact Us

Annie Peretich

Associate

+1 317 688 1616

annie.peretich@cbre.com

© 2026 CBRE, Inc. All rights reserved. This information has been obtained from sources believed reliable, but has not been verified for accuracy or completeness. You should conduct a careful, independent investigation of the property and verify all information. Any reliance on this information is solely at your own risk. CBRE and the CBRE logo are service marks of CBRE, Inc. All other marks displayed on this document are the property of their respective owners, and the use of such logos does not imply any affiliation with or endorsement of CBRE. Photos herein are the property of their respective owners. Use of these images without the express written consent of the owner is prohibited.