

AVAILABLE FOR LEASE
46 NORTH WEST AVENUE
UNIT B2
VINELAND, NJ 08360



20,000 SF INDUSTRIAL

IDEAL LAB OR RESEARCH SPACE

PROPERTY HIGHLIGHTS

- 20,00± SF industrial space with office
- 15' clear ceiling height
- 11' x 20' column spacing
- 1 loading dock
- Office space: 7 private offices, 2 conference rooms, breakroom with kitchenette, large bullpen area
- Excellent location in Vineland's primary commercial district. Just off Landis Avenue. One block from Delsea Drive (Route 47)

CONTACT

SCOTT MERTZ, SIOR

+1 856 802 6529

scott.mertz@naimertz.com

NAIMertz
856.234.9600 | naimertz.com

NAI MERTZ DISCLAIMER: NO WARRANTY OR REPRESENTATION, EXPRESS OR IMPLIED, IS MADE AS TO THE ACCURACY OF THE INFORMATION CONTAINED HEREIN, AND THE SAME IS SUBMITTED SUBJECT TO ERRORS, OMISSIONS, CHANGE OF PRICE, RENTAL OR OTHER CONDITIONS, PRIOR SALE, LEASE OR FINANCING, OR WITHDRAWAL WITHOUT NOTICE, AND OF ANY SPECIAL LISTING CONDITIONS IMPOSED BY OUR PRINCIPALS NO WARRANTIES OR REPRESENTATIONS ARE MADE AS TO THE CONDITION OF THE PROPERTY OR ANY HAZARDS CONTAINED THEREIN ARE ANY TO BE IMPLIED. OUTLINES ARE APPROXIMATE AND SHOWN ONLY TO IDENTIFY THE PARCEL IN CONSIDERATION.

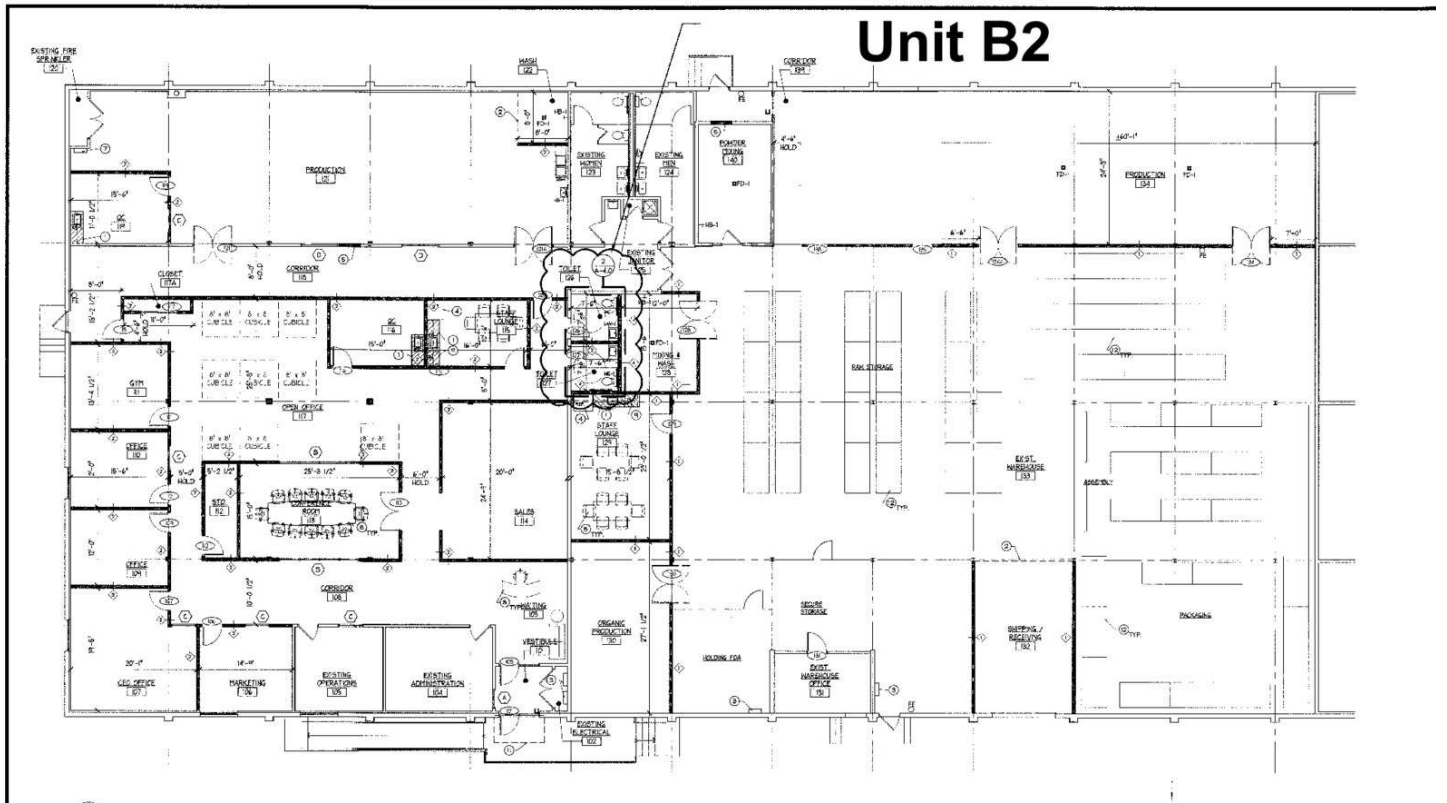

CONTACT

SCOTT MERTZ, SIOR
+1 856 802 6529
scott.mertz@naimertz.com

LOCATION MAP

46 NORTH WEST AVENUE - UNIT B2 VINELAND, NJ

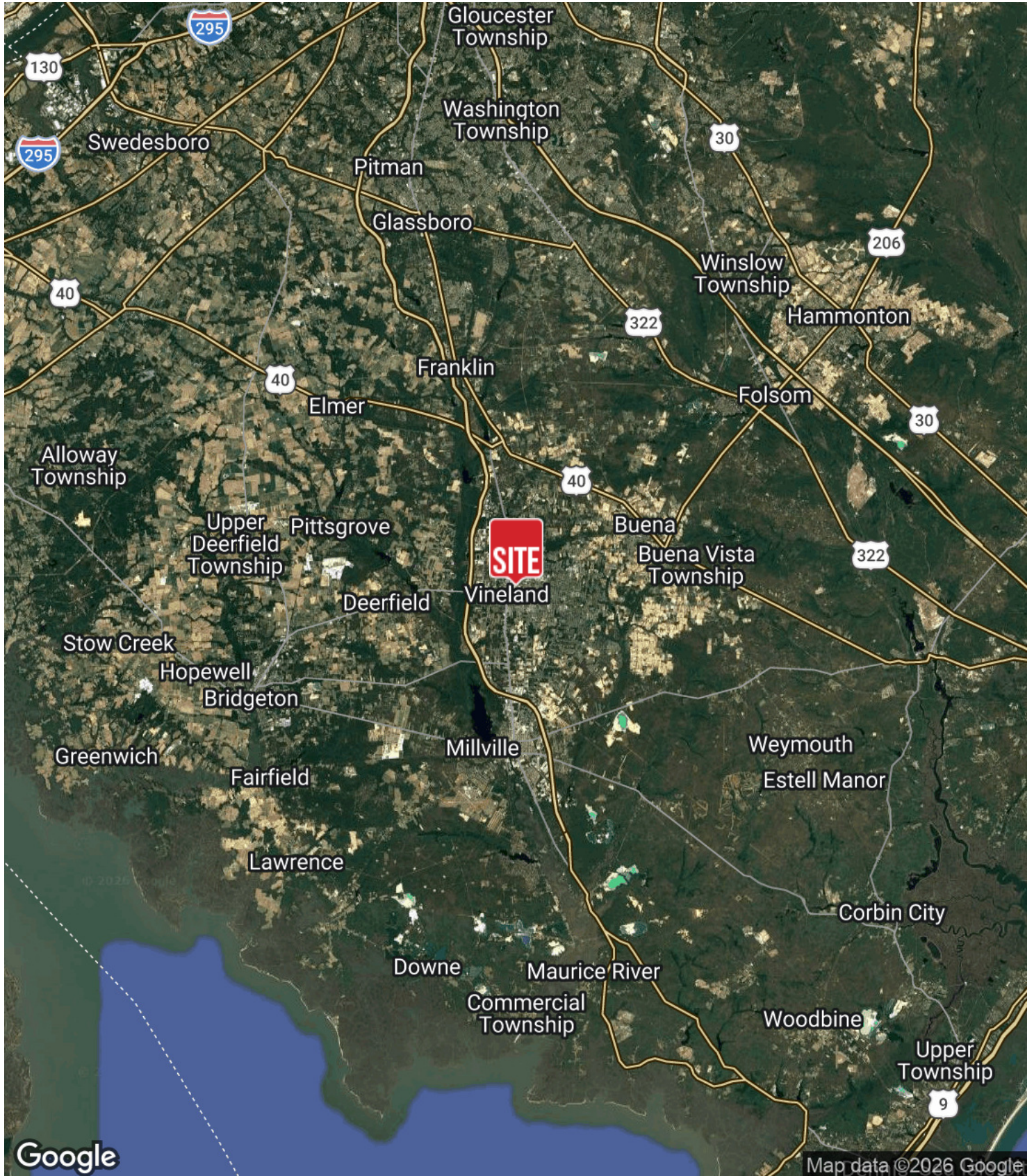

CONTACT

SCOTT MERTZ, SIOR

+1 856 802 6529

scott.mertz@naimertz.com

NAIMertz

856.234.9600 | naimertz.com