



# For sale or lease

Impeccably maintained 36,046 SF building  
10450 Hickman Mills Drive, Kansas City, MO

**Jayme Miller**  
jayme.miller@jll.com  
816 261 2006

# Property Specifications

10450 Hickman Mills Drive

- Single tenant, impeccably maintained building
- 36,046 square feet
- Van-high loading
- Fenced outdoor play area
- Kitchen & laundry facilities
- Formerly used as Oracle's corporate daycare
- Perfect for schools, medical office, or non-profits
- Zoning: UR
- Lease Rate: Negotiable
- **Asking Price: \$2,150,000**



# Floor Plan

36,046 square feet

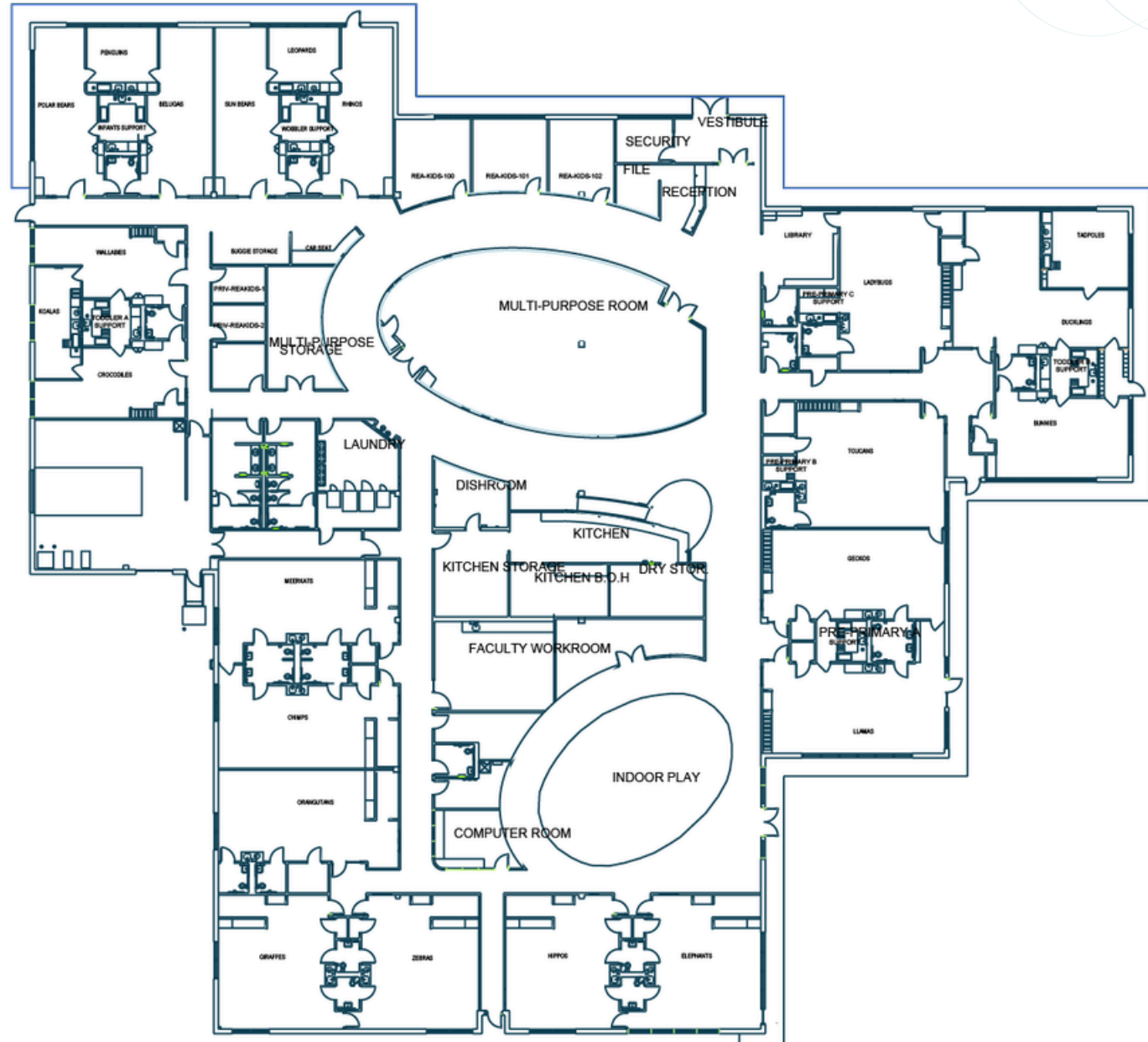

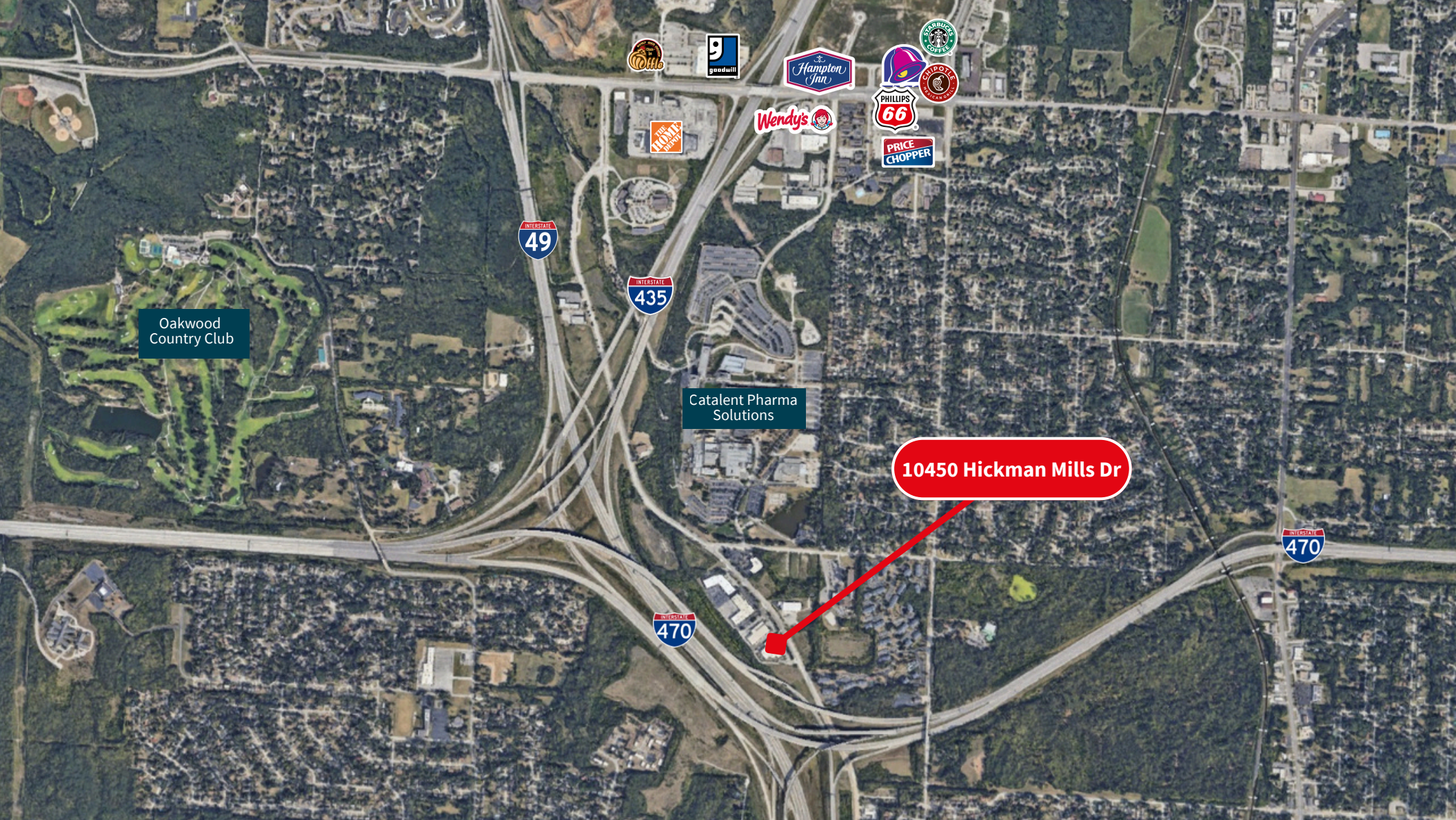

Oakwood Country Club

Catalent Pharma Solutions

10450 Hickman Mills Dr

**Jayne Miller**  
jayme.miller@jll.com  
816 261 2006

**jll.com/kansas-city**  
Jones Lang LaSalle Brokerage, Inc.

Although information has been obtained from sources deemed reliable, neither Owner nor JLL makes any guarantees, warranties or representations, express or implied, as to the completeness or accuracy as to the information contained herein. Any projections, opinions, assumptions or estimates used are for example only. There may be differences between projected and actual results, and those differences may be material. The Property may be withdrawn without notice. Neither Owner nor JLL accepts any liability for any loss or damage suffered by any party resulting from reliance on this information. If the recipient of this information has signed a confidentiality agreement regarding this matter, this information is subject to the terms of that agreement. ©2025. Jones Lang LaSalle Brokerage, Inc. All rights reserved.