

FOR LEASE

LAKE CITY SQUARE

12513 LAKE CITY WAY NE, SEATTLE, WA 98125

Two Spaces Available for Lease

- Suite 1 - 2,019 RSF
 - Kinko's Office
 - Available May 1, 2024
 - Great visibility
 - Ample parking
- Suite 2 - 16,742 RSF
 - Company Space
 - Available Now
 - Excellent visibility on Lake City Way
 - Signage available
 - Ample parking

JIM LOVSTED

206.398.2271 | jim.lovsted@kidder.com

KIDDER.COM

This information supplied herein is from sources we deem reliable. It is provided without any representation, warranty, or guarantee, expressed or implied as to its accuracy. Prospective Buyer or Tenant should conduct an independent investigation and verification of all matters deemed to be material, including, but not limited to, statements of income and expenses. Consult your attorney, accountant, or other professional advisor.



FOR LEASE

CURRENT FEDEX FLOOR PLAN

2,019 SF

AVAILABLE



KIDDER.COM

This information supplied herein is from sources we deem reliable. It is provided without any representation, warranty, or guarantee, expressed or implied as to its accuracy. Prospective Buyer or Tenant should conduct an independent investigation and verification of all matters deemed to be material, including, but not limited to, statements of income and expenses. Consult your attorney, accountant, or other professional advisor.



FOR LEASE

FORMER BARTELL DRUG FLOOR PLAN

16,742 SF

SUITE 301-B

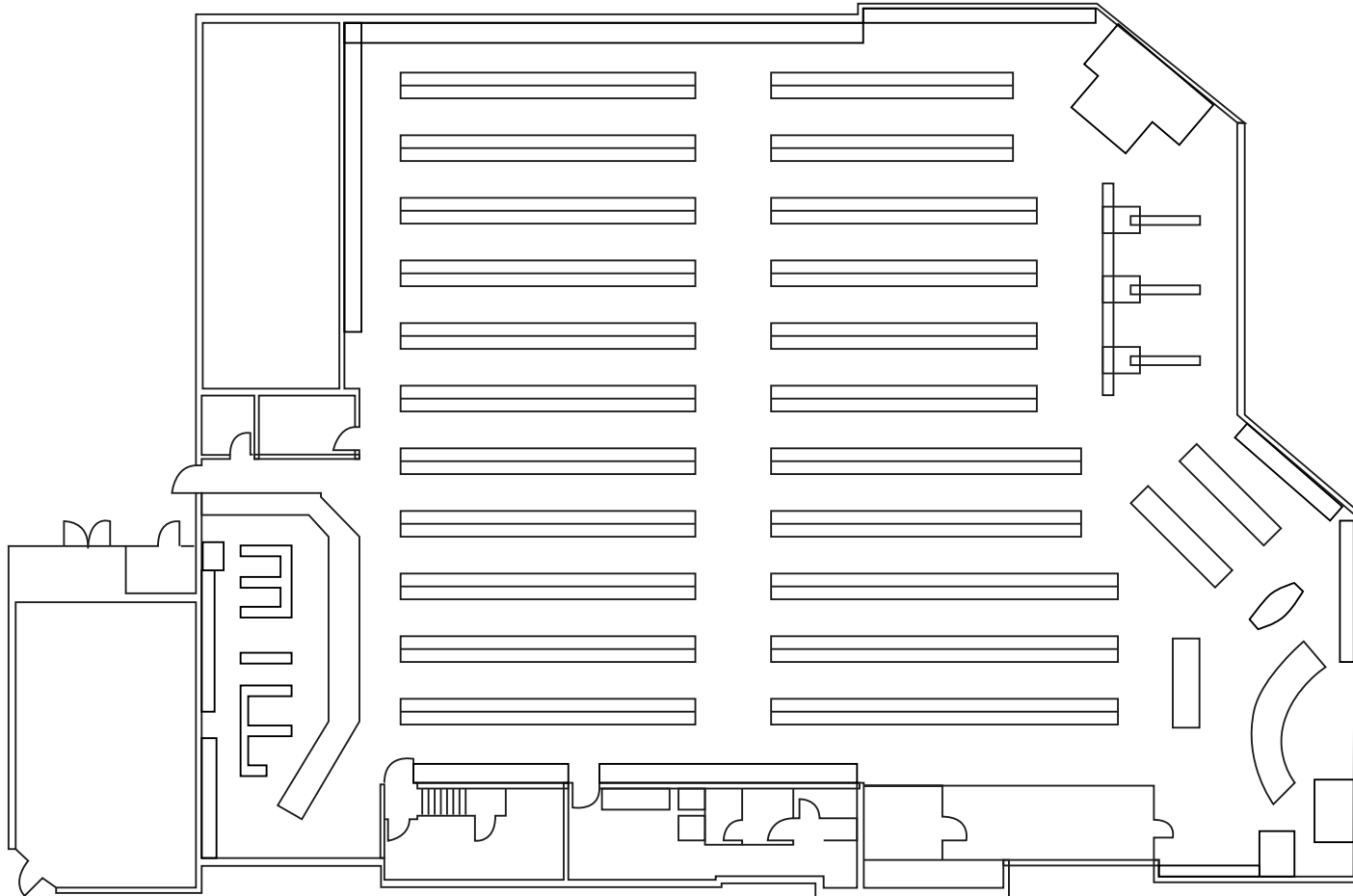

KIDDER.COM

This information supplied herein is from sources we deem reliable. It is provided without any representation, warranty, or guarantee, expressed or implied as to its accuracy. Prospective Buyer or Tenant should conduct an independent investigation and verification of all matters deemed to be material, including, but not limited to, statements of income and expenses. Consult your attorney, accountant, or other professional advisor.

