

# FOR LEASE

UP TO 9,301 SF (DIVISIBLE) CLASS A OFFICE, CENTERRA RESOURCE PARK  
21 Lafayette Street, 3<sup>RD</sup> Floor, Lebanon, NH



# FOR LEASE

UP TO 9,301 SF (DIVISIBLE) CLASS A OFFICE, CENTERRA RESOURCE PARK  
21 Lafayette Street, 3<sup>RD</sup> Floor, Lebanon, NH

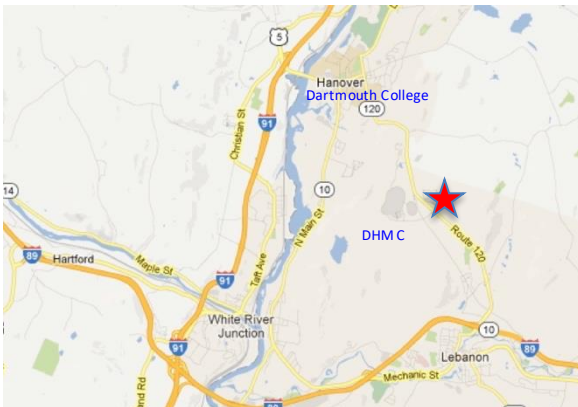

### Strategically Located

- Adjacent to DHMC, a 2msf super-regional medical center.
- 2 miles south of Dartmouth College, The Tuck School of Business, Thayer School of Engineering, and Geisel School of Medicine.
- 2 miles north of I-89
- 6 miles from Lebanon Airport and the I-89 / I-91 intersection

### World-Class Neighbors

- In Centerra, you will be in very good company. The Park is home to some of the region's -and world's-leading enterprises. (See map to right)

**First-Class Amenities** Close proximity to Centerra's amenities provides work-day efficiency. Tenants at 21 Lafayette are walking distance to:

- The River Valley Health & Tennis Club
- RVC Fit Kids Childcare Center
- The Co-op Food Store and Food Court
- Dartmouth Health Pharmacy
- NH State Wine & Liquor Outlet
- Wells Fargo Advisors
- Tyler Simms CPA
- Snax Restaurant
- Marriot Residence Inn and Marriot Courtyard
- Dartmouth Hitchcock Medical Center

# FOR LEASE

**UP TO 9,301 SF (DIVISIBLE) CLASS A OFFICE, CENTERRA RESOURCE PARK  
21 Lafayette Street, 3<sup>RD</sup> Floor, Lebanon, NH**



## Property

- Class A Construction / Built in 2001-2002
- Parking: Free Tenant Parking. Spaces (4/1000) are located in the front of the building with easy access to the lobby.
- Telecom: CAT5 wire to fiber, or your choice of carrier. 3-5 bar cell service
- HVAC (included in Common Charge): Efficient, local controls.
- Elevator: Passenger Elevator Located in Central Lobby.
- Compliance & Life Safety: ADA Compliant and fully sprinklered

## Tenants

3<sup>rd</sup> Floor: **up to 9,301 SF Available**, Dartmouth Hitchcock, Commonwealth Financial  
2<sup>nd</sup> Floor: **4,606 SF(Divisible) Available**, Mary Hitchcock Mem'l Hospital  
1<sup>st</sup> Floor: TomTom, Siemens

## Owner & Management

- EverGreen Capital Partners is an institutional quality owner-manager, and the largest owner within Centerra. EverGreen is known to be highly responsive and has offices adjacent to 21 Lafayette.

# FOR LEASE

9,301 SF (DIVISIBLE) CLASS A OFFICE, CENTERRA RESOURCE PARK  
21 Lafayette Street, 3<sup>RD</sup> Floor, Lebanon, NH

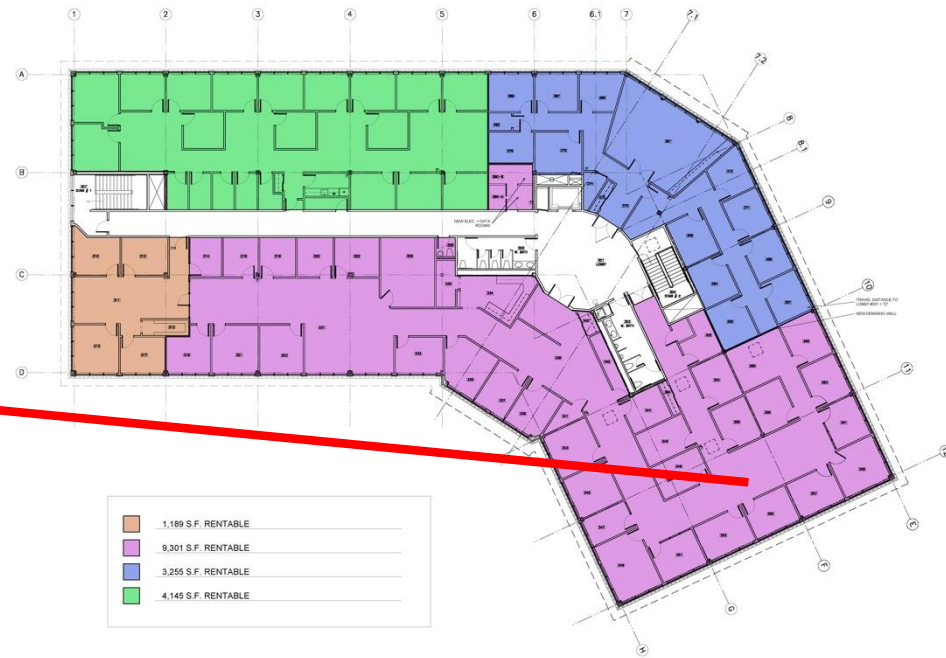



# FOR LEASE

**UP TO 9,301 SF (DIVISIBLE) CLASS A OFFICE, CENTERRA RESOURCE PARK  
21 Lafayette Street, 3<sup>RD</sup> Floor, Lebanon, NH**



**Chip Brown. Principal Broker BCR 44 S. Main Street, #10, Hanover NH. 03755 [chip@browncr.com](mailto:chip@browncr.com). C: 917-375-0746 T: 603-652-1499**

# FOR LEASE

UP TO 9,301 SF (DIVISIBLE) CLASS A OFFICE, CENTERRA RESOURCE PARK  
21 Lafayette Street, 3<sup>RD</sup> Floor, Lebanon, NH



## Available Space

- Up To 9,301 square feet (divisible to +/-2,000 SF) of Class A office space
- Efficient layout (13.6% common area factor). 24-26' column widths, and 36' window to common corridor depths.
- Ceilings height of 12' to deck, 9' to drop ceiling.
- Windows are efficient and operable.
- ADA compliant.

## Economics (Year 1)

- Base Rent = \$25/SF, NNN, with CPI escalation over term.
- Common Charges\*=+/-\$12.62/SF
- **TOTAL RENT = \$37.62/SF (Year 1 Estimate) =**
- **If +/-9,301 SF = \$349,903.62/year = \$29,158.64/month**  
\*Common charges ('26 estimate) include all common area and exterior maintenance, accounting, real estate taxes, insurance, utilities and trash removal. *Tenants pay separately for their Premises electric.*
- Lease Term: Minimum of 5 years.



# NEW HAMPSHIRE REAL ESTATE COMMISSION

121 South Fruit Street, Ste 201 Concord, NH 03301 Tel.: (603) 271-2701

## BROKERAGE RELATIONSHIP DISCLOSURE FORM

**(This is Not a Contract)**

*This form shall be presented to the consumer at the time of first business meeting, prior to any discussion of confidential information*

### **Right Now You Are A Customer**

As a customer, the licensee with whom you are working is not obligated to keep confidential the information that you might share with him or her. As a customer, you should not reveal any confidential information that could harm your bargaining position.

**As a customer, you can expect a real estate licensee to provide the following customer-level services:**

- To disclose all material defects actually known by the licensee pertaining to the on-site physical condition of the real estate;
- To treat both the buyer/tenant and seller/landlord honestly;
- To provide reasonable care and skill;
- To account for all monies received from or on behalf of the buyer/tenant or seller/landlord relating to the transaction;
- To comply with all state and federal laws relating to real estate brokerage activity; and
- To perform ministerial acts, such as showing property, preparing and conveying offers, and providing information and administrative assistance.

### **To Become A Client**

Clients receive more services than customers. You become a client by entering into a written contract for representation as a seller/landlord or as a buyer/tenant.

**As a client, in addition to the customer-level services, you can expect the following client-level services:**

- Confidentiality;
- Loyalty;
- Disclosure;
- Lawful Obedience; and
- Promotion of the client's best interest.

For seller/landlord clients this means the agent will put the seller/landlord's interests first and work on behalf of the seller/landlord.

For buyer/tenant clients this means the agent will put the buyer/tenant's interest first and work on behalf of the buyer/tenant.

**Client-level services also include advice, counsel and assistance in negotiations.**

**For important information about your choices in real estate relationships, please see page 2 of this disclosure form.**

I acknowledge receipt of this disclosure as required by the New Hampshire Real Estate Commission (Pursuant to Rea 701.01).

**I understand as a customer I should not disclose confidential information.**

Name of Consumer (Please Print)

Name of Consumer (Please Print)

Signature of Consumer

Date

Signature of Consumer

Date

Provided by:

Licensee

Date

(Name of Real Estate Brokerage Firm)

Consumer has declined to sign this form.

(Licensees Initials)

To check on the license status of a real estate firm or licensee go to [www.nh.gov/nhrec](http://www.nh.gov/nhrec). Inactive licensees may not practice real estate brokerage.

*Types of Brokerage Relationships commonly practiced in New Hampshire*

*SELLER AGENCY (RSA 331-A:25-b)*

A seller agent is a licensee who acts on behalf of a seller or landlord in the sale, exchange, rental, or lease of real estate. The seller is the licensee's client and the licensee has the duty to represent the seller's best interest in the real estate transaction.

*BUYER AGENCY (RSA 331-A:25-c)*

A buyer agent is a licensee who acts on behalf of a buyer or tenant in the purchase, exchange, rental, or lease of real estate. The buyer is the licensee's client and the licensee has the duty to represent the buyer's best interests in the real estate transaction.

*SINGLE AGENCY (RSA 331-A:25-b; RSA 331-A:25-c)*

Single agency is a practice where a firm represents the buyer only, or the seller only, but never both in the same transaction. Disclosed dual agency cannot occur.

*SUB-AGENCY (RSA 331-A:2, XIII)*

A sub-agent is a licensee who works for one firm, but is engaged by the principal broker of another firm to perform agency functions on behalf of the principal broker's client. A sub-agent does not have an agency relationship with the customer.

*DISCLOSED DUAL AGENCY (RSA 331-A:25-d)*

A disclosed dual agent is a licensee acting for both the seller/landlord and the buyer/tenant in the same transaction with the knowledge and written consent of all parties.

The licensee cannot advocate on behalf of one client over another. Because the full range of duties cannot be delivered to both parties, written informed consent must be given by all clients in the transaction.

A dual agent may not reveal confidential information without written consent, such as:

1. Willingness of the seller to accept less than the asking price.
2. Willingness of the buyer to pay more than what has been offered.
3. Confidential negotiating strategy not disclosed in the sales contract as terms of the sale.
4. Motivation of the seller for selling nor the motivation of the buyer for buying.

*DESIGNATED AGENCY (RSA 331-A:25-e)*

A designated agent is a licensee who represents one party of a real estate transaction and who owes that party client-level services, whether or not the other party to the same transaction is represented by another individual licensee associated with the same brokerage firm.

*FACILITATOR (RSA 331-A:25-f)*

A facilitator is an individual licensee who assists one or more parties during all or a portion of a real estate transaction without being an agent or advocate for the interests of any party to such transaction. A facilitator can perform ministerial acts, such as showing property, preparing and conveying offers, and providing information and administrative assistance, and other customer-level services listed on page 1 of this form. This relationship may change to an agency relationship by entering into a written contract for representation, prior to the preparation of an offer.

*ANOTHER RELATIONSHIP (RSA 331-A:25-a)*

If another relationship between the licensee who performs the services and the seller, landlord, buyer or tenant is intended, it must be described in writing and signed by all parties to the relationship prior to services being rendered.