

### Building Sketch

<b>Borrower</b>			
Property Address	5039 Primrose Road		
City	County	State	Zip Code
<b>Lender/Client</b>			

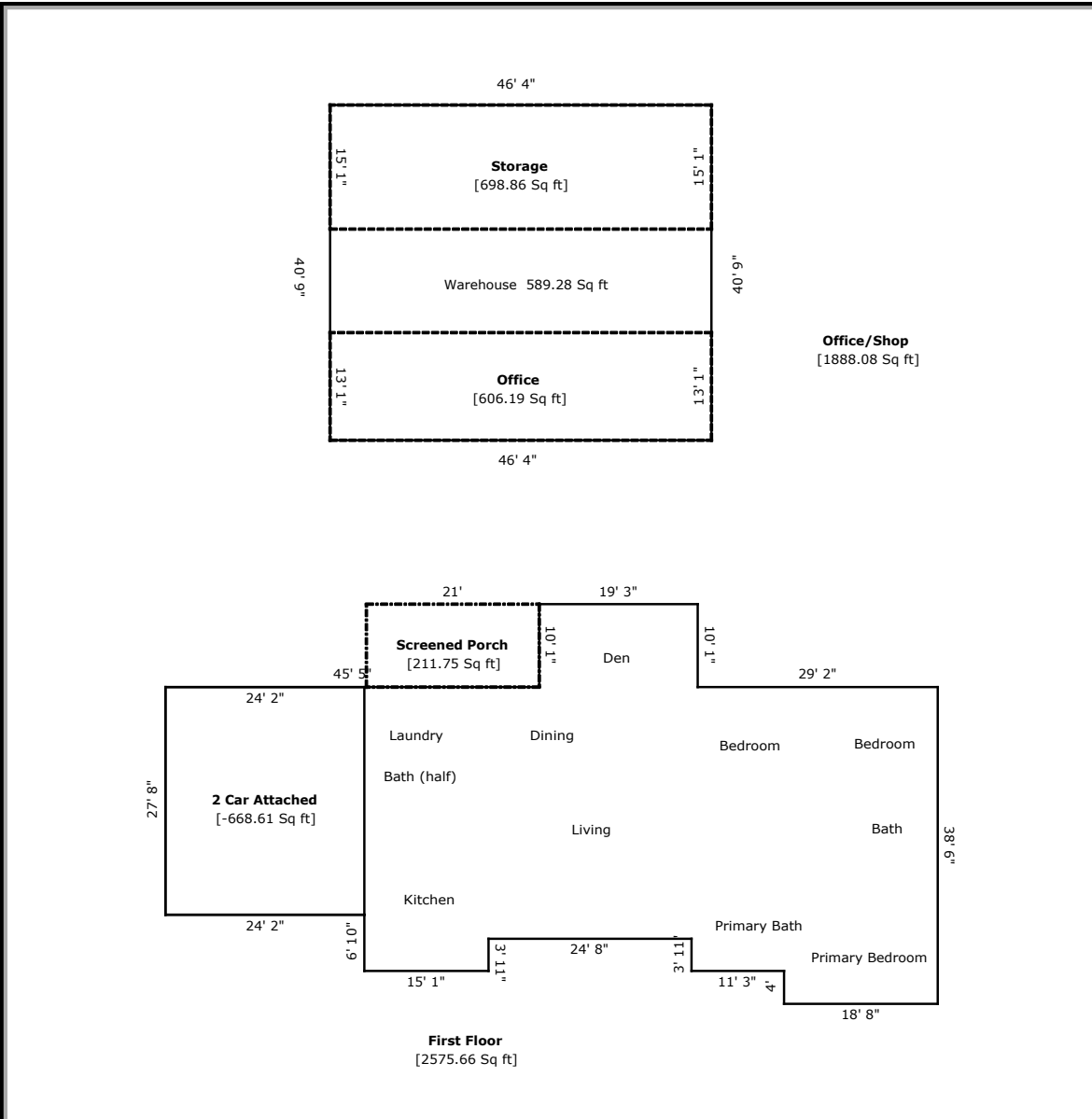

TOTAL Sketch by a la mode

#### Area Calculations Summary

Living Area	Calculation Details	
First Floor	3244.27 Sq ft	$19.25 \times 10.08 = 194.1$ $27.67 \times 24.17 = 668.61$ $38.5 \times 18.67 = 718.67$ $51 \times 30.58 = 1559.75$ $3.92 \times 11.25 = 44.06$ $15.08 \times 3.92 = 59.08$
2 Car Attached	-668.61 Sq ft	$24.17 \times 27.67 = 668.61$
<b>Total Living Area (Rounded):</b>	<b>2576 Sq ft</b>	
Non-living Area		
Screened Porch	211.75 Sq ft	$21 \times 10.08 = 211.75$
Office/Shop	1888.08 Sq ft	$40.75 \times 46.33 = 1888.08$
Office	606.19 Sq ft	$13.08 \times 46.33 = 606.19$
Storage	698.86 Sq ft	$15.08 \times 46.33 = 698.86$