**LEGEND**

-  C.E. - COMMON ELEMENT  
 L.E. - LIMITED ELEMENT  
 ELEMENT FOR RECORD

**DIMENSIONS OF UNITS:**

EACH UNIT CONSISTS OF THE AREA MEASURED HORIZONTALY FROM THE OUTSIDE FACE OF THE EXTERIOR WALLS OF THE BUILDING STRIKING THE UNIT TO:  
 A) THE OUTSIDE FACE OF THE EXTERIOR WALLS OF THE BUILDING;  
 B) THE CENTERLINE OF THE PARTITIONS OF THE INTERIOR WALLS SEPARATING THE UNIT FROM ANOTHER UNIT;  
 C) THE EXTERIOR SIDE AND THE STRUCTURE SIDE OF THE PARTITIONS SEPARATING THE UNIT FROM ANOTHER UNIT.

THE VOLUME MEASURED VERTICALLY FROM THE UPPER FACE OF THE FLOORING MATERIAL ON THE LOWER LEVEL OF THE UNIT TO AND INCLUDING THE CEILING MATERIAL ON THE HIGHEST LEVEL OF THE UNIT  
 THE DIMENSIONS OF THE PARTING SPACE UNITS ARE REFLECTED ON THE FLOOR PLAN.

ANY CORNER ELEMENT LOCATED WITHIN A UNIT WILL NOT BE CONSIDERED A PART OF SUCH UNIT.

**DECLARANT OR SPONSOR:**

NAME: \_\_\_\_\_  
 ADDRESS: \_\_\_\_\_

STATE OF NEW YORK  
 COUNTY OF NEW YORK

THIS IS TO CERTIFY THAT THIS AN ACCURATE COPY  
 OF A PORTION OF THE RECORD AS FILED WITH AND APPROVED  
 BY THE COMMISSIONER OF RECORDS, CITY OF NEW YORK, AND FILED  
 AND PART THEREOF THE OFFICIAL RECORDS AND RECORDS AND  
 APPROPRIATE RECORDS OF THE UNITS AS SHOWN.

SHOWN TO BE TRUE AS THE \_\_\_\_\_ DAY OF \_\_\_\_\_ 2008

**TAX LOT CERTIFICATION:**

THE UNIT REPRESENTED AND THE TAX LOT NUMBER SHOWN ABOVE  
 CORRESPOND TO THE OFFICIAL TAX LOT NUMBER SHOWN ON THE BLOCK  
 MAP OF TAXES AND ASSESSMENTS OF THE REAL PROPERTY ASSESSMENT  
 BUREAU OF THE CITY OF NEW YORK, BUREAU OF MANHATTAN.

DATE: \_\_\_\_\_ SIGNATURE: \_\_\_\_\_

6TH FLOOR PLAN

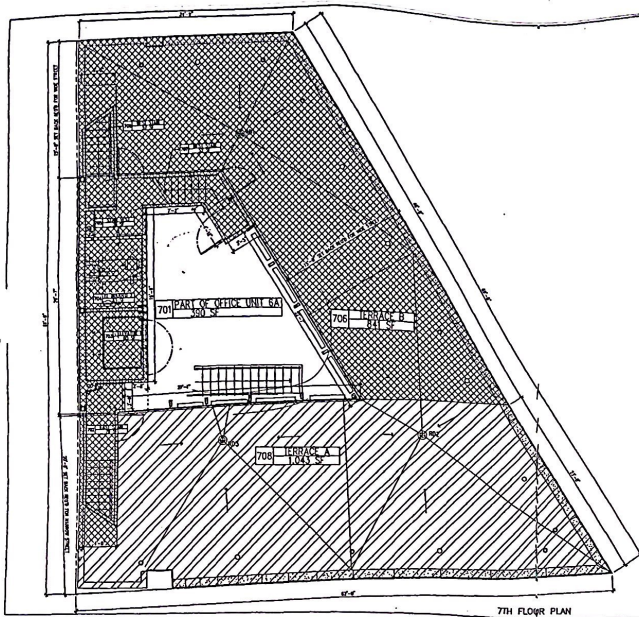
**LEGEND**

-  D.C. - COMMON FLOOR  
 L.L. - LOWER LEVEL  
 SLASH FOR RECEIVING

**DIMENSIONS OF UNITS:**

ALL THE DIMENSIONS OF THE AREA SHOWN HEREIN SHALL BE FROM THE OUTSIDE FACE OF THE EXTERIOR WALLS OF THE BUILDING UNLESS THE UNITS TO:  
 - AT THE OUTSIDE FACE OF THE EXTERIOR WALLS OF THE BUILDING.  
 - AT THE OUTSIDE FACE OF THE EXTERIOR WALLS BEYOND THE UNIT FROM ANOTHER UNIT.  
 - FROM ANOTHER UNIT.  
 - FROM ANOTHER UNIT.  
 - FROM ANOTHER UNIT.

THE WALLS SHOWN HEREIN SHALL BE FROM THE OUTSIDE FACE OF THE EXTERIOR WALLS ON THE CORNER LEVEL OF THE UNIT TO AND INCLUDING THE EXISTING MATERIAL ON THE HIGHEST LEVEL OF THE UNIT.

THE DIMENSIONS OF THE PARKING SPACE UNITS ARE REFLECTED ON THE FLOOR PLAN.

ANY CORNER ELEMENT LOCATED WITHIN A UNIT WILL NOT BE CONSIDERED A PART OF SUCH UNIT.

**DECLAINT OR SPONSOR:**

NAME: \_\_\_\_\_  
 ADDRESS: \_\_\_\_\_

STATE OF NEW YORK  
 COUNTY OF NEW YORK

THIS IS TO CERTIFY THAT THIS IS AN ACCURATE COPY  
 OF A PORTION OF THE RECORDS AS FILED WITH AND APPROVED  
 BY THE COMMISSIONER OF RECORDS, CITY OF NEW YORK, AND TRULY  
 AND FAITHFULLY REFLECTS THE LATEST LOCAL AND RECORDS AND  
 APPROPRIATE INDICATIONS OF THE UNITS AS SHOWN.

DRAWN TO REFLECT THE THIS \_\_\_\_ DAY OF \_\_\_\_ 2008

**TAX LOT CERTIFICATION:**

THE TAX RECEPTION AND THE TAX LOT NUMBER SHOWN HEREIN  
 CORRESPOND TO THE OFFICIAL LIST NUMBER SHOWN ON THE BACK  
 OF TAXES AND RECEIPTS OF THE REAL PROPERTY ASSISTANCE  
 BUREAU OF THE CITY OF NEW YORK, BUREAU OF ADMINISTRATION.

DATE: \_\_\_\_\_  
 SIGNATURE: \_\_\_\_\_





Scanned with CamScanner



Scanned with CamScanner







