

1352-56 W WELLINGTON AVE

lakeview / chicago, il



1352-56 W WELLINGTON AVE

lakeview / chicago, il

ADDRESS

1352-56 W Wellington Ave
Chicago, Illinois

NEC of Southport and
Wellington Avenues

AVAILABILITY

3,570 SF (Divisible)

Space A - 2,015 SF Corner

Space B - 1,555 SF Inline

FEATURES

Unique small-shop opportunities in the heart of Lakeview along the Lincoln Avenue Retail Corridor

Available immediately with flexible delivery conditions

Outdoor seating possible in front of Retail A along Wellington Avenue. Non-black iron users only.

Neighborhood is known for its mix of a family-friendly atmosphere with tree-lined streets, single-family homes and high discretionary income

Surrounded by a mix of regional and locally owned shops, bars, and restaurants

NEIGHBORING RETAILERS



astute
COUNSELING & WELLNESS



HERITAGE
GENERAL STORE



LINCOLN TAP ROOM
WINE BEER LIQUORS

DEMOGRAPHICS

	.5M	1M	1.5M
POPULATION	20,816	80,578	178,434
HOUSEHOLDS	9,496	38,088	96,235
AVG HOUSEHOLD INCOME	\$253,155	\$218,968	\$182,905
DAYTIME POPULATION	16,095	70,163	147,996

1352-56 W WELLINGTON AVE

lakeview / chicago, il

FLOOR PLAN

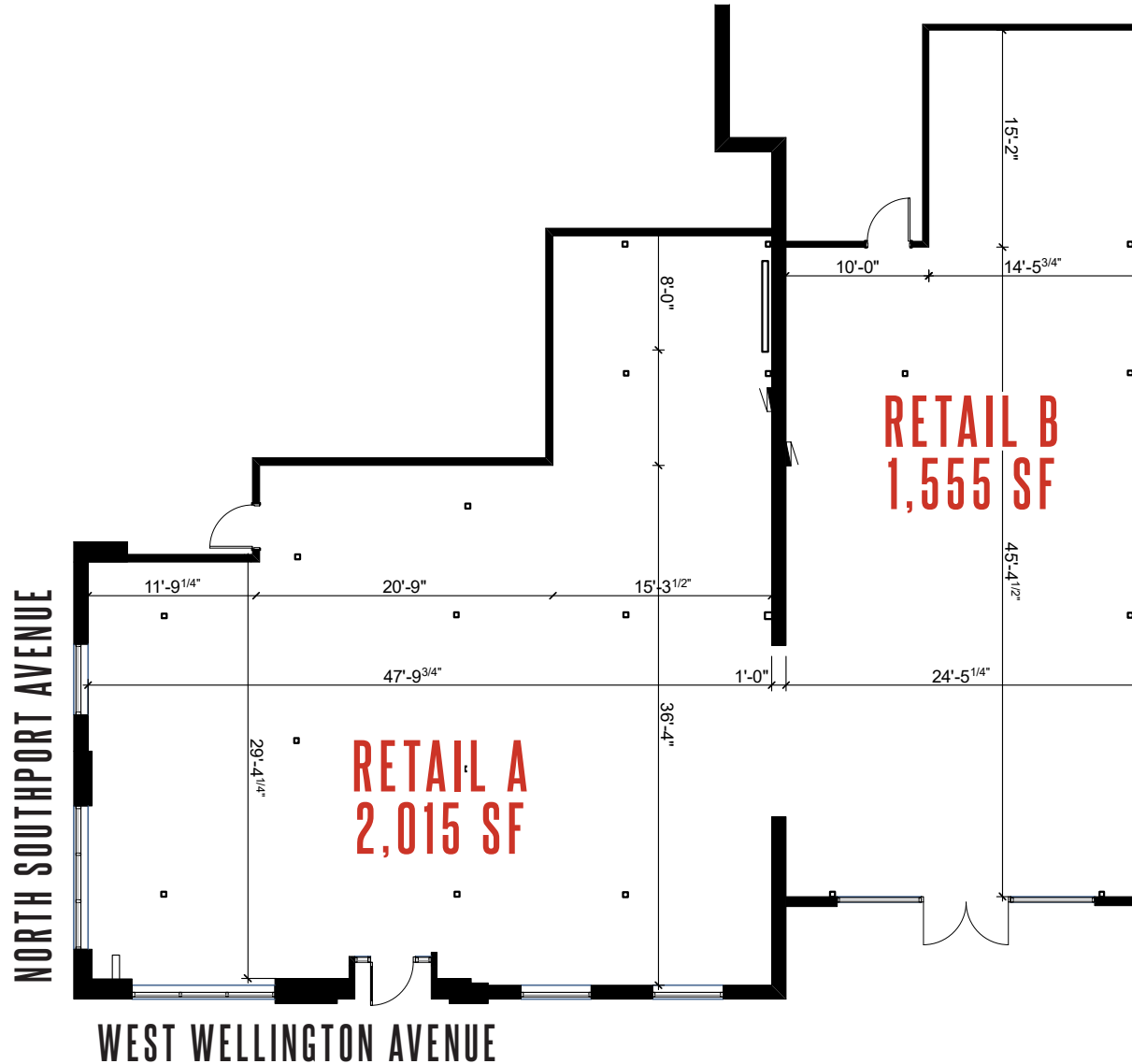

SPACE DETAILS

Retail A: 2,015 SF (Corner)

Retail B: 1,555 SF (Inline)

*Can be combined for total of 3,570 SF

1352-56 W WELLINGTON AVE

lakeview / chicago, il

TRADE AREA MAP





let's **BIG**
talk.

IDEAS?

LARA KEENE

Mid-America Real Estate Corporation

630.481.4038

LKeene@MidAmericaGrp.com

WESTIN KANE

Mid-America Real Estate Corporation

630.954.7447

WKane@MidAmericaGrp.com



MID-AMERICA[®] URBAN