



Space Profile for

Unit: #0009

Area: 9840 sq ft

Address

1923 East Third Street

Williamsport, PA 17701



400 N. Tampa St., Suite 2210

Tampa, FL, 33602

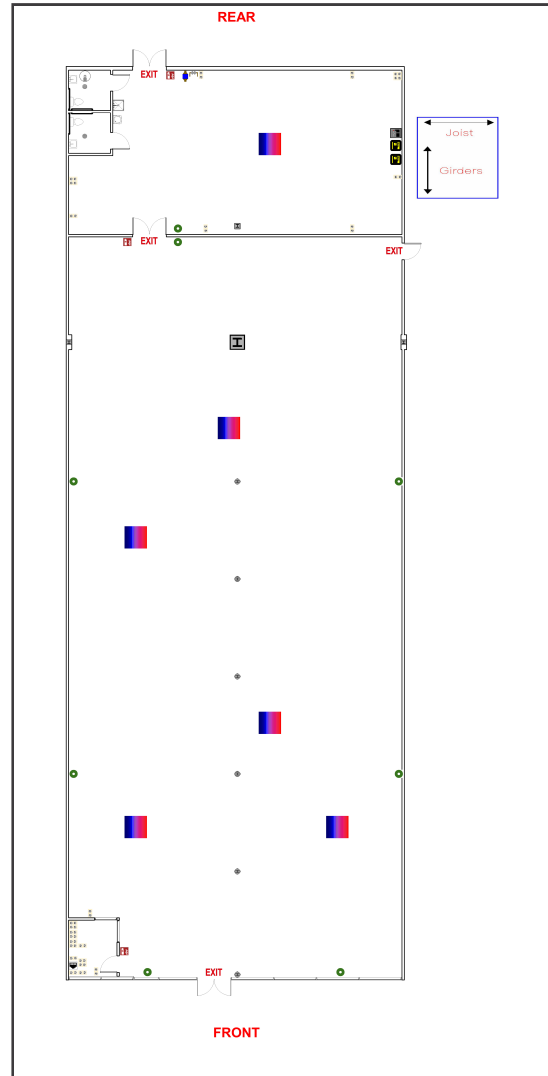

Legend

	Breaker Panel		Fire Extinguisher		Ceiling Fan w/ Light		Fire Sprinkler
	Circular Column		Fire Alarm Pulldown		Rectangular Column		Pocket Door
	Appliance Outlet		Glass Door		Refrigerator		Track Lighting
	Fire Alarm		Handicap Handrail		Roll-Up Door		2-Bulb Fluorescent Lighting
	Drinking Fountain		Roof Hatch		Sink		3-Bulb Fluorescent Lighting
	Door		HVAC Unit		Swing Door		4-Bulb Fluorescent Lighting
	Double Hung Door		Recessed Light		Toilet		Ceiling Air Vent
	Electrical Outlet		Staircase		Can Light		Air Diffuser
	Emergency Light		Water Heater		Urinal		Ceiling Fan w/o Light
	EXIT Light		Telephone Panel		Thermostat		Air Handler
	Tankless Water Heater		Window Wall Opening		RJ 45		Fire Alarm Control Panel
	Step Down Transformer		Maintenance Sink		Window		Tenant Water Meter
	Disconnect		Sub Water Meter		House Gas Meter		Sub Gas Meter
	House Water Meter		Air Handler		House Electric Meter		Tenant Electric Meter
	Tenant Gas Meter						
	Sub Electric Meter						

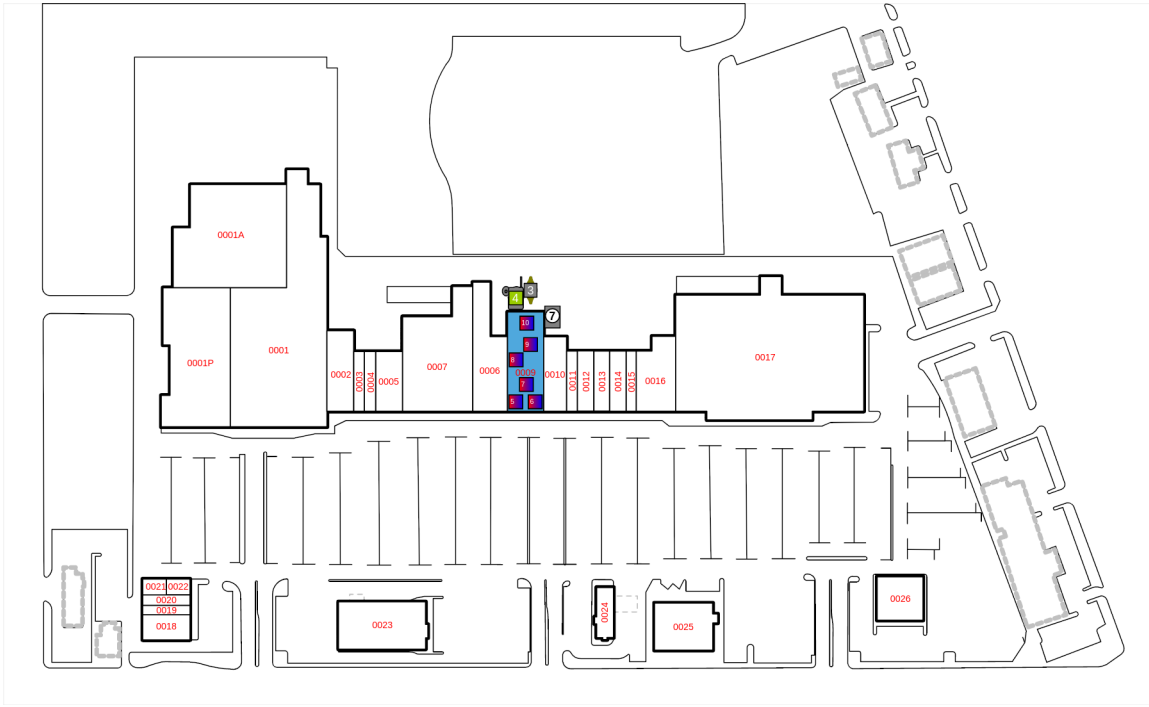

Space Overview

Overview	Actual Square Footage	Measured Depth of Space	Total Depth of Space	Has Stepdown Transformer
	9840 SQFT	164' 0"	164' 0"	No

Thickness	Front Wall	Rear Wall	Left Wall	Right Wall
	0' 5"	0' 8"	0' 5"	0' 5"

Flooring	Concrete	Carpet	Tile	Other	Unit	Total
	9072.56 SQFT			108.76 SQFT	9840 SQFT	9581.32 SQFT

Ceiling Information	Height From Floor To Ceiling	Height From Floor To Bottom Of Deck	Height From Floor To Bottom Of Joist
	Front: 11' 11" Back: 17' 9"	Front: 14' 11" Back: 19' 2"	Front: 13' 7" Back: 17' 9"

Ceiling Information Cont.	Clear Ceiling Height	Height From Floor To Bottom Of Girder	Number Of Acoustical Tiles
	8' 0"		

Other Cont.	Phone Board Location	Mop Sink Location	Thermostat Location	Dmarc Distance	Are Interior Walls Full Height
					No

Other Cont.	Hazardous Materials	Loading Dock	Are Demising Walls Full Height	Changes In Demising Wall Thickness
	No	No	No	No

Mechanical

HVAC	Reference	Manufacturer	Model	Serial	Tonnage	Year	Notes
	7	CARRIER	48TFE006- - -501- -	2101G22298	5	2001	
	10	CARRIER	48TFE006- - -501- -	2101G22280	5	2001	
	9	CARRIER	48TFE006- - -501- -	2101G22297	5	2001	
	6	CARRIER	48TFE006- - -501- -	2101G22301	5	2001	
	8	CARRIER	48TFE006- - -501- -	2101G22303	5	2001	
	5	CARRIER	48TFE006- - -501- -	2101G22299	5	2001	

Electric

Service Panel	Reference	Amps	Service Type	Panel Type	Panel UL Number	Manufacturer	Location	Notes
	2	150	120/208	NLAB Panelboard	Not Listed	General Electric	Storage Room	
	1	150	120/208	NLAB Panelboard	Not Listed	General Electric	Storage Room	

Disconnect	Reference	Amps	Location	Panel Number	Manufacturer	Notes	Handle or Breaker
	7	400	Storage Room	Not Listed	General Electric		Handle

Electric Meter	Reference	Meter #	Location	Meter Reading	Read On	Voltage	Notes
	7	301110015	Right Side Exterior Wall Mounted				120-277V

IDPlans does not provide an Ampacity Report

Plumbing

Water Heater	Reference	Manufacturer	Model	Serial	Gallons	Tankless	Water Line (in)	Location	Notes
	1		A.O. Smith Water Products Company	ELJF 15917	MA01-0053696-917	15	No	.75	Men's Restroom, Above Ceiling

Water Meter	Reference	Meter #	Location	Size	Notes
	3		25725783 / 26725783	Interior of Unit, In Storage Room on Rear Wall	5/8 inch

Waste

No assets available for this section.

Fire

Fire Extinguisher	Number of Fire Extinguishers	Notes
	3	

Sprinkler Heads	Sprinkler Heads Present	Sprinkler Head Type	Riser Located in Space	Riser Location	Additional Information
	0	N/A	No	N/A	No Fire Sprinklers in Unit

Gas

Gas Meter	Reference	Meter #	Location	Size	Notes
		4	4340100	Rear Exterior Wall Mounted	1 1/4 inch

Room

Restroom	Unit	Description
	Restroom 2	Men's Restroom
	Restroom 1	Women's Restroom

Storefront 1

