

1115 RIDGELAND PKWY, SUITE 101 ALPHARETTA, GA 30004

Sublease
20,730± SF Warehouse w/Office Space

CARSON HAWKS

Associate
770.312.0267
chawks@kingindustrial.com

SIM DOUGHTIE, CCIM, SIOR, MCR, SLCR

President
404.942.2002
sdoughtie@kingindustrial.com

RANDALL GOLDSTEIN

GORDON BROTHERS

Senior Director
617.733.8575
rgoldstein@gordonbrothers.com

Co-Listed With



Industrial • Commercial • Investment
404.942.2000 | kingindustrial.com

SUBLEASE
20,720± SF

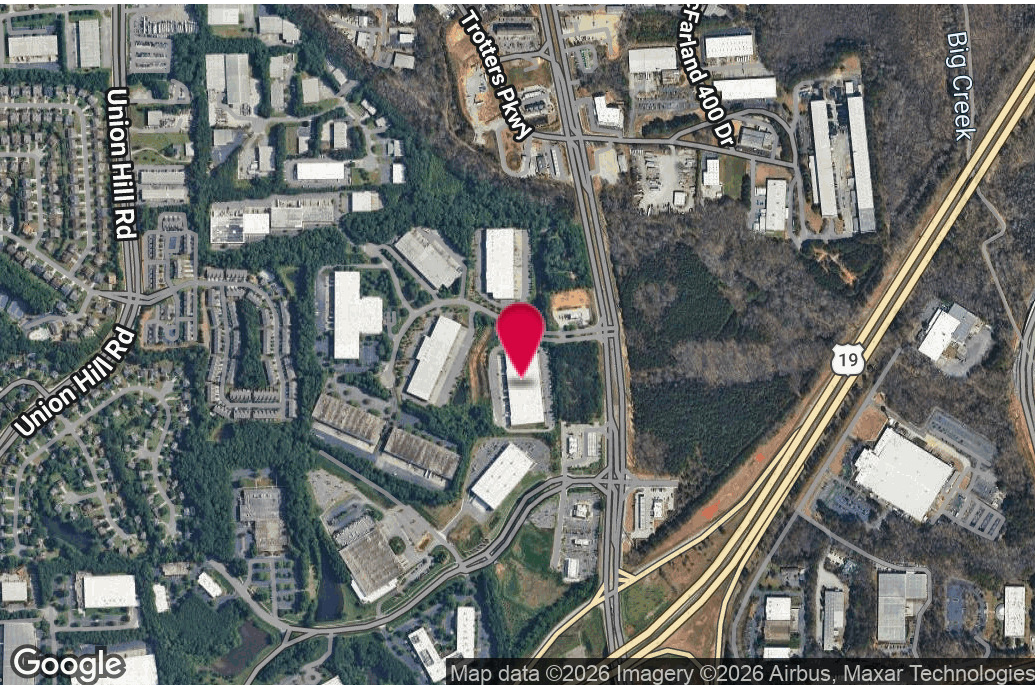

PROPERTY HIGHLIGHTS

- 9 Private Office Spaces
- Breakroom
- Conference Room
- (4) 9'x10' Dock Doors
- (1) 12'x14' Drive-In Door
- 24' Clear Ceiling Height
- 480/277 Volts, 200 Amps, 3 Phase Power
- Sublease Expires 9/30/2029

OFFERING SUMMARY

Building Size:	98,297 SF
Zoning:	M1

CARSON HAWKS

Associate
770.312.0267
chawks@kingindustrial.com

SIM DOUGHTIE, CCIM, SIOR, MCR, SLCR

President
404.942.2002
sdoughtie@kingindustrial.com

RANDALL GOLDSTEIN GORDON BROTHERS

Senior Director
617.733.8575
rgoldstein@gordonbrothers.com

Co-Listed With



Industrial • Commercial • Investment
404.942.2000 | kingindustrial.com

OFFICE PHOTOS



CARSON HAWKS

Associate
770.312.0267
chawks@kingindustrial.com

SIM DOUGHTIE, CCIM, SIOR, MCR, SLCR

President
404.942.2002
sdoughtie@kingindustrial.com

RANDALL GOLDSTEIN GORDON BROTHERS

Senior Director
617.733.8575
rgoldstein@gordonbrothers.com

Co-Listed With



Industrial • Commercial • Investment
404.942.2000 | kingindustrial.com

Every effort has been made to provide accurate information, but no liability is assumed for errors or omissions.

WAREHOUSE PHOTOS



CARSON HAWKS

Associate
770.312.0267
chawks@kingindustrial.com

SIM DOUGHTIE, CCIM, SIOR, MCR, SLCR

President
404.942.2002
sdoughtie@kingindustrial.com

**RANDALL GOLDSTEIN
GORDON BROTHERS**

Senior Director
617.733.8575
rgoldstein@gordonbrothers.com

Co-Listed With



Industrial • Commercial • Investment
404.942.2000 | kingindustrial.com

FLOOR PLAN

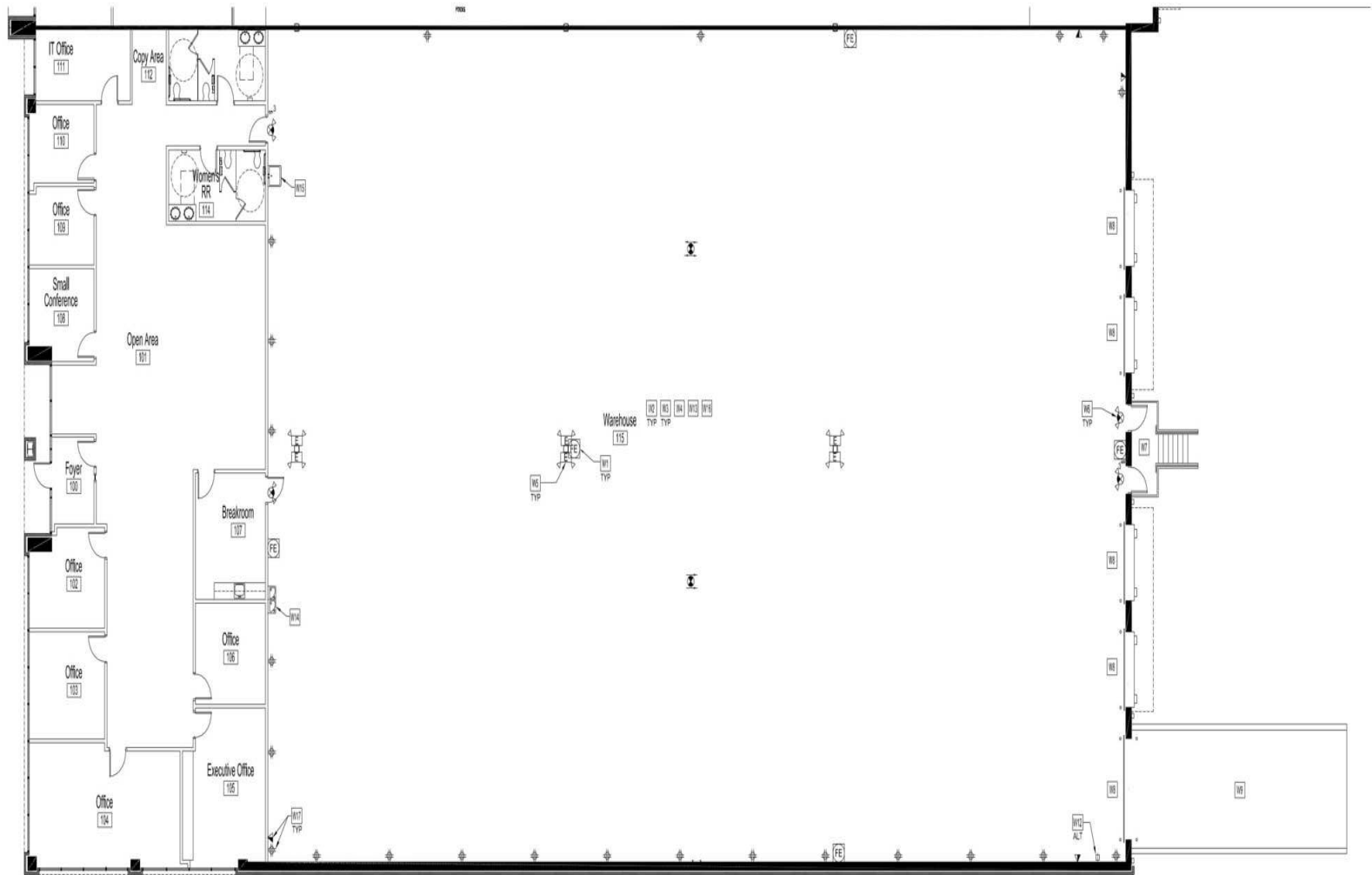

CARSON HAWKS

Associate
770.312.0267
chawks@kingindustrial.com

SIM DOUGHTIE, CCIM, SIOR, MCR, SLCR

President
404.942.2002
sdoughtie@kingindustrial.com

RANDALL GOLDSTEIN GORDON BROTHERS

Senior Director
617.733.8575
rgoldstein@gordonbrothers.com

Co-Listed With



Industrial • Commercial • Investment
404.942.2000 | kingindustrial.com

LOCATION MAP

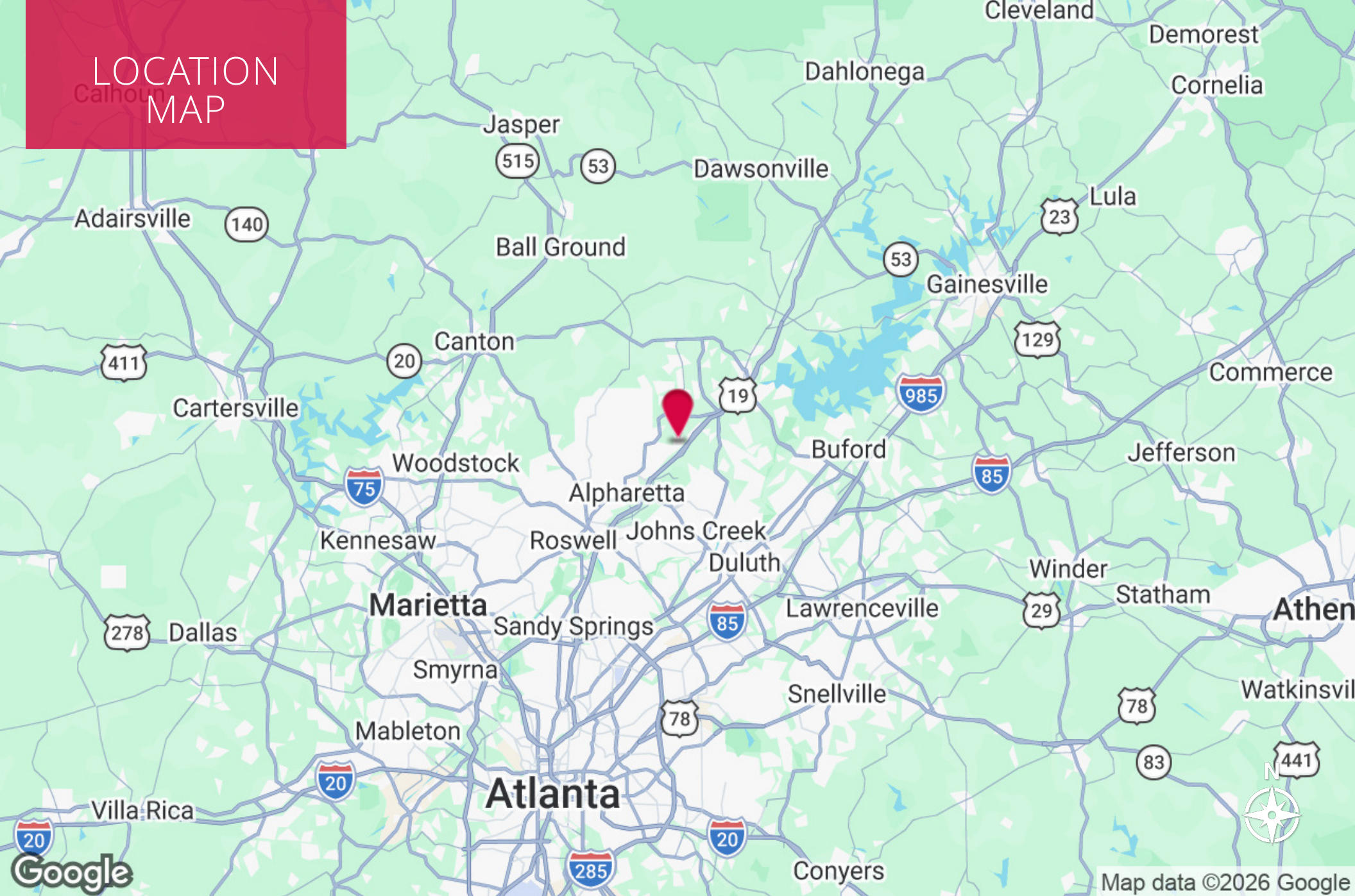

CARSON HAWKS

Associate
770.312.0267
chawks@kingindustrial.com

SIM DOUGHTIE, CCIM, SIOR, MCR, SLCR

President
404.942.2002
sdoughtie@kingindustrial.com

**RANDALL GOLDSTEIN
GORDON BROTHERS**

Senior Director
617.733.8575
rgoldstein@gordonbrothers.com

Co-Listed With



Industrial • Commercial • Investment
404.942.2000 | kingindustrial.com

Every effort has been made to provide accurate information, but no liability is assumed for errors or omissions.

EXCLUSIVELY LISTED BY:

CARSON HAWKS

Associate

chawks@kingindustrial.com

770.312.0267

SIM DOUGHTIE, CCIM, SIOR, MCR, SLCR

President

sdoughtie@kingindustrial.com

404.942.2002

RANDALL GOLDSTEIN

GORDON BROTHERS

Senior Director

rgoldstein@gordonbrothers.com

617.733.8575

King Industrial
Realty, Inc.

Industrial • Commercial • Investment

404.942.2000 | kingindustrial.com