

FOR SALE

107 P RICKMAN INDUSTRIAL DRIVE, CANTON, GA 30115



PROPERTY INFORMATION

- ±9,000 SF Industrial Warehouse Building
- ±1,600 SF Office
- ±7,400 SF Warehouse
- Two (2) Drive-In Doors
- One (1) Dock-High Door
- Heavy Power
- Gated Lot
- Located in Rickman Industrial Park
- ±0.2 mi to Holly Springs Pkwy
- ±1.3 mi to I-575, Exit 14 (Holly Springs Pkwy)
- ±2.7 mi to I-575, Exit 11 (Sixes Rd)

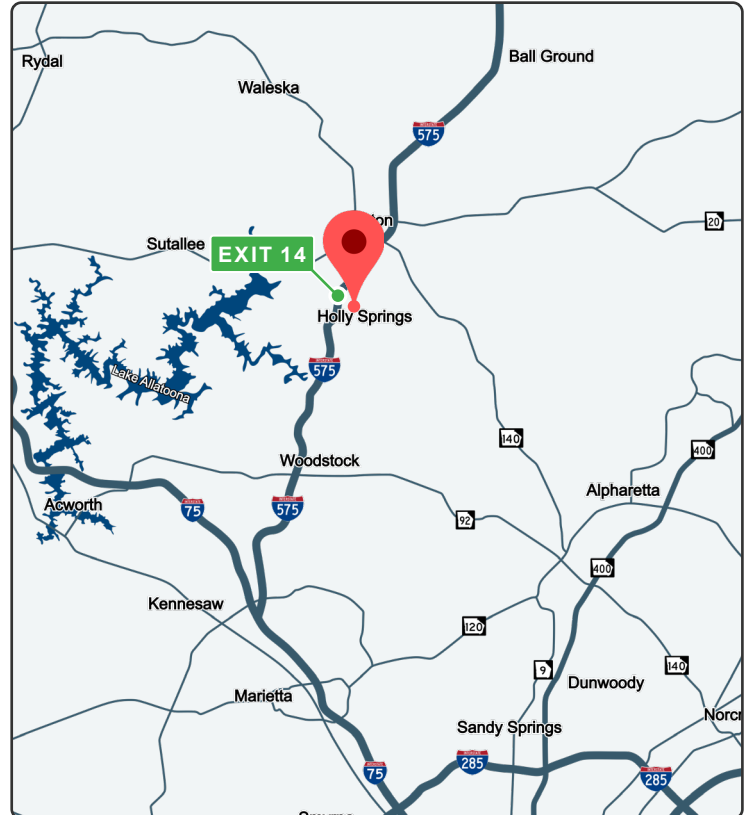

All information contained herein is believed to be accurate but is not warranted. This offer is subject to errors, omissions, prior sale or withdrawal.



Hughes Commercial Real Estate, Inc.
8215 Roswell Road, Building 700
Atlanta, GA 30350
770-559-1099 | hughes-cre.com

Cade McDonald
404-307-5166
cade@hughes-cre.com

James Hicks
404-304-2386
james@hughes-cre.com

FOR SALE

107 P RICKMAN INDUSTRIAL DRIVE, CANTON, GA 30115

AERIAL VIEW



FLOOR PLAN

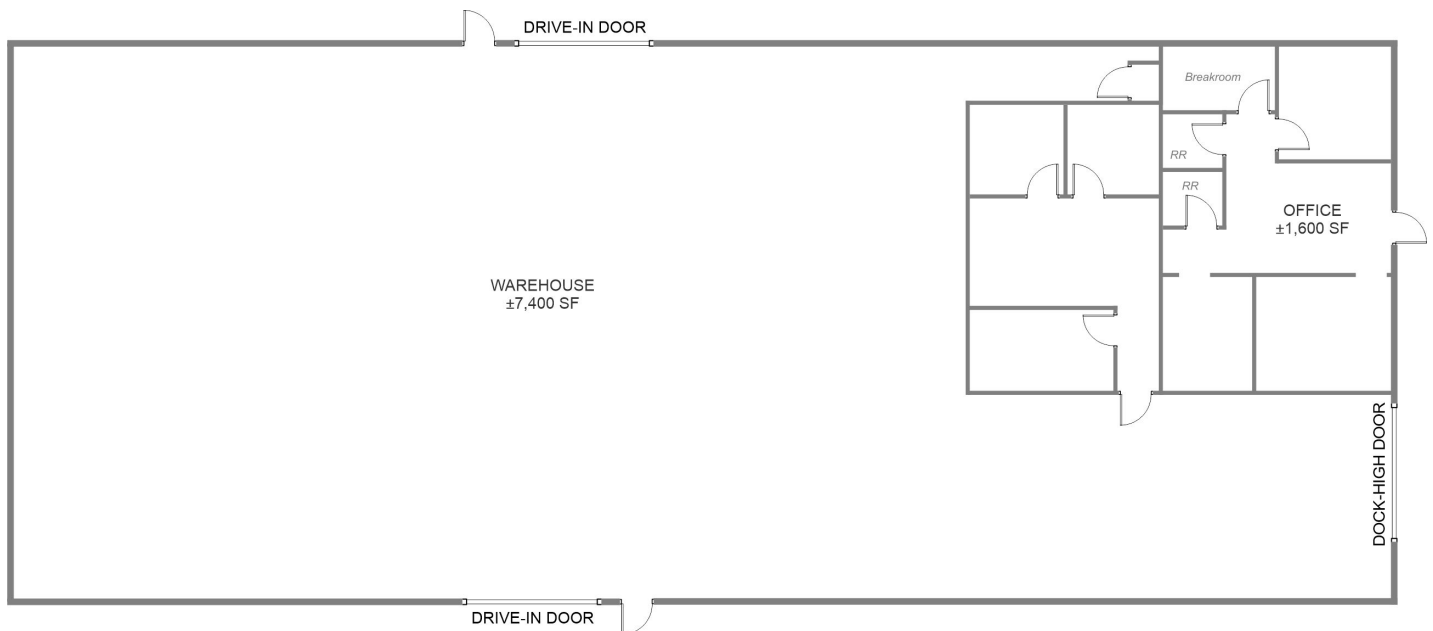

All information contained herein is believed to be accurate but is not warranted. This offer is subject to errors, omissions, prior sale or withdrawal.



Hughes Commercial Real Estate, Inc.
8215 Roswell Road, Building 700
Atlanta, GA 30350
770-559-1099 | hughes-cre.com

Cade McDonald
404-307-5166
cade@hughes-cre.com

James Hicks
404-304-2386
james@hughes-cre.com

FOR SALE

107 P RICKMAN INDUSTRIAL DRIVE, CANTON, GA 30115



All information contained herein is believed to be accurate but is not warranted. This offer is subject to errors, omissions, prior sale or withdrawal.



Hughes Commercial Real Estate, Inc.
8215 Roswell Road, Building 700
Atlanta, GA 30350
770-559-1099 | hughes-cre.com

Cade McDonald
404-307-5166
cade@hughes-cre.com

James Hicks
404-304-2386
james@hughes-cre.com