

# MISSION CORPORATE CENTER

521 E MAITLAND ST & 598 MISSION BLVD, ONTARIO, CA



**AVAILABLE FOR LEASE**  
**TWO STATE-OF-THE-ART BUILDINGS**  
**±33,904 SF & ±43,919 SF**

**Voit**  
REAL ESTATE SERVICES









**RYAN LAL, SIOR**  
Senior Vice President, Partner  
(909) 545-8020 | rlal@voitco.com  
License: 01854104

**DANTE BORRUSO**  
Vice President, Partner  
(909) 545-8021 | dborruso@voitco.com  
License: 02086368

**ALERE** 



## PROPERTY HIGHLIGHTS

	521 E Maitland St Building 1	598 Mission Blvd Building 2
 Building SF	±43,919	±33,904
 Office SF	±2,553 (SWC)	±2,900 (NEC)
 Clear Height	32'	32'
 Dock High Door(s)	6 (9' x 10')	4 (9' x 10')
 Ground Level Door(s)	1 (12' x 14')	1 (12' x 14')
 Mechanical Dock Levelers	At Every Door w/ 35,000 lbs Capacity	At Every Door w/ 35,000 lbs Capacity
 Power	2,000 Amp UGPS	2,000 Amp UGPS
 Air Change	1 Per Hour	1 Per Hour



7" Warehouse Slab



ESFR Sprinkler System (K25, 50psi)



LED Lighting | 3% Skylights



Fully Secured Concrete Truck Courts



Close Proximity to the 60, 15 and 10 Freeways

# SOUTH ONTARIO'S PREMIER INDUSTRIAL BUSINESS PARK



FREEWAYS		AIRPORTS	
I-10 Freeway	3 Mi	Ontario Intl'	3 Mi
215 Freeway	20.8 Mi	San Bernardino Intl'	26.1 Mi
I-15 Freeway	6.5 Mi	John Wayne	35.2 Mi
210 Freeway	6.1 Mi	Los Angeles Intl'	53.4 Mi

INTERMODAL / PORTS	
Union Pacific Intermodal Yard	15.9 Miles
BNSF Intermodal Yard	21.7 Miles
Port of Long Beach	54.6 Miles
Port of Los Angeles	55.9 Miles

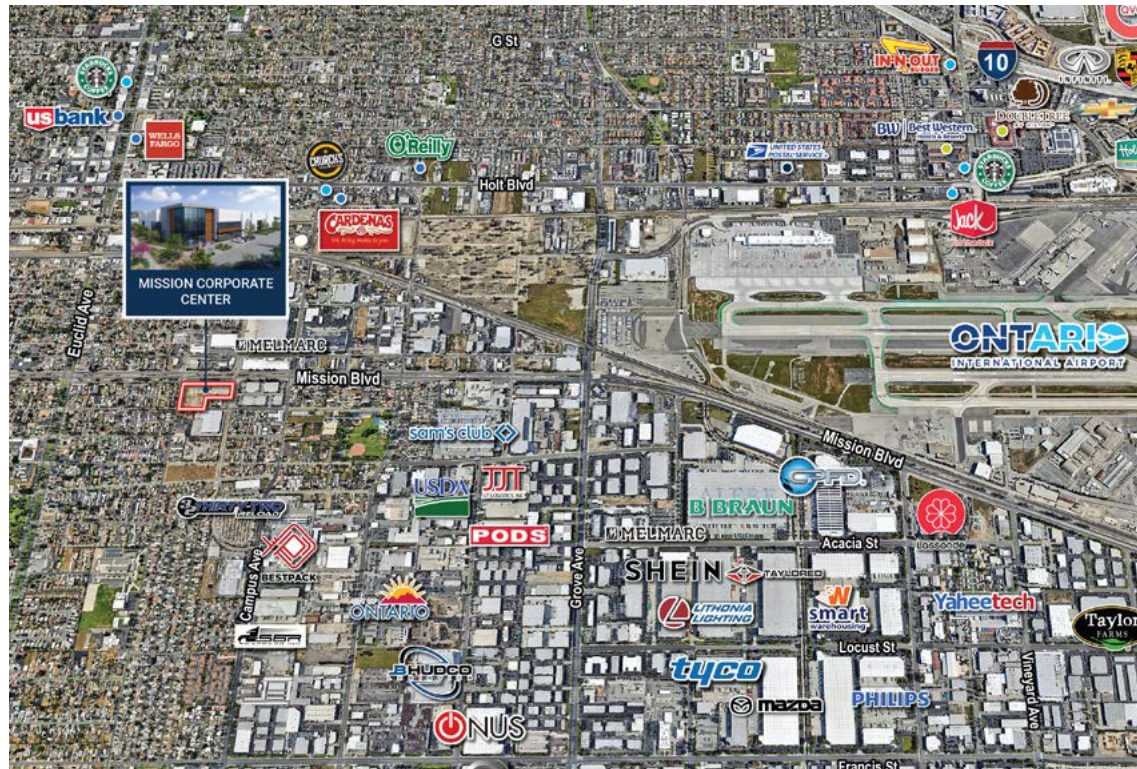

## NOTABLE TENANTS IN THE SUBMARKET

South Ontario is a high-demand industrial submarket anchored by its proximity to Ontario International Airport and immediate access to the I-10, I-15, and SR-60 freeways.

The area continues to attract leading logistics, e-commerce, and manufacturing users seeking efficient distribution to Southern California's dense population base, supported by a strong labor pool and competitive operating costs.

Notable tenants in the submarket include:



## SITE PLAN



Number of Buildings

2



Building Sizes  
 $\pm 33,904$  to  
 $\pm 43,919$



Clear Height  
32'



Office SF  
 $\pm 5,453$











Dock High Door(s)  
10



Ground Level Door(s)  
2



# 521 E Maitland St Building 1

	Building SF	±43,919
	Office SF	±2,553 (SWC)
	Clear Height	32'
	Dock High Door(s)	6 (9' x 10')
	Ground Level Door(s)	1 (12' x 14')
	Mechanical Dock Levelers	At Every Door w/ 35,000 lbs Capacity
	Power	2,000 Amp UGPS
	Air Change	1 Per Hour



7" Warehouse Slab



ESFR Sprinkler System (K25, 50psi)



LED Lighting | 3% Skylights



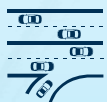

Fully Secured Concrete Truck Courts



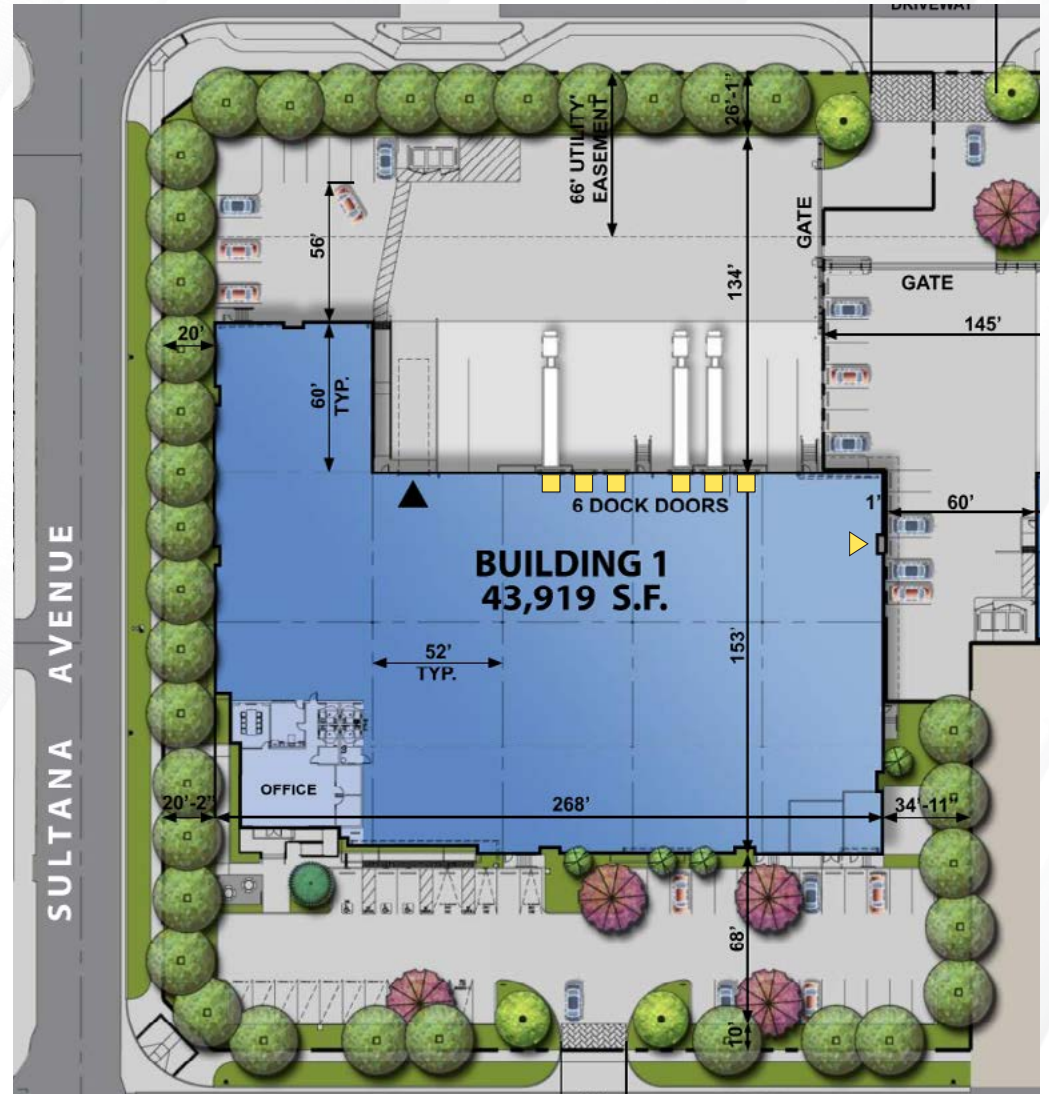







Close Proximity to the 60, 15 and 10 Freeways



-  Dock Doors
-  Grade Level Doors
-  Office



# 598 Mission Blvd Building 2

	Building SF	±33,904
	Office SF	±2,900 (NEC)
	Clear Height	32'
	Dock High Door(s)	4 (9' x 10')
	Ground Level Door(s)	1 (12' x 14')
	Mechanical Dock Levelers	At Every Door w/ 35,000 lbs Capacity
	Power	2,000 Amp UGPS
	Air Change	1 Per Hour



7" Warehouse Slab



ESFR Sprinkler System (K25, 50psi)



LED Lighting | 3% Skylights



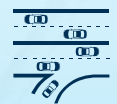

Fully Secured Concrete Truck Courts

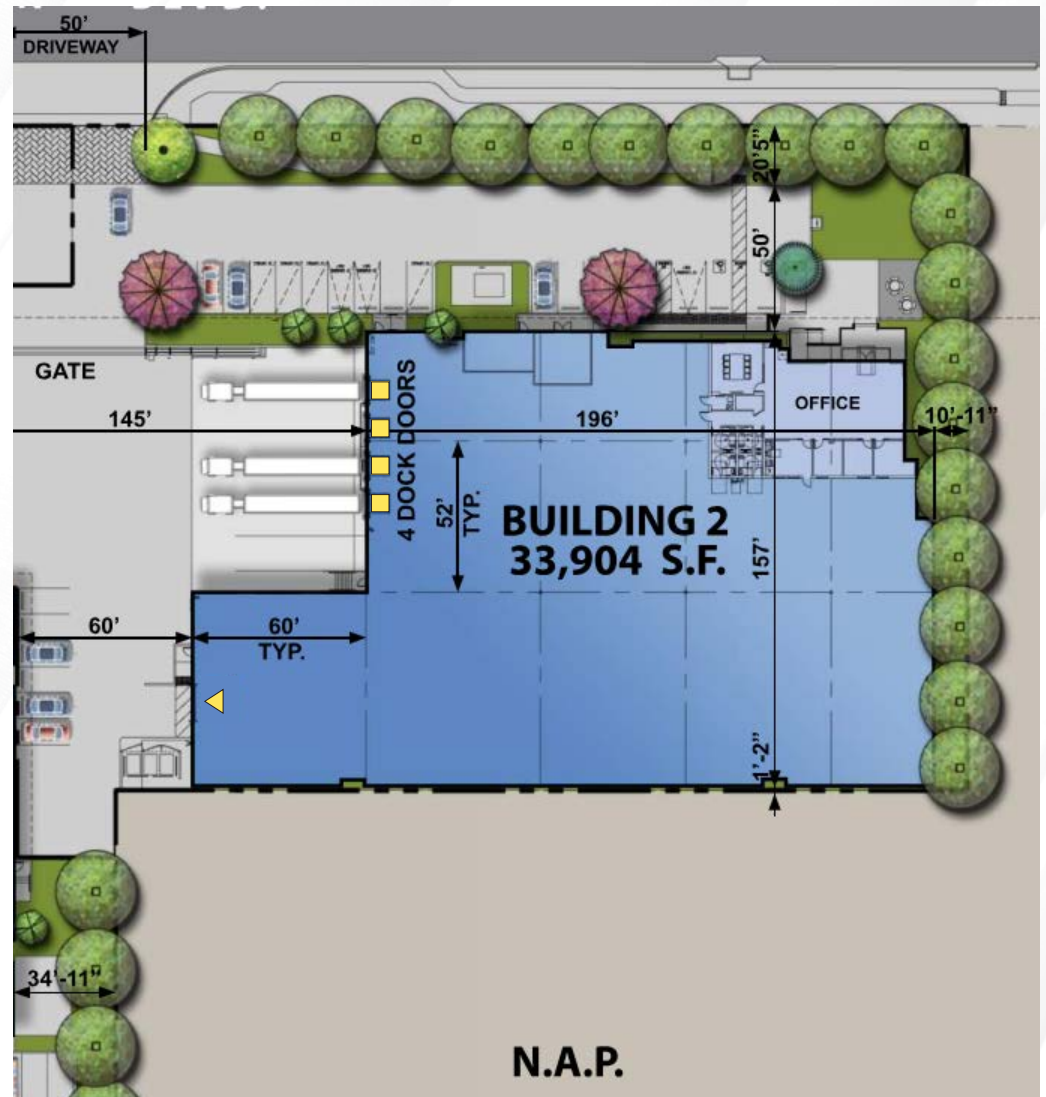

Close Proximity to the 60, 15 and 10 Freeways

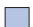

-  Dock Doors
-  Grade Level Doors
-  Office



# MISSION CORPORATE CENTER

521 E MAITLAND ST & 598 MISSION BLVD, ONTARIO, CA



**RYAN LAL, SIOR**

Senior Vice President, Partner  
(909) 545-8020 | [rlal@voitco.com](mailto:rlal@voitco.com)  
License: 01854104

3280 E. Guasti Rd. Suite 100, Ontario, CA 91761 | 909.545.8000

**DANTE BORRUSO**

Vice President, Partner  
(909) 545-8021 | [dborruso@voitco.com](mailto:dborruso@voitco.com)  
License: 02086368

[www.voitco.com](http://www.voitco.com)

**Voit**  
REAL ESTATE SERVICES

**ALERE** 

Licensed as Real Estate Salespersons by the DRE. The information contained herein has been obtained from sources we deem reliable. While we have no reason to doubt its accuracy, we do not guarantee it. ©2026 Voit Real Estate Services, Inc. All Rights Reserved.