

# 8150 LARK BROWN ROAD

8150 Lark Brown Road  
Elkridge, Maryland 21075 | Howard County



CLICK HERE FOR  
PROPERTY TOUR



## FOR LEASE

### NEARBY AMENITIES

STANFORD  
GRILL



Olive  
Garden

OLD LINE

ROYAL TAJ



### PROPERTY INFORMATION

- **Building Size:** 7,200 square feet
- **Lot Size:** 0.44 acres
- **Year Built:** 1986
- **Construction Type:** Masonry
- **Stories:** One
- **Ceiling Height:** 22'
- **Sprinkler System:** Dry system
- **Loading Docks:** 2 dock height; 1 drive-in
- **Electrical Service:** 200 amps
- **Heat:** Gas-fired unit heaters
- **Roof:** Insulated metal deck

Abby Glassberg  
aglassberg@klnb.com  
443-574-1433

Aaron Carroll  
acarroll@klnb.com  
202-652-2333

9881 Broken Land Pkwy, Suite 300  
Columbia, MD 21046  
klnb.com

NAI klnb

# 8150 LARK BROWN ROAD

8150 Lark Brown Road  
Elkridge, Maryland 21075 | Howard County

## 3 MILE DEMOS

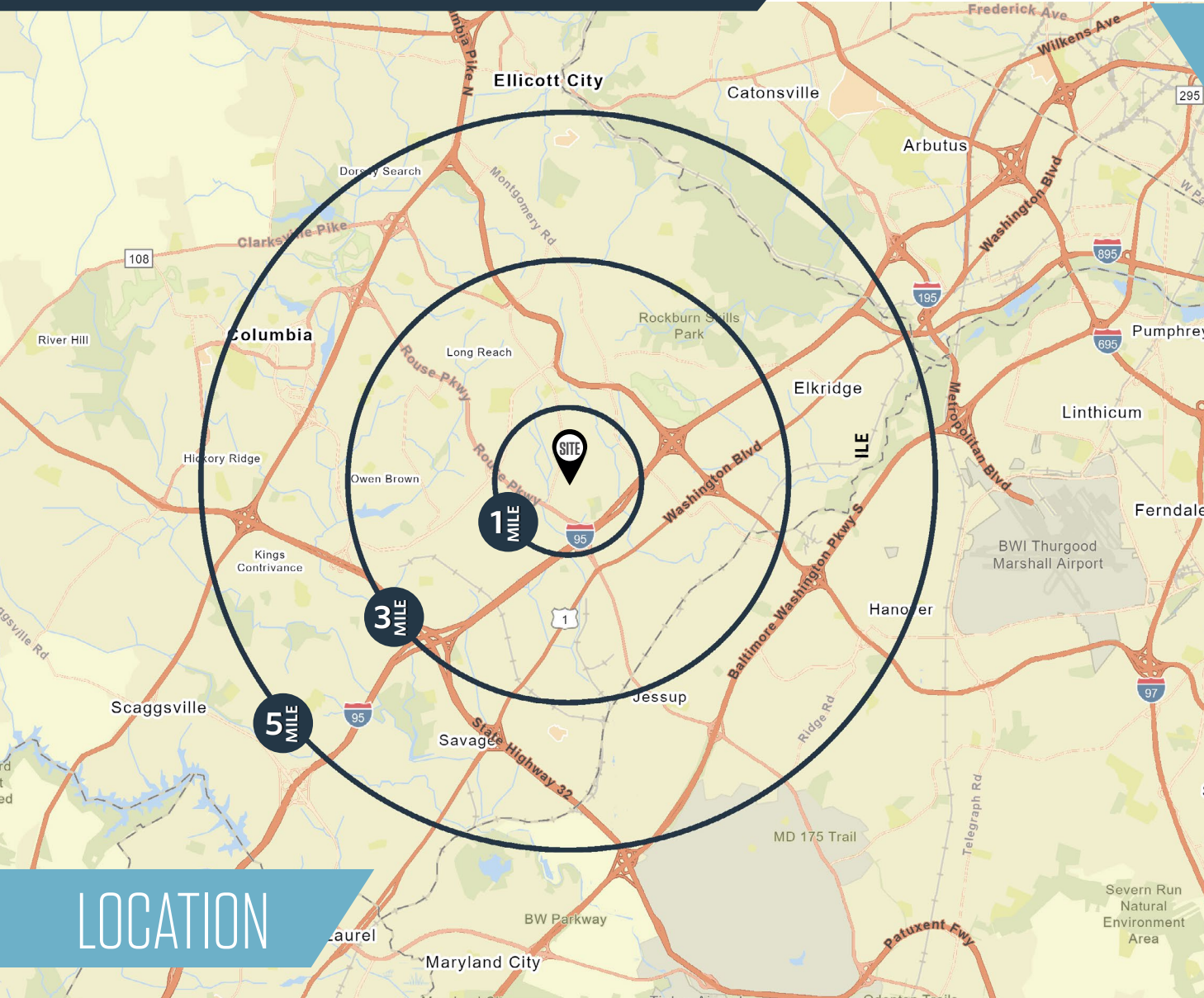

**POPULATION**  
86,526



**HOUSEHOLDS**  
31,334



**MEDIAN HH INCOME**  
\$129,190



**AVG HOUSEHOLD SIZE**  
2.60



**MEDIAN AGE**  
36.9



**DISPOSABLE INCOME**  
\$101,180

## LOCATION

**Abby Glassberg**  
aglassberg@klnb.com  
443-574-1433

**Aaron Carroll**  
acarroll@klnb.com  
202-652-2333

9881 Broken Land Pkwy, Suite 300  
Columbia, MD 21046  
klnb.com



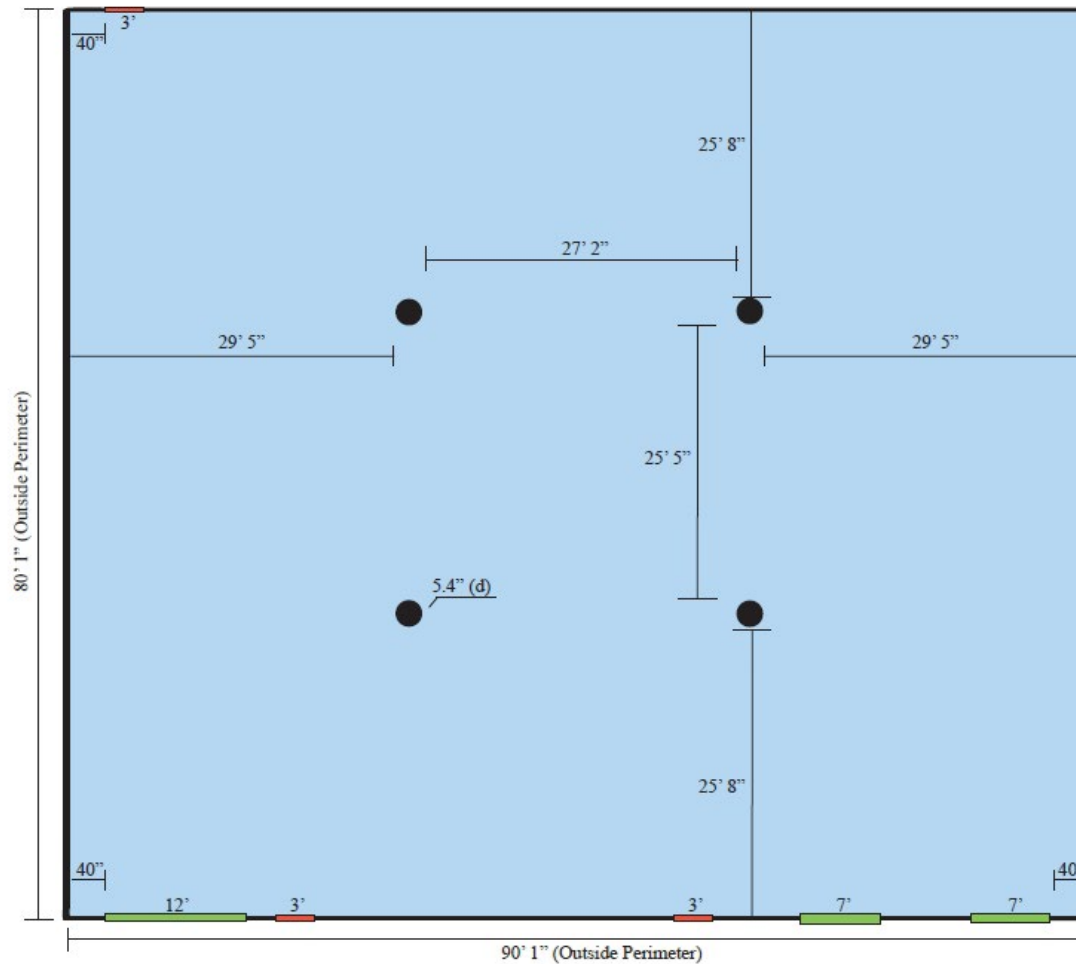

# 8150 LARK BROWN ROAD

8150 Lark Brown Road  
Elkridge, Maryland 21075 | Howard County



Scale  
1" = 10'

KEY	
	Bay Doors
	Entrance Exit
	Pillar
(d)	Diameter

## FLOOR PLAN

**Abby Glassberg**  
aglassberg@klnb.com  
443-574-1433

**Aaron Carroll**  
acarroll@klnb.com  
202-652-2333

9881 Broken Land Pkwy, Suite 300  
Columbia, MD 21046  
[klnb.com](http://klnb.com)



# 8150 LARK BROWN ROAD

8150 Lark Brown Road  
Elkridge, Maryland 21075 | Howard County



Abby Glassberg  
aglassberg@klnb.com  
443-574-1433

Aaron Carroll  
acarroll@klnb.com  
202-652-2333

9881 Broken Land Pkwy, Suite 300  
Columbia, MD 21046  
klnb.com

**NA**klnb

# 8150 LARK BROWN ROAD

8150 Lark Brown Road  
Elkridge, Maryland 21075 | Howard County

CLICK TO VIEW PROPERTY WEBSITE

For More Information, Please Contact:

**Abby Glassberg**

aglassberg@klnb.com  
443-574-1433

**Aaron Carroll**

acarroll@klnb.com  
202-652-2333

9881 Broken Land Parkway, Suite 300  
Columbia, Maryland 21046

[klnb.com](http://klnb.com)



[instagram.com/klnbcre](https://www.instagram.com/klnbcre)



[linkedin.com/company/klnb](https://www.linkedin.com/company/klnb)



[facebook.com/KLNBCRE](https://www.facebook.com/KLNBCRE)

While we have no reason to doubt the accuracy of any of the information supplied, we cannot, and do not, guarantee its accuracy. All information should be independently verified prior to a purchase or lease of the property. We are not responsible for errors, omissions, misuse, or misinterpretation of information contained herein and make no warranty of any kind, express or implied, with respect to the property or any other matters.

**NAI** klnb