

**SITE PLAN NOTES**

- REFER TO BOUNDARY SURVEY TO ESTABLISH PROPERTY LINES AND EASEMENTS
- REFER TO GEOTECHNICAL INVESTIGATION REPORT FOR PAVING SUBGRADE
- REFER TO CIVIL DRAWINGS FOR SITE GRADING/DRAINAGE AND DRIVEWAY AND DETENTION DETAILS
- ACCESSIBLE PARKING SPACES SHALL NOT EXCEED 1:50 SLOPE IN ANY DIRECTION
- ACCESSIBLE ROUTES FROM PARKING TO BUILDING SHALL NOT EXCEED 1:20 SLOPE
- NO CROSS SLOPES SHALL EXCEED 1:50 (2.0% SLOPE) OR 1/4" PER FOOT IN ANY LOCATION
- ALL SIDES OF BUILDING TO HAVE POSITIVE DRAINAGE AWAY FROM BUILDING FOUNDATION, INCLUDING FINAL LANDSCAPE COVERING.
- REFER TO CIVIL AND LANDSCAPE DRAWINGS FOR DRAINAGE DESIGN AND CONFIGURATION. CONTRACTOR TO COORDINATE CIVIL GRADING AND LANDSCAPE DESIGN TO ENSURE COMPLIANCE.
- RADIUS SYMBOLS TO BE READ AS R"x" WHERE "x" INDICATES RADIUS MEASUREMENT IN FEET
- PROVIDE T&A/ADA COMPLIANT CURB RAMP WITH 1:12 SLOPE AND DETECTABLE WARNING - 1/4"
- PROVIDE 6" ROUND, 48" HIGH CONCRETE FILLED PIPE BOLLARD, PAINTED YELLOW WHERE SHOWN (TYP.)
- PROVIDE 6" WIDE x 6' LONG CONCRETE WHEEL STOP AS SHOWN
- PROVIDE PAINTED H.C. PAINTED SYMBOL - RE:12/A0.01
- PROVIDE PAINTED STRIPED LOADING ZONE AS SHOWN - STRIPING 4" WIDE EACH AT 45 DEGREES - 12" SPACES BETWEEN STRIPES
- PROVIDE 4" WIDE PAINTED WHITE STRIPES INDICATING PARKING STALLS WHERE SHOWN
- PROVIDE ADA SIGN WHERE SHOWN

**APPLICABLE CODES:**  
 2021 International Building Code  
 2021 International Mechanical Code  
 2021 International Energy Conservation Code  
 2021 International Existing Building Code  
 2012 Texas Accessibility Standards  
 2020 National Electrical Code of the National Fire Protection Association  
 2021 International Fire Code  
 2021 International Plumbing Electrical Code

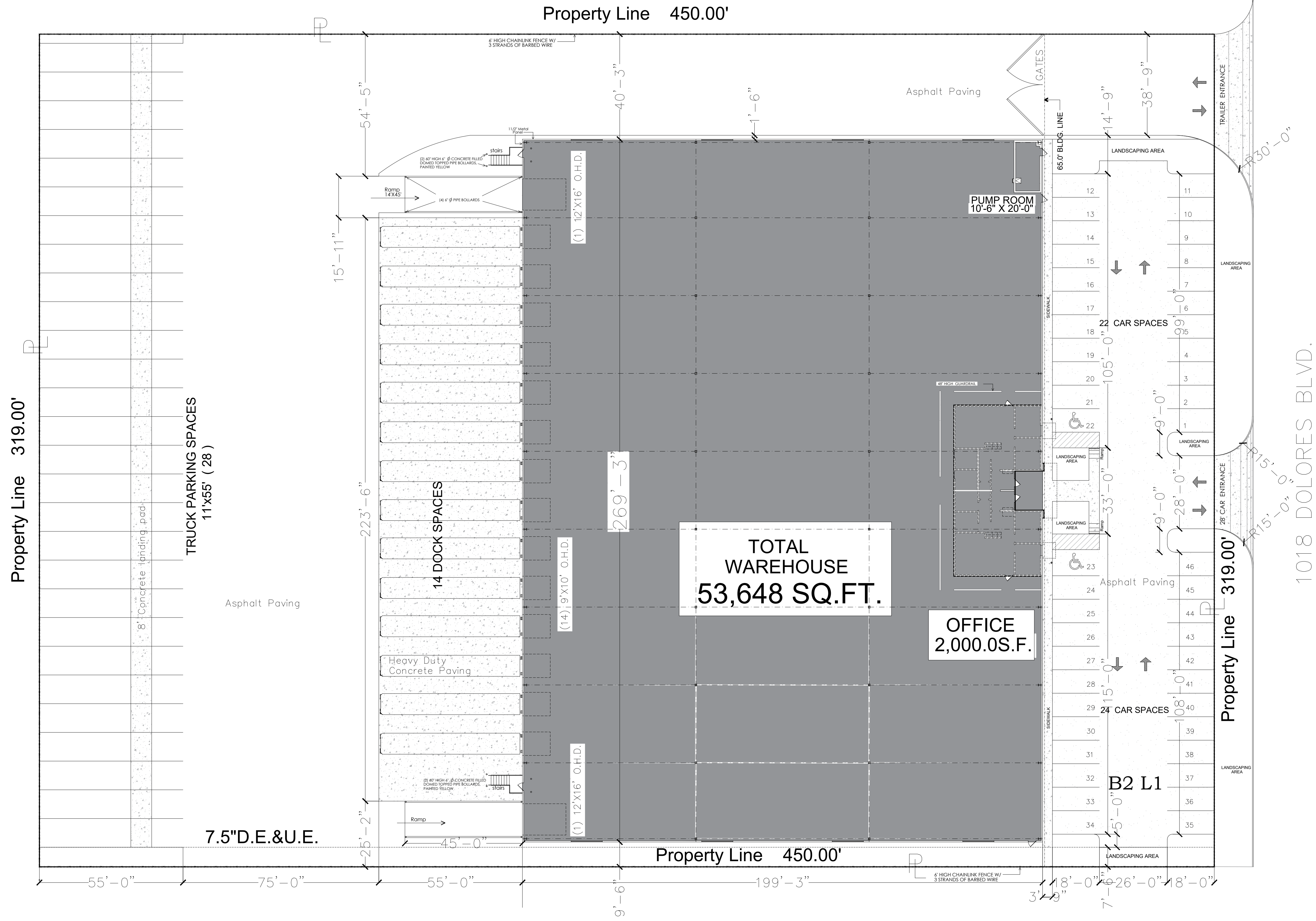

**1 SITE PLAN .-**

A01

ADDRESS: 1018 DOLORES BLVD.  
 Laredo, Tx.  
 Date: 07/25  
 Date: 02/03/25  
 Drawn by: P.D.

**SITE PLAN**

PROJECT: DOLORES BRIDGE PROPERTIES, Ltd.  
 International Commerce Center U.1  
 BLK. 2 LOT 1  
 scale: 20' = 1'-0"

6900 McPherson  
 (956) 726-1165  
 Laredo, Tx.  
 www.whiteark.com

