

TAMPA DISTRIBUTION CENTER

TAMPA
TAMPA EAST SIDE

4776 DISTRIBUTION DRIVE
TAMPA, FL 33605



FOR LEASE

BLDG 4 | SUITE 4776

+/- 3,750 SF



LEASED BY



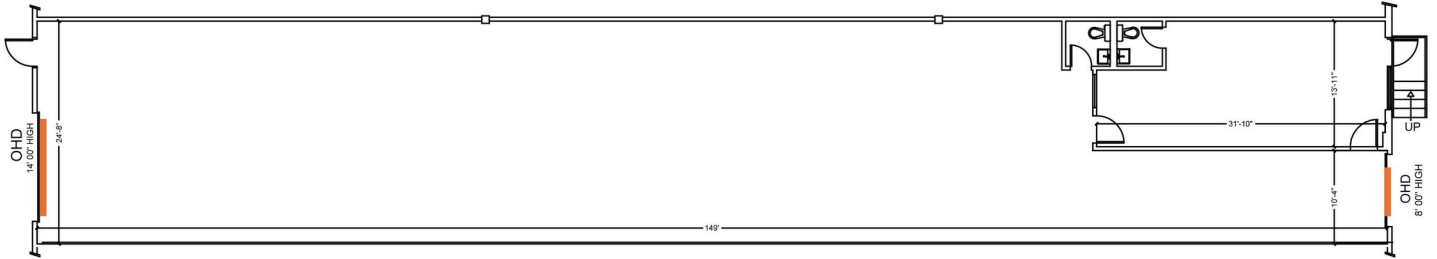

LOCATION OVERVIEW

Tampa Distribution Center, situated at 4776 Distribution Drive, Tampa, FL 33605, is an industrial property suited for warehousing and distribution users. This facility provides a solution for businesses in need of a strategically located and highly efficient distribution center within Tampa's industrial hub, offering immediate access to I-4, I-75, the Lee Roy Selmon Expressway, and Adamo Drive (SR 60).

SR 60	0.3 miles	1 minute
I-4	0.8 miles	3 minutes
U.S. Hwy. 301	2.9 miles	7 minutes
Selmon Expwy	3.0 miles	8 minutes
Port Tampa Bay	4.9 miles	12 minutes
I-75	5.5 miles	15 minutes
Tampa Int'l Airport	10.5 miles	32 minutes

BLDG 4 | SUITE 4776

TOTAL SF	+ 3,750
OFFICE SF	± 403
OCCUPANCY	Available August 1, 2026
CLEAR HEIGHT	20'
LOADING	1 Dock-High Door w/ Edge of Dock; 1 Grade Level Door
POWER	3 Phase, 4 Wire 120-208v, 200a
SPRINKLERS	Wet Pipe

CONTACT INFORMATION

4776 DISTRIBUTION DRIVE
TAMPA, FL 33605

Sam Korolos

sam.korolos@cushwake.com
(704) 989 1327

Lisa Ross, SIOR

lisa.ross@cushwake.com
(813) 760 3209

Melissa Watterworth

melissa.watterworth@cushwake.com
(813) 599 2190

Trey Carswell, SIOR

trey.carswell@cushwake.com
(813) 230 6131

This document is for informational purposes only and does not constitute an offer or acceptance of a lease. Any lease agreement must be in writing and signed by the landlord. No representations or warranties are made except as expressly stated in a signed lease. Information is provided "as is" and may be subject to errors or change without notice.



LEASED BY

