

# 262 WEST 38TH STREET

As exclusive agents for the building we are pleased to present

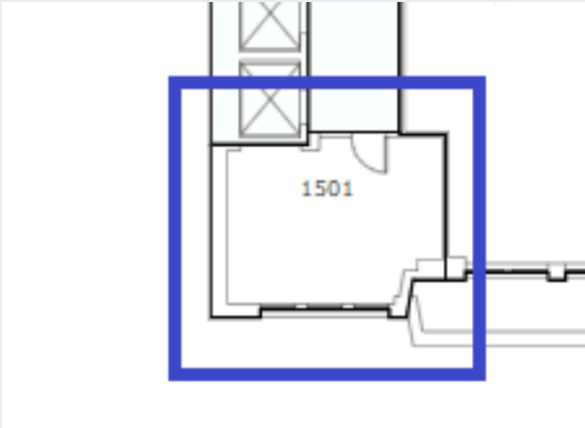

SUITE: 1501  
SIZE: 499 RSF  
ASKING RENT: Inquire  
LAYOUT: Open



## PROPERTY OVERVIEW



## ABOUT THIS PROPERTY

- Shared conference room for all tenants
- Common kitchen with breakout area
- Pilot high-speed internet
- 10' ceilings

## FEATURES

- ✓ Attended lobby (business hours) with 24/7 keycard access
- ✓ 2 passenger and 2 freight elevators
- ✓ Flexible lease term and sizes
- ✓ Newly renovated spaces and hallways

## CONTACT DETAILS

LEASING AGENTS:

Joshua Winslow

☎ 917-450-4538

✉ josh@way2winnyc.com

Philippe Lesbre

☎ 646-610-0373

✉ philippe@way2winnyc.com

OWNERSHIP:

Silver Eight Capital

✉ info@silvereightcapital.com