

# 1000 WILSON BLVD 10TH FLOOR

Arlington, VA 22209

## Office For Sublease

2,583 SF



Leasing Information:  
202.513.6700

**Alexander Cholet**  
202.513.6716  
acholet@lpc.com

**John Olson**  
202.513.6730  
jeolson@lpc.com

## Lincoln

101 Constitution Avenue NW  
Suite 325 East  
Washington, DC 20001

[www.lpc.com](http://www.lpc.com)

# 1000 WILSON BLVD | 10TH FLOOR

Arlington, VA 22209

Office For Sublease

2,583 SF



Availabilities	SF	Lease Rate	Date Available
10th Floor	2,583 SF	\$48.00 FS	November 1, 2026

## Property Highlights

- Trophy Rosslyn office tower ideal for headquarters, professional services, consulting, legal, technology, or government contracting users seeking a highly connected Northern Virginia location
- On-site fitness center and conference facilities
- Rooftop terrace and courtyard amenities
- Walkable to Rosslyn Metro Station
- Food service and retail amenities nearby
- Immediate access to I-66, Route 50, and GW Parkway
- Covered parking available

**Alexander Cholet**

202.513.6716  
acholet@lpc.com

**John Olson**

202.513.6730  
jeolson@lpc.com

**Lincoln**

# 1000 WILSON BLVD | 10TH FLOOR

Arlington, VA 22209

## Conference Facility



**Alexander Cholet**

202.513.6716  
acholet@lpc.com

**John Olson**

202.513.6730  
jeolson@lpc.com

**Lincoln**

# 1000 WILSON BLVD | 10TH FLOOR

Arlington, VA 22209

## Rooftop Terrace



**Alexander Cholet**

202.513.6716  
acholet@lpc.com

**John Olson**

202.513.6730  
jeolson@lpc.com

**Lincoln**

# 1000 WILSON BLVD | 10TH FLOOR

Arlington, VA 22209

## Fitness Center



Alexander Cholet

202.513.6716  
acholet@lpc.com

John Olson

202.513.6730  
jeolson@lpc.com

# Lincoln

# 1000 WILSON BLVD | 10TH FLOOR

Arlington, VA 22209

10th Floor

2,583 SF

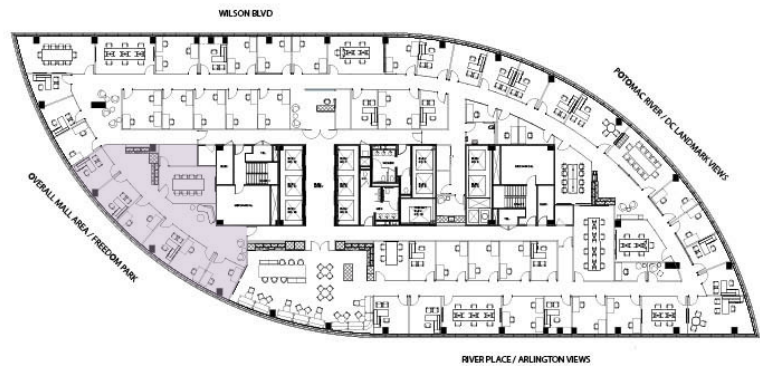
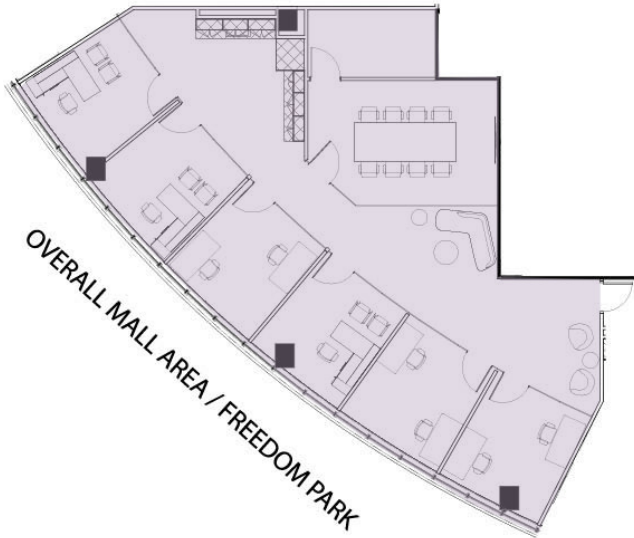

Suite	Size	Lease Rate	Description
■ 10th Floor	2,583 SF	\$48.00 FS	Brand-new built out office available November 1, 2026 for a two to three year term. Space features a small reception area, six windowed offices, conference room, galley kitchen/pantry with copy and workroom area.

Alexander Cholet

202.513.6716  
acholet@lpc.com

John Olson

202.513.6730  
jeolson@lpc.com

Lincoln

# 1000 WILSON BLVD | 10TH FLOOR

Arlington, VA 22209

# 10th Floor Renderings



**Alexander Cholet**    **John Olson**  
202.513.6716            202.513.6730  
acholet@lpc.com        jeolson@lpc.com



# 1000 WILSON BLVD | 10TH FLOOR

Arlington, VA 22209

## Location Map



Alexander Cholet

202.513.6716  
acholet@lpc.com

John Olson

202.513.6730  
jeolson@lpc.com

# Lincoln

# 1000 WILSON BLVD 10TH FLOOR

Arlington, VA 22209

## Alexander Cholet

202.513.6716

[acholet@lpc.com](mailto:acholet@lpc.com)

## John Olson

202.513.6730

[jeolson@lpc.com](mailto:jeolson@lpc.com)

101 Constitution Avenue NW  
Suite 325 East  
Washington, DC 20001  
[www.lpc.com](http://www.lpc.com) | 202.513.6700

# Lincoln

The information contained herein has been obtained through sources deemed reliable but neither Owner nor Lincoln Property Company makes guarantees, warranties or representations to its completeness or accuracy.

