

**AVAILABLE FOR SUBLEASE**  
**1816 UNDERWOOD BLVD**  
**DELRAN, NEW JERSEY**



**34,722± SF WAREHOUSE BUILDING**

**FENCED LOT w/ TRAILER PARKING**

**IOS**

**OUTSIDE  
STORAGE  
PERMITTED**

**CONTACT**

**SCOTT MERTZ, SIOR**

+1 609 413 5647

scott.mertz@naimertz.com

**NAIMertz**

# PROPERTY DETAILS

1816 UNDERWOOD BLVD DELRAN, NJ



**34,722±  
SQ. FEET**



**UP TO 20'6"  
CLEAR**



**5 TAILGATES  
2 DRIVE-INS**

BUILDING SIZE	34,722± SF	COLUMN SPACING	50' x 30'
ACREAGE	2.5± acres	POWER	1600a, 208/120v, 3P
CEILING HEIGHT	19'6" - 20'6"	OFFICE AREA	3,841 SF, air-conditioned
LOADING	(5) 8'x10' tailgates w/ levelers & shelters (2) 12'x14' drive-ins	LIGHTING	New LED lighting
		TRAILER PARKING	12 stalls



## CONTACT

**SCOTT MERTZ, SIOR**  
+1 609 413 5647  
scott.mertz@naimertz.com



# FLOORPLAN

1816 UNDERWOOD BLVD DELRAN, NJ

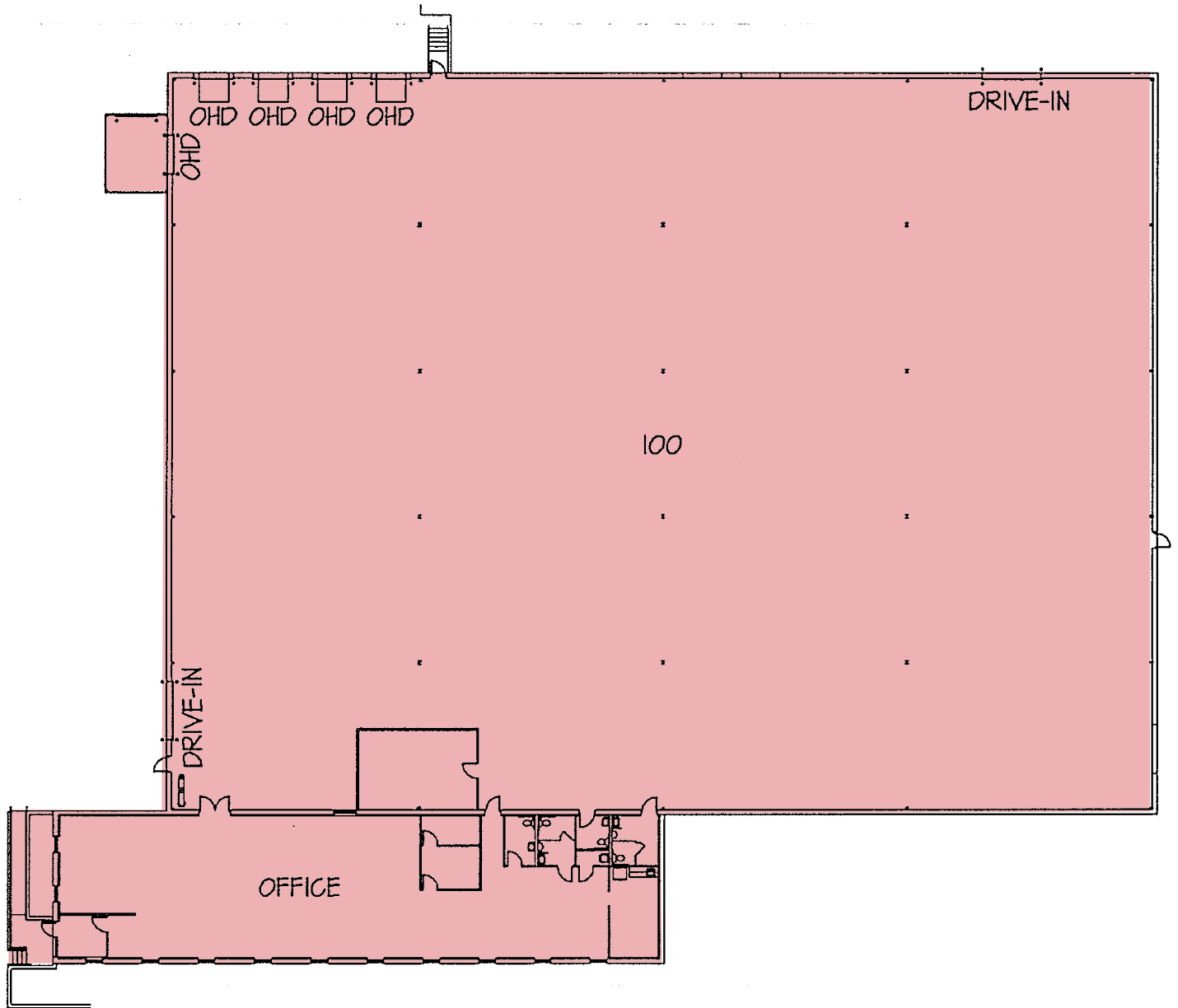

## CONTACT

SCOTT MERTZ, SIOR

+1 609 413 5647

scott.mertz@naimertz.com



## BUILDING PHOTOS

1816 UNDERWOOD BLVD DELRAN, NJ



### CONTACT

SCOTT MERTZ, SIOR

+1 609 413 5647

scott.mertz@naimertz.com

**NAIMertz**

# LOCATION INFORMATION

1816 UNDERWOOD BLVD DELRAN, NJ

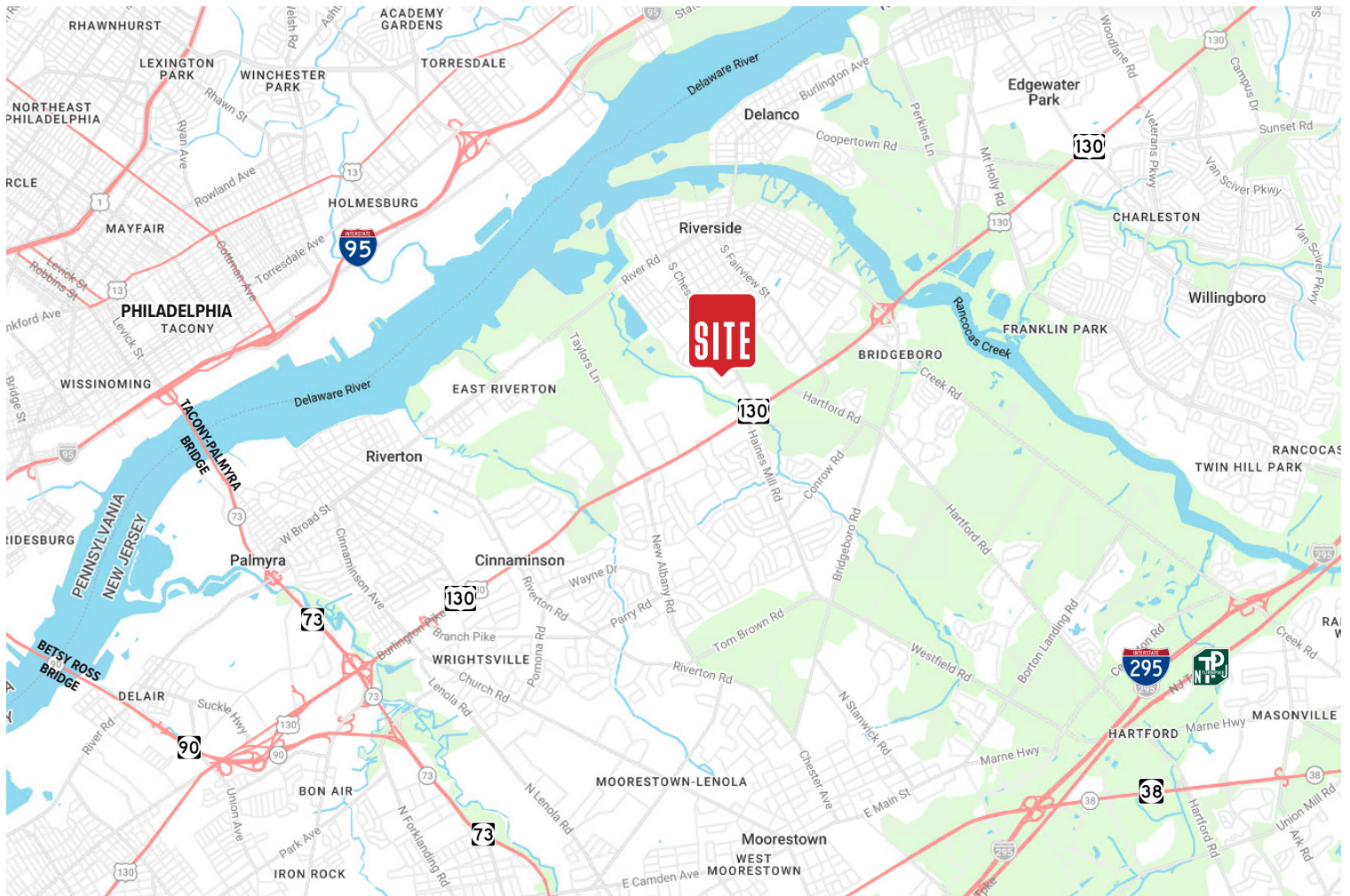

## DISTANCE TO:

Route 130	0.5 mi
Route 73	4.5 mi
I-295 (Exit 43)	5.5 mi
Tacony-Palmyra Bridge	6.5 mi
Betsy Ross Bridge	7.5 mi
NJ Turnpike (Exit 4)	10 mi
Center City Philadelphia	13 mi



## CONTACT

**SCOTT MERTZ, SIOR**  
 +1 609 413 5647  
 scott.mertz@naimertz.com

