

FOR LEASE

3,216 Square Feet

Showroom Industrial/Manufacturing Suite



6361 Yarrow Drive, Suites F Carlsbad, CA 92011

Property Features:

- ± 1,168 S. F. of HVAC Office
- ± 2,048 S. F. of 16' Clear Height Warehouse
- One 10' x 10' Grade Level Truck Door
- Natural Gas Available
- Power: 480 Volt, 3-Phase
- Great Parking and Truck Circulation
- Fire Sprinklers
- Zoned: Light Industrial
- \$.15 / Sq. Ft. CAM for Water Sewer and Landscaping

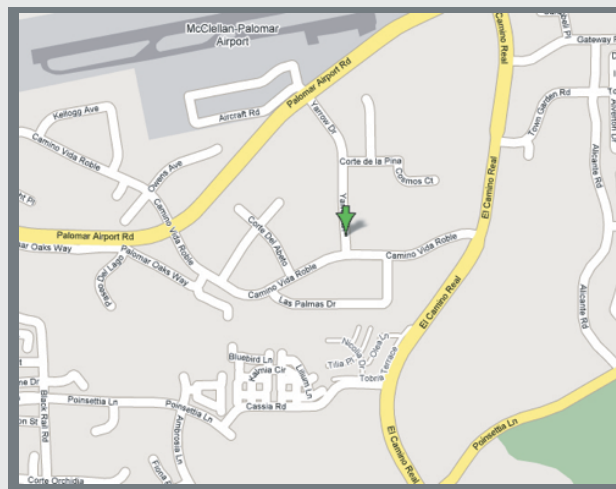

\$1.69 / Mod. Gross

For more information on this property, your current property, or your future location, please contact:

Kenneth Dubs, Jr.

CalBRE# 01277355

kdjr@dubsandcompany.com

Office (760) 591-4100 Fax (760) 591-4102

1850 Diamond Street, Suite 103, San Marcos, California 92078

The information contained herein is deemed reliable, however no representations, warranties, or guaranties of any kind are made by Dubs and Company, Inc.



CalBRE# 01385958

FOR LEASE

3,216 Square Feet

Showroom Industrial/Manufacturing Suite

6361 Yarrow Drive, Suite F, Carlsbad, CA 92011

SUITE F

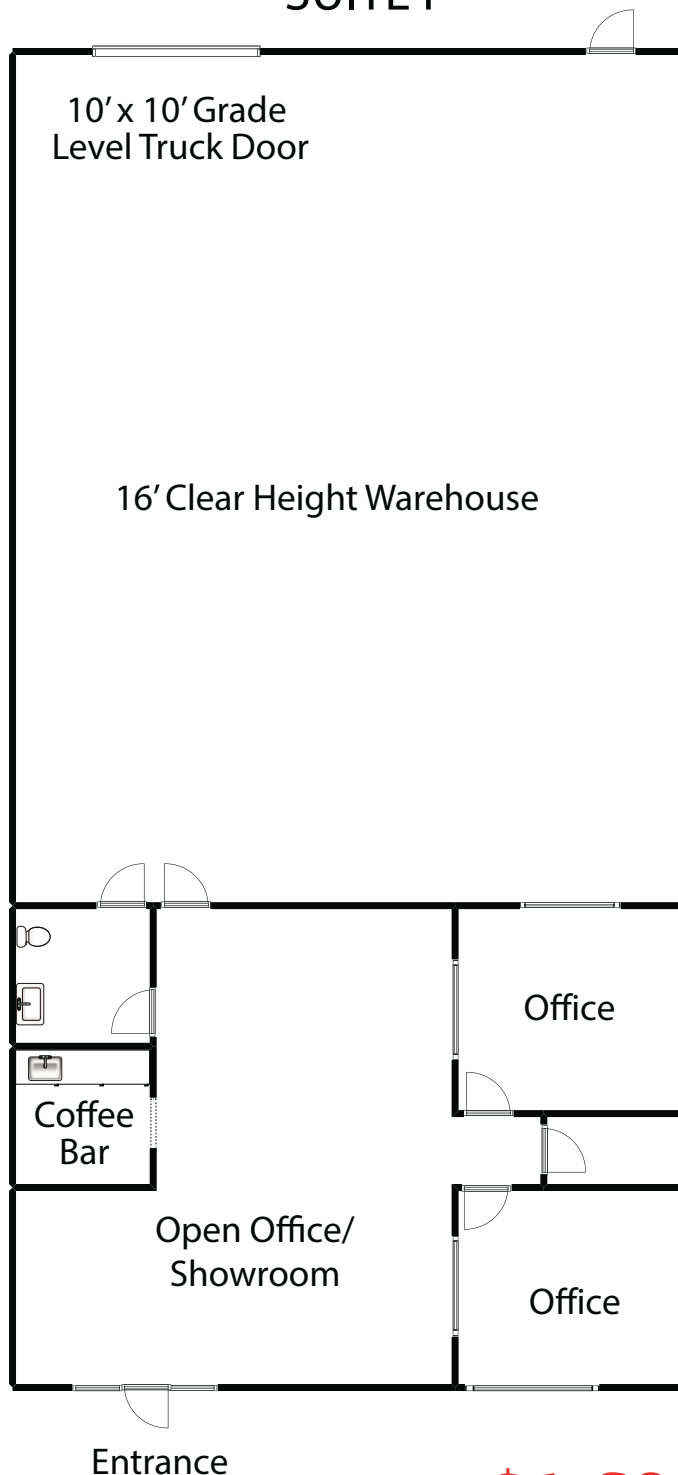

\$1.69 / Mod. Gross

For more information on this property, your current property, or your future location, please contact:

Kenneth Dubs, Jr.

CalBRE# 01277355

kdjr@dubsandcompany.com

Office (760) 591-4100 Fax (760) 591-4102

1850 Diamond Street, Suite 103, San Marcos, California 92078

