

# 1430 JOH AVENUE

1430 Joh Avenue, Baltimore, MD 21227  
Baltimore County



## OFFICE/FLEX FOR LEASE

### PROPERTY HIGHLIGHTS:

- **Suite K** - 3,000 SF available **NOW**
- 1-story
- Office/flex
- Free and unreserved parking at 3/1,000
- Attractively landscaped
- 24 hour access
- Within 5 minutes of Baltimore's CBD
- Convenient to banks, restaurants & gas stations
- Aggressively priced - \$11.25/SF NNN
- Estimated OpEx - \$4.42/SF

**Jim Caronna, SIOR**  
jcaronna@klnb.com  
443-632-2070

100 West Road, Suite 505  
Towson, MD 21204  
[klnb.com](http://klnb.com)

**NAI**klnb

# 1430 JOH AVENUE

1430 Joh Avenue, Baltimore, MD 21227  
Baltimore County

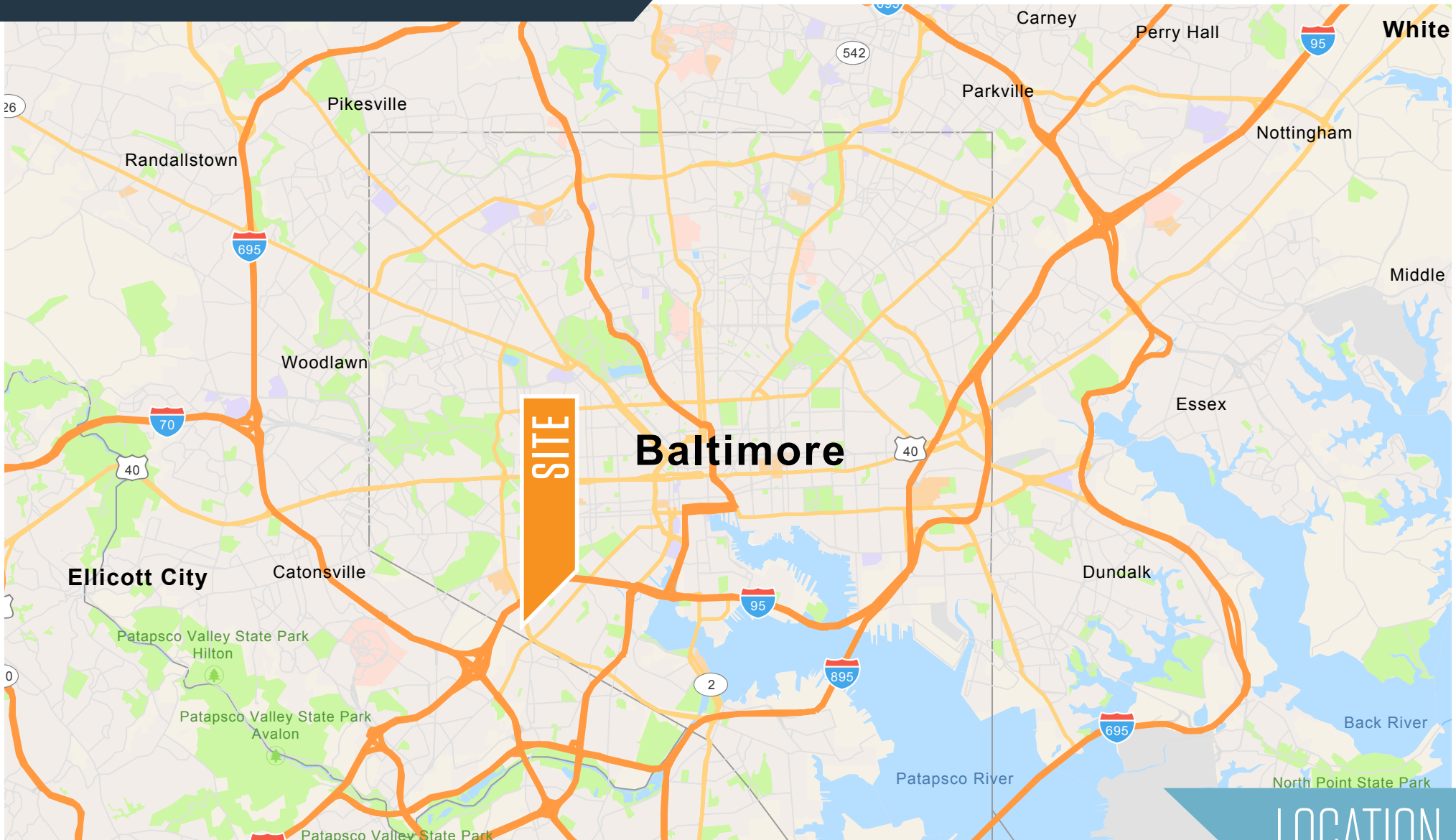

LOCATION

Jim Caronna, SIOR  
jcaronna@klnb.com  
443-632-2070

100 West Road, Suite 505  
Towson, MD 21204  
klnb.com

**NA**klnb

# 1430 JOH AVENUE

1430 Joh Avenue, Baltimore, MD 21227  
Baltimore County

Suite K - 3,000 SF

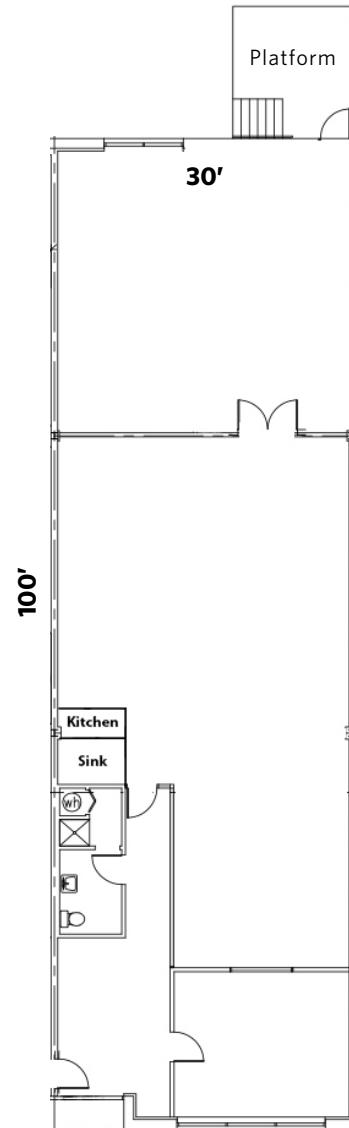

AVAILABILITIES

Jim Caronna, SIOR  
jcaronna@klnb.com  
443-632-2070

100 West Road, Suite 505  
Towson, MD 21204  
klnb.com

NAI klnb

# 1430 JOH AVENUE

1430 Joh Avenue, Baltimore, MD 21227  
Baltimore County

For More Information, Please Contact:

**Jim Caronna, SIOR**  
jcaronna@klnb.com  
443-632-2070

100 West Road, Suite 505  
Towson, MD 21204

[klnb.com](http://klnb.com)



[instagram.com/klnbcre](https://www.instagram.com/klnbcre)



[linkedin.com/company/klnb](https://www.linkedin.com/company/klnb)



[facebook.com/KLNBCRE](https://www.facebook.com/KLNBCRE)

While we have no reason to doubt the accuracy of any of the information supplied, we cannot, and do not, guarantee its accuracy. All information should be independently verified prior to a purchase or lease of the property. We are not responsible for errors, omissions, misuse, or misinterpretation of information contained herein and make no warranty of any kind, express or implied, with respect to the property or any other matters.

The logo for NAI klnb features the letters 'NAI' in a bold, dark blue font. The letter 'A' is stylized with a red diagonal stroke. To the right of 'NAI', the letters 'klnb' are in a lighter blue, lowercase font.