



NAI Glickman Kovago & Jacobs



287

FINAL SUITE AVAILABLE | 4,500 SF

287 TURNPIKE ROAD
WESTBOROUGH | MA

FOR LEASE



48,000 square foot, three-story office building

Common fitness room with showers and lockers

Modern shared kitchen | break room



Prime visibility along Route 9 westbound

Near the intersection of Route 20 & Route 9



Just 3.5 miles west of I-495

PROPERTY OVERVIEW

LEASE PRICE:	\$20/SF
SPACE AVAILABLE:	4,500 RSF
BUILDING CLASS:	B
FLOORS:	(3) THREE
ELEVATORS:	1 PASSENGER
PRIVATE OFFICES:	6
ZONING:	BA
YEAR BUILT:	2001
PARKING:	192 SPACES

LOCATION MAP



287 TURNPIKE ROAD
WESTBOROUGH | MA

287 Turnpike Rd



DISTANCE

I-495: 3.5 Miles
I-90: 6.4 Miles
Rt.20: 1.3 Miles
Downtown
Worcester: 15 Minutes



Near the
intersection of
Route 20 & Route 9



AADT: mage © 2025 Airbus
50,000 Cars Per Day.



Prime visibility
along Route 9
westbound

FLOOR PLAN

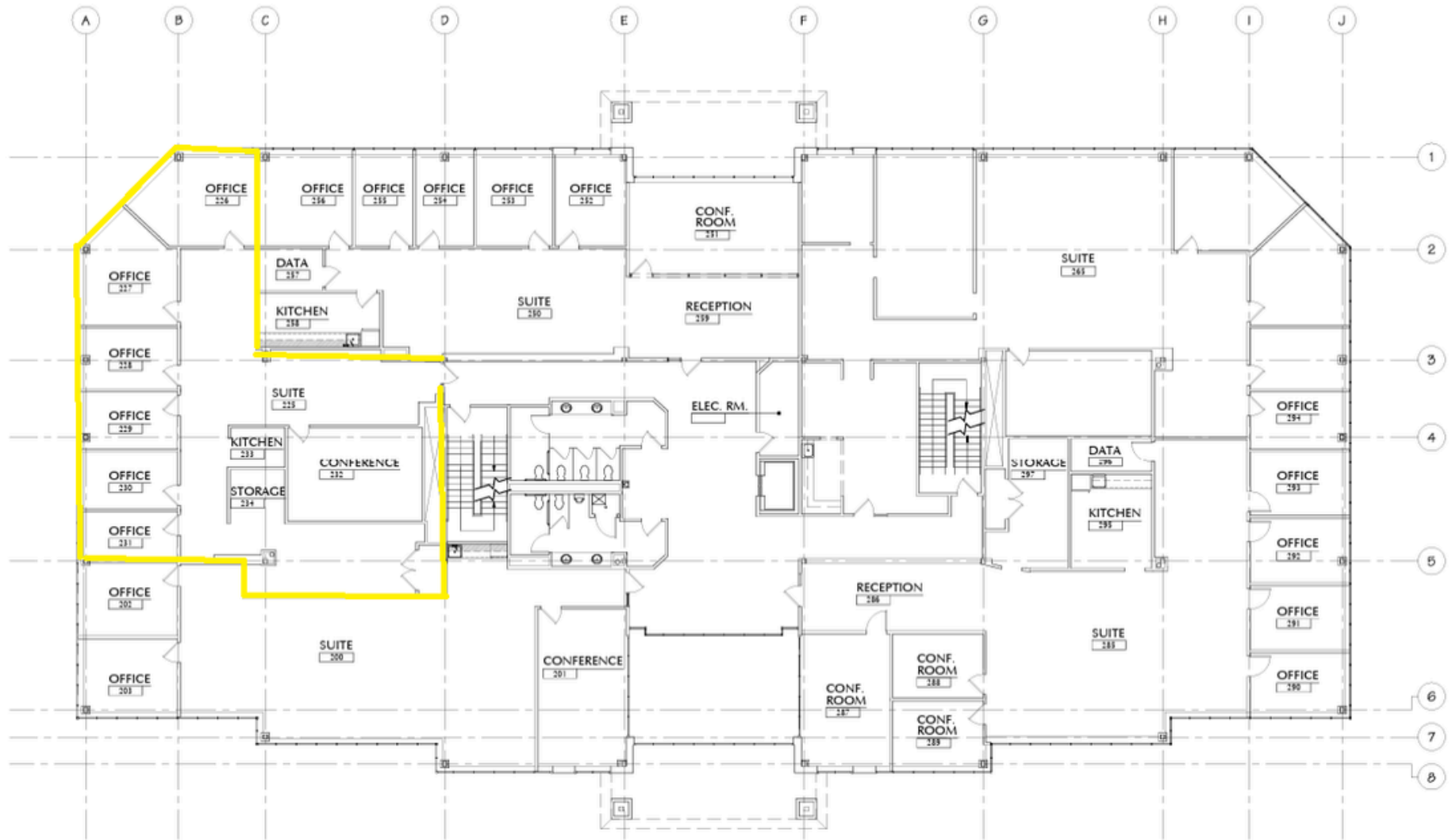

1 EXISTING SECOND FLOOR PLAN
SCALE: 1/8" = 1'-0"

WESTBOROUGH MARKET



STRATEGIC LOCATION

Westborough, Massachusetts, is ideally situated at the crossroads of Interstate 495, Route 9, and Route 30, with close proximity to Interstate 90 (Mass Pike). This prime location offers seamless access to Boston, Worcester, and the broader MetroWest region, making it an attractive hub for businesses requiring regional and statewide connectivity.



THRIVING ENVIRONMENT

Westborough continues to experience steady growth guided by thoughtful planning and community engagement. The town's Master Plan focuses on smart land use, infrastructure improvements, housing diversity, and sustainable development, supporting a balanced environment for commercial and residential advancement.



ROBUST DEVELOPMENT

With a strong commitment to economic growth, Westborough supports its business community through active initiatives led by organizations such as the Economic Development Committee and the Westborough Economic Development Team (EDT). A business-friendly atmosphere, modern amenities, and a highly educated workforce contribute to Westborough's reputation as a dynamic and desirable destination for companies and investors alike.

DEMOGRAPHICS

287 TURNPIKE ROAD WESTBOROUGH | MA



Population	3 Miles	5 Miles	10 Miles
Total Population	38,066	80,516	496,236
Average Age	41	41	40
Average Age (Male)	40	40	39
Average Age (Female)	42	42	41
Households & Income	3 Miles	5 Miles	10 Miles
Total Households	14,054	29,506	190,483
# of Persons per HH	2.7	2.7	2.6
Average HH Income	\$186,992	\$191,642	\$136,935
Average House Value	\$686,101	\$689,592	\$513,081

Demographics data derived from AlphaMap

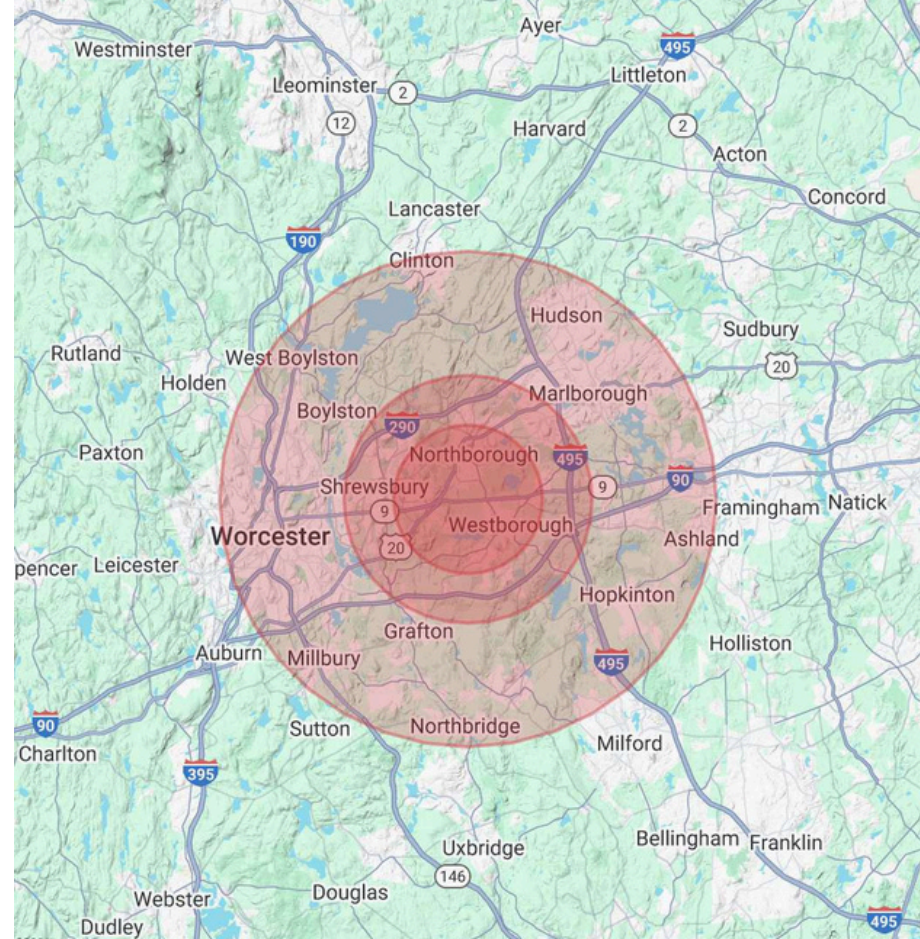

PHOTOS





TIM WHITTREDGE

Senior Vice President

774.239.1900

twhittredge@glickmankovago.com

NAI Glickman Kovago & Jacobs

1 Mercantile Street, Suite 510 | Worcester, MA

508.753.9100

www.glickmankovago.com

287 TURNPIKE ROAD
WESTBOROUGH | MA

All information regarding property for sale or lease is from sources deemed reliable. While we do not doubt its accuracy, we have not verified it and make no warranty or representation to the accuracy thereof and the same is submitted subject to errors, omissions, change of price, rental or other conditions, prior sale or lease or withdrawal without notice. Any projections and assumptions are used for convenience and example only and do not represent actual future performance. You and your trusted advisors should independently verify all information and projections.