



GATEWAY
PLAZA



Michaels



4 ACRE COMMERCIAL PRESENTS

RETAIL SPACE FOR LEASE | CALL FOR DETAILS

101-241 TOWNE CENTER BLVD. SANFORD, FLORIDA



GATEWAY PLAZA

Gateway Plaza is a destination retail shopping center located along Towne Center Boulevard and across the street from the famous Seminole Towne Center. Anchored by Floor & Décor, Ashley Furniture, Planet Fitness (coming soon) and Michael's, this center is easily accessible via I-4 or the 417 and is well positioned to serve the surrounding affluent neighborhoods & communities. With move in ready retail and office space available now, Tenants can take advantage of existing ready-made space and join the national expansion that is quickly underway in Sanford.

HIGHLIGHTS

- Gateway Plaza is a 214,489 square foot Open-Air Shopping Center with un-paralleled access.
- Anchored by National Retailers Planet Fitness (coming soon), Michael's, Ashley Furniture and Floor & Décor.
- Adjacent to I-4, the 417 and the soon to be completed 1.6-billion-dollar 429 Beltway extension to all the surrounding Metropolitan areas. (Est. Completion 2023)
- Situated just North of the rapidly expanding Lake Mary submarket with multiple office parks, award winning schools and highly desirable neighborhoods.
- Strong Household Demographics – 20,879 Households with an average income of \$104,322 within a 3-mile radius



**GATEWAY
PLAZA**

101-241 Towne Center Blvd.
Sanford, FL

OFFERED BY:



GARRETT GLEITER

407.539.4514

GARRETT@4ACRE.COM



GATEWAY
PLAZA

Aerial Photographs



FOR MORE INFORMATION: GARRETT GLEITER: 407.539.4514 | GARRETT@4ACRE.COM





GATEWAY PLAZA

Site Map



Available Suites | STE 201 - 3,925 SF | STE 209 - 3,000 SF

FOR MORE INFORMATION: GARRETT GLEITER: 407.539.4514 | GARRETT@4ACRE.COM





GATEWAY
PLAZA

Suite 201 | ±3,925 SF | Available Now

2nd Gen Apparel Store | TI Available to Qualified Tenants

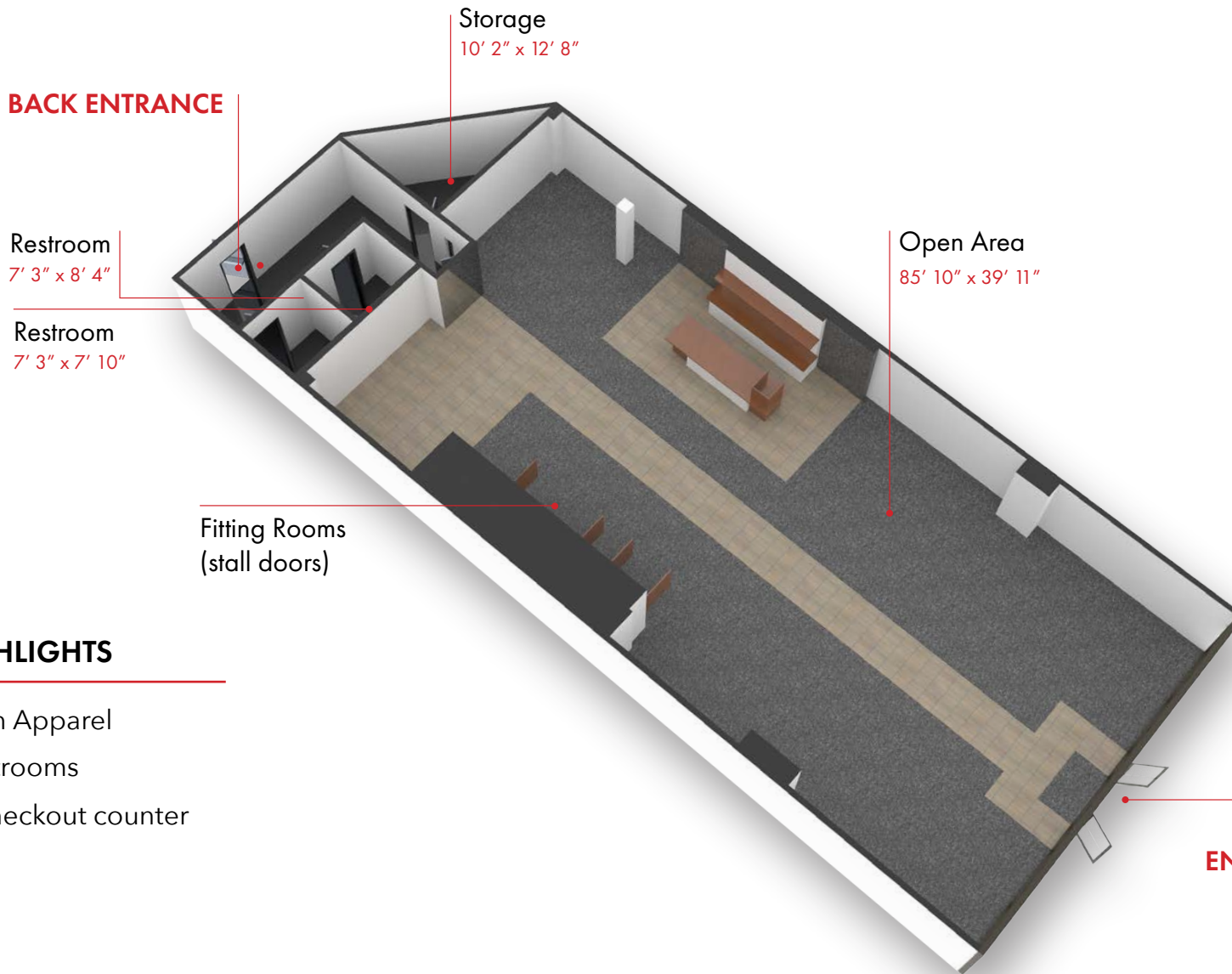

CLICK TO TAKE A
VIRTUAL TOUR

SPACE HIGHLIGHTS

- 2nd Gen Apparel
- Two restrooms
- Retail checkout counter

FOR MORE INFORMATION: GARRETT GLEITER: 407.539.4514 | GARRETT@4ACRE.COM





Suite 209 | ±3,000 SF | Available Now

2nd Gen Retail Store | TI Available to Qualified Tenants

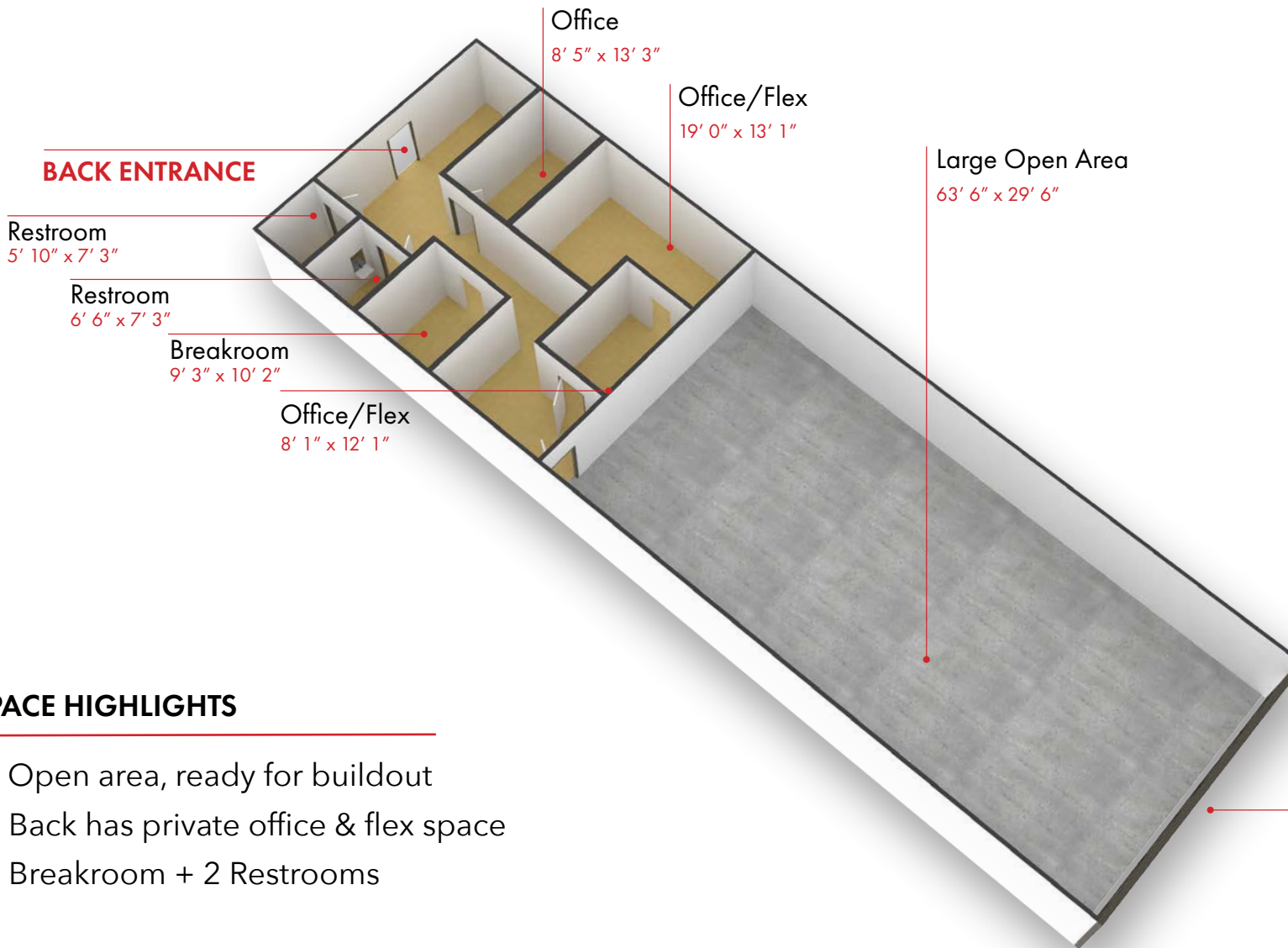

CLICK TO TAKE A VIRTUAL TOUR

SPACE HIGHLIGHTS

- Open area, ready for buildout
- Back has private office & flex space
- Breakroom + 2 Restrooms

FOR MORE INFORMATION: GARRETT GLEITER: 407.539.4514 | GARRETT@4ACRE.COM





GARRETT GLEITER

407.539.4514

GARRETT@4ACRE.COM

4 Acre Commercial Real Estate (4 Acre) does not represent or warranty the accuracy of the information contained herein. Such information has been given to 4 Acre by the owner of the property or obtained from other sources deemed reliable. 4 Acre has no reason to doubt its accuracy, but does not guarantee it. The reviewer(s) of this document is encouraged to perform their own research for their own purposes to verify the dependability of the information being reviewed. All information should be verified by reviewer(s) prior to purchase or lease. Unless otherwise noted, the property is being offered as-is, where is, with all faults. This information represents the proprietary work product of 4 Acre Realty, LLC and may not be copied, reproduced, modified, distributed, published, transmitted, or otherwise disclosed without the express written consent of 4 Acre Realty, LLC.