



PROPERTY FEATURES:

- **For Lease: Negotiable**
- Size: 1,500 to 11,000 square feet
- Tenant Improvement Allowance available
- Neighboring Businesses: Amazon, Elite Edge, Subway, RC Dermatology, Sun Tan City, Buff City Soap, and Kum & Go
- Building & monument signage available
- Drive-Thru space available
- End-Cap with Patio available
- To be completed summer of 2024
- Traffic Counts (2020): SE 19th Street 8,473
- Total population:
1 mile 3,921 | 3 miles 29,870 | 5 miles 89,200

STANBROUGH REALTY COMPANY
2775 86th Street
Urbandale, Iowa 50322
StanbroughRealty.com | 515.334.3345

JEFF STANBROUGH
CCIM, CPM
515.202.6649
Jeff@StanbroughRealty.com

ANDREW MCCUNE
515.402.1642
Andrew@StanbroughRealty.com

1881 SE Princeton Point Drive
GRIMES | IOWA

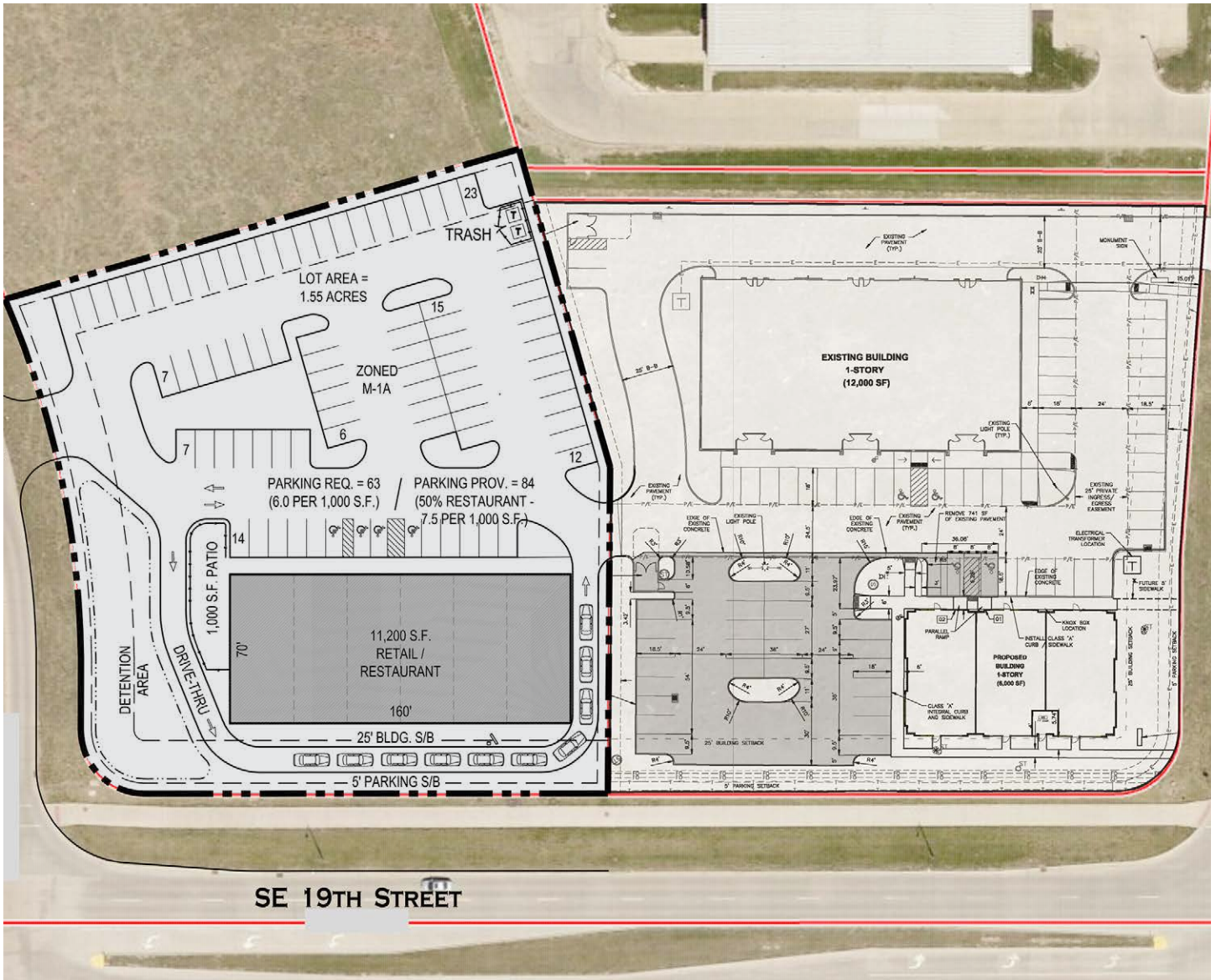

STANBROUGH REALTY COMPANY
2775 86th Street
Urbandale, Iowa 50322
StanbroughRealty.com | 515.334.3345

JEFF STANBROUGH
CCIM, CPM
515.202.6649
Jeff@StanbroughRealty.com

ANDREW MCCUNE
515.402.1642
Andrew@StanbroughRealty.com