

FOR SUBLEASE  
**3050 MILLER ROAD**  
LITHONIA, GA 30338



**15,000 RSF**

**TERM THRU 4/30/2029**

**CONTACT**

**Ryan Blackburn**  
Managing Broker  
404.974.2716  
rblackburn@apexindustrialre.com

**Jeremiah Allen**  
Industrial & Logistics Advisor  
770.264.9421  
jallen@apexindustrialre.com





## PROPERTY OVERVIEW

---

<b>Total Size:</b>	15,000 SF
<b>Office:</b>	1,187 SF
<b>Warehouse:</b>	13,813 SF
<b>Dock High Doors</b>	Two (2)
<b>Drive In Door</b>	One (1)
<b>Term Thru</b>	April 30, 2029



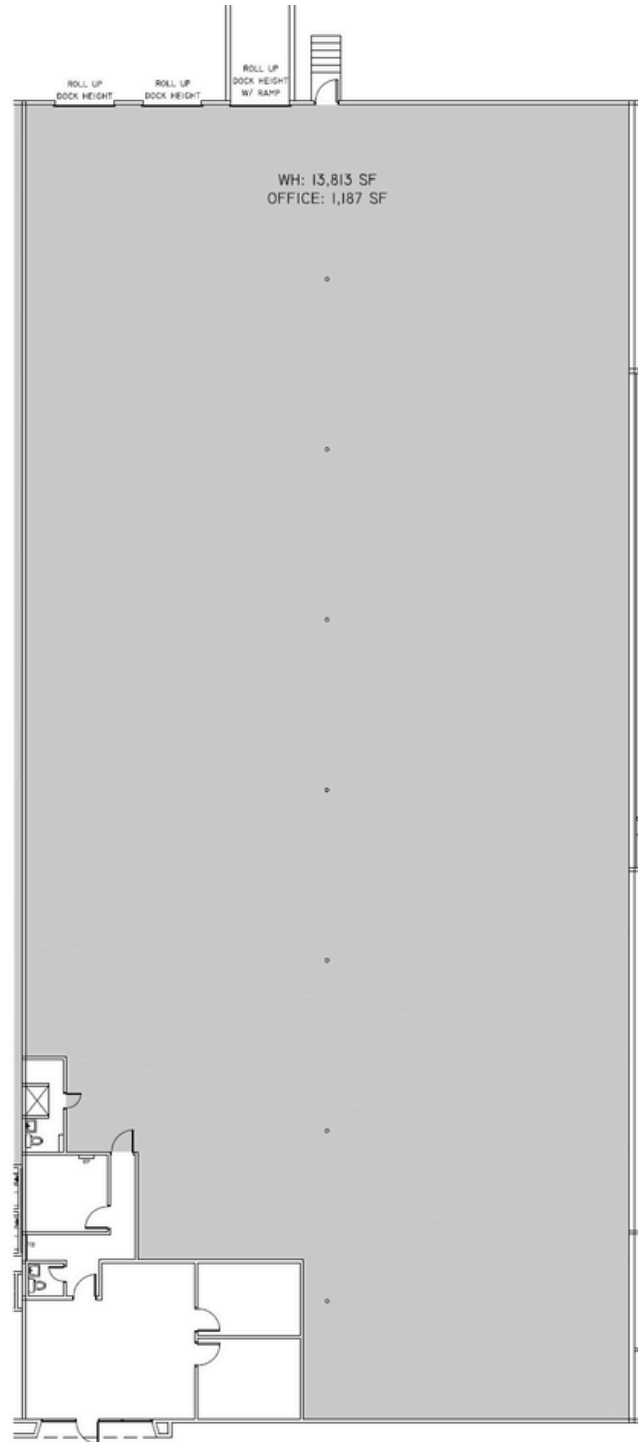

# LOCATION OVERVIEW

**3050 Miller Road**  
Lithonia, GA 30338

20

## FOR MORE INFORMATION:

**Ryan Blackburn**  
Managing Broker  
404.974.2716  
rblackburn@apexindustrialre.com

**Jeremiah Allen**  
Industrial & Logistics Advisor  
770.264.9421  
jallen@apexindustrialre.com

20

LESS THAN ±2 MILES

285

±4.5 MILES

85

±15 MILES



Hartsfield-Jackson  
International Airport

±17 MILES



Apex Industrial Real Estate Advisors

[www.apexindustrialre.com](http://www.apexindustrialre.com)