

All drawings, specifications, related documents and design are the copyright property of Patrick Markus Luckie Architect and shall be used only for the project named on this drawing and shall be reference purposes only. The contractor is responsible for the coordination and verification of all dimensions, conditions, levels and all measurements and conditions on site as they pertain to these documents. The contractor shall report any discrepancies to the consultant in writing prior to the commencement of any affected work.

Do Not scale this drawing.
This drawing shall not be used for construction purposes unless counterchecked.
Patrick Markus Luckie Architect

ZONING	E2	REQUIRED	PROPOSED
MINIMUM FRONT YARD	7.5 m	19.7 m	
MINIMUM EXTERIOR SIDE YARD	7.5 m	n/a	
MINIMUM INTERIOR SIDE YARD			
Lot with a lot frontage less than or equal to 75.0 m	the greater of 10% of the frontage of lot, or 4.5 m	5.18 m (10%)	
MINIMUM REAR YARD	7.5 m	27.9 m	
MINIMUM LANDSCAPED BUFFER			
Minimum depth of a landscaped buffer measured from a lot line that is a street line	4.5 m	5.5 m	
Minimum depth of a landscaped buffer measured from a lot line that abuts an Employment, Utility or Airport Zone, or any combination of zones thereof	0.0 m	2.85m (N)	
PARKING			
3.2/100 SQM NON-RES GFA	2845.2 @ 3.2/100 = 91	70	VARIANCE REQUIRED
ACCESSIBLE PARKING			
4% of the total	4	4 (2A, 2B)	
LOADING SPACES			
Greater than 2 350 m2 but less than or equal to 11 600 m2	1	0	VARIANCE REQUIRED
COVERAGE		SQM	
LOT AREA		4095.6	
BUILDING COVERAGE		1081.6	26%
PAVED AREA		2214.7	54%
SIDEWALKS		148.7	4%
LANDSCAPE (OTHER)		650.6	16%
FLOOR AREAS		SQM	SQFT
1ST FLOOR		1050.1	11,303
2ND FLOOR		1055.6	11,362
3RD FLOOR		1055.6	11,362
TOTAL		3161.3	34,028
NON-RESIDENTIAL GFA @ 90%		2845.2	
HEIGHT	(NO MAXIMUM)	3-STOREY	
		13.65m	

1 SITE PLAN
A-0.1 SCALE: 1:250

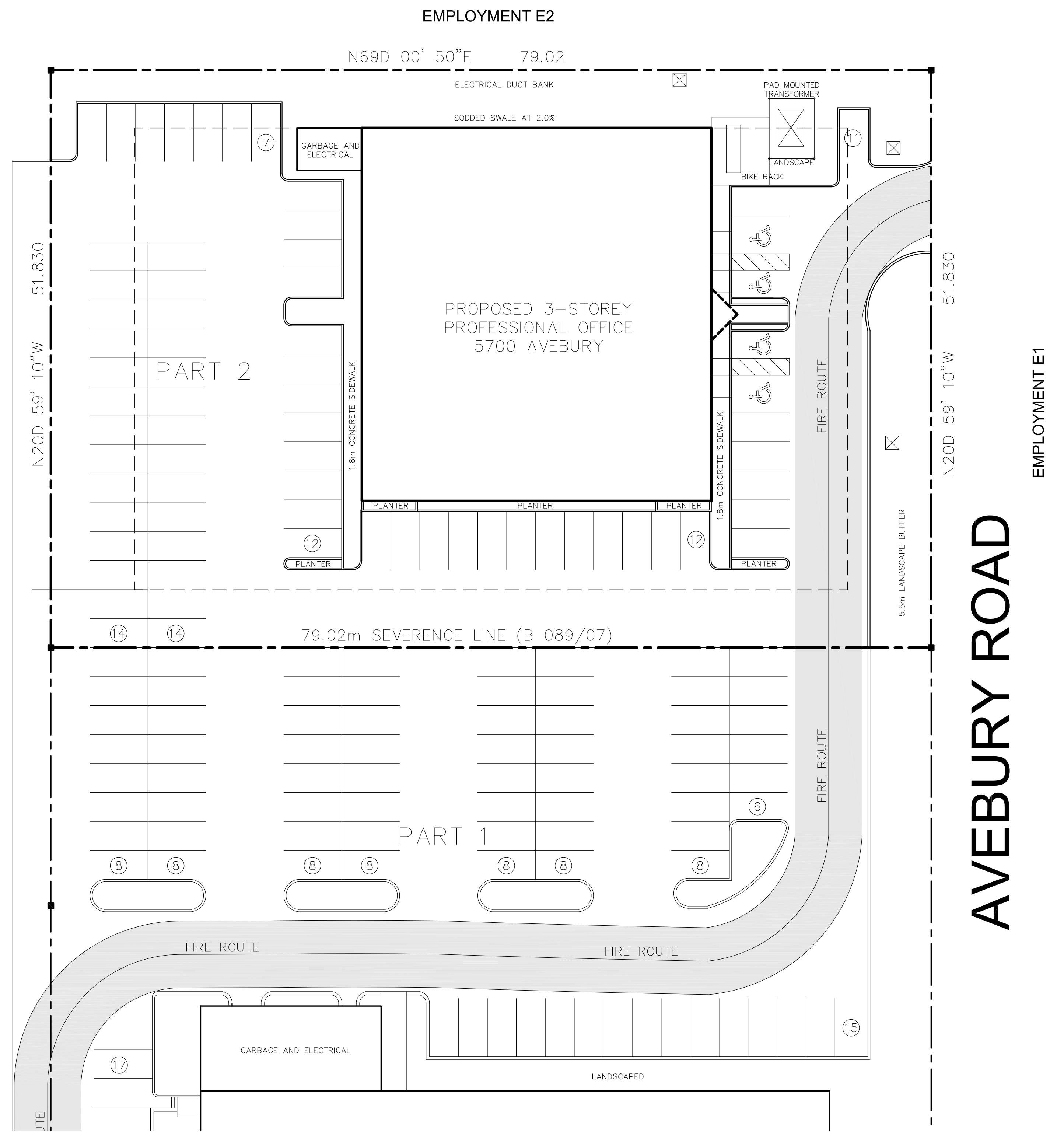

AVEBURY ROAD

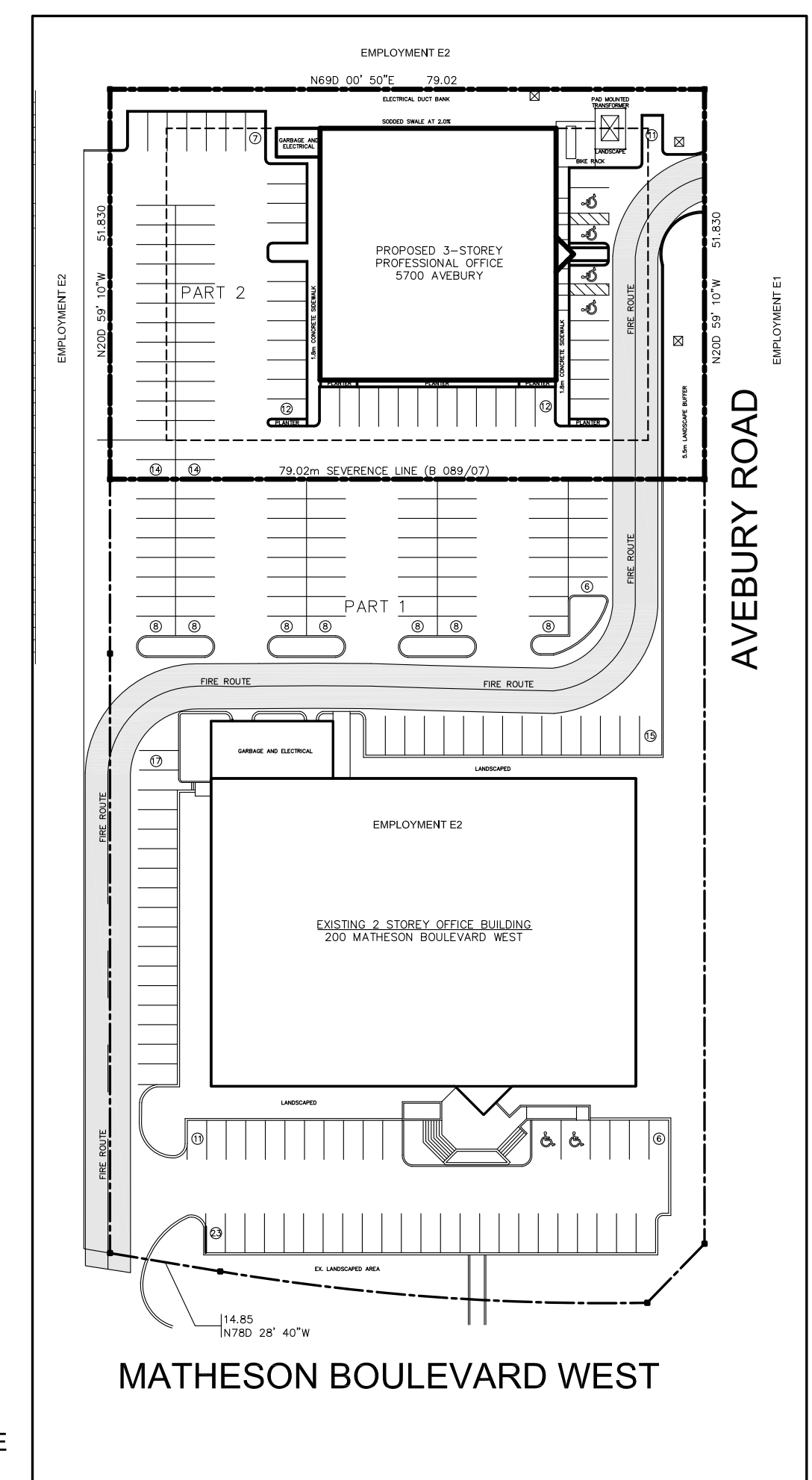

2 OVERALL SITE
A-0.1 SCALE: 1:750

Revisions:	Date:	Particular:

Issue:	Date:	Particular:
FEB.10.20		ISSUED FOR REVIEW

AVEBURY OFFICE
5700 AVEBURY ROAD, MISSISSAUGA
SITE PLAN
PROJECT No.:

A-0.1