

FOR LEASE | INDUSTRIAL  
Brownsville, TX

1900 Billy Mitchell B  
125,000 SF  
October 2026



## Property Overview

Coming to market is a 125,000 SF warehouse building in Brownsville, TX. Ideal warehouse for a logistics, distribution center, or 3PL operations needing to locate or expand in Brownsville, Texas. Equipped with 12 overhead doors and room to add more, and its cross-dock capability.

## Location Overview

Located within Airport Industrial Park, the property offers convenient access to the Veterans International Bridge, future East Loop corridor, and I-169. Its strategic location positions it between the Port of Brownsville and the international crossing, providing connectivity for industrial, logistics end users

**Alejandro Garza**

Brokerage Services

- 📞 (956) 346 3176
- ✉️ alex@icollc.com
- 🌐 icollc.com
- 📍 3521 Old Port Isabel Rd.  
Brownsville, TX 78526

**WAREHOUSE SPACE  
AVAILABLE**



## FLOOR PLAN

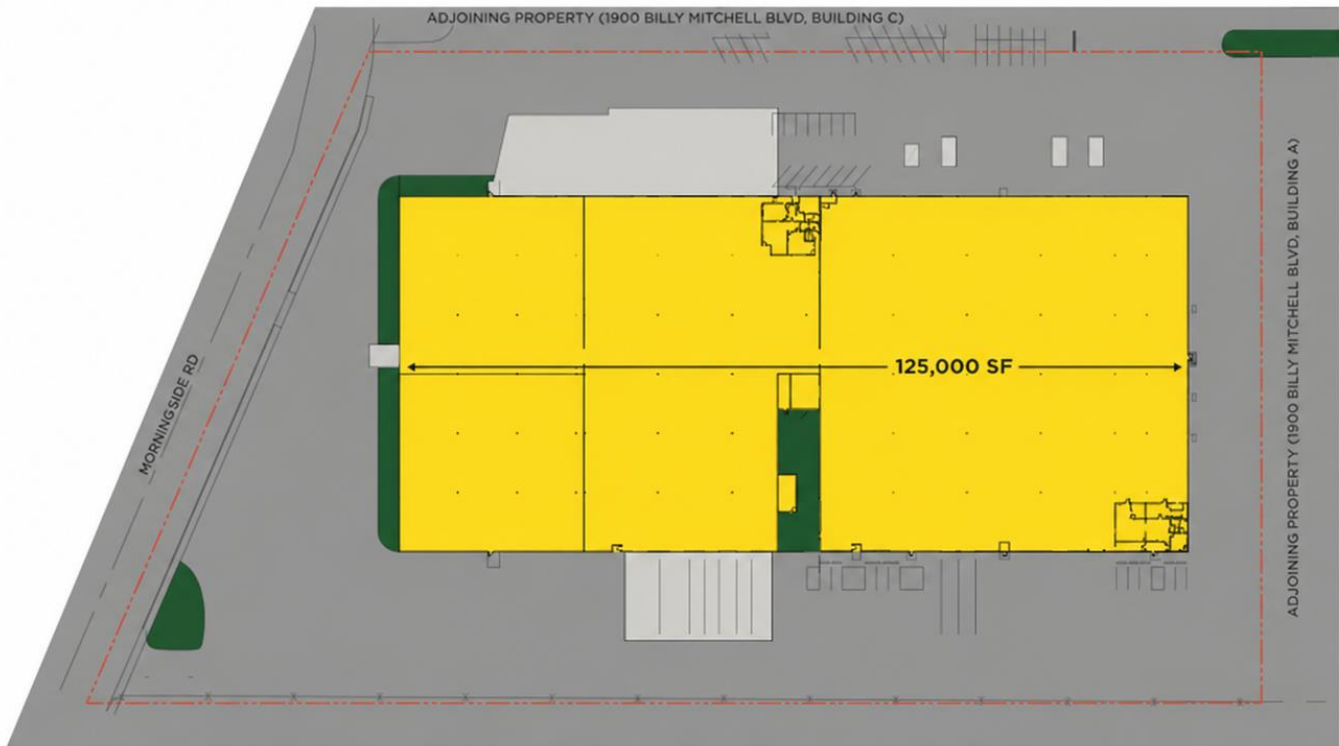

### Alejandro Garza

#### Brokerage Services

- ☎ (956) 346 3176
- ✉ alex@icollc.com
- 🌐 icollc.com
- 📍 3521 Old Port Isabel Rd.  
Brownsville, TX 78526

**WAREHOUSE SPACE  
AVAILABLE**



## SITE LAYOUT

### Building Summary

- 125,000 SF
- Fire Sprinklered
- 21' Clear Height
- Concrete-Tilt Up
- Cross-Dock
- 12 OH Doors

### Location Summary

- Airport Industrial Park
- Direct Access To Hwy 4
- Direct Access to Port of Brownsville
- Near Future East Loop



**Alejandro Garza**

Brokerage Services

☎ (956) 346 3176

✉ alex@icollc.com

🌐 icollc.com

📍 3521 Old Port Isabel Rd.  
Brownsville, TX 78526

**WAREHOUSE SPACE  
AVAILABLE**

**ICO**  
Real Estate Advisors

# Airport Industrial Park



**Alejandro Garza**

Brokerage Services

- 📞 (956) 346 3176
- ✉ alex@icollc.com
- 🌐 icollc.com
- 📍 3521 Old Port Isabel Rd. Brownsville, TX 78526

**WAREHOUSE SPACE  
AVAILABLE**



# LOCATION MAP

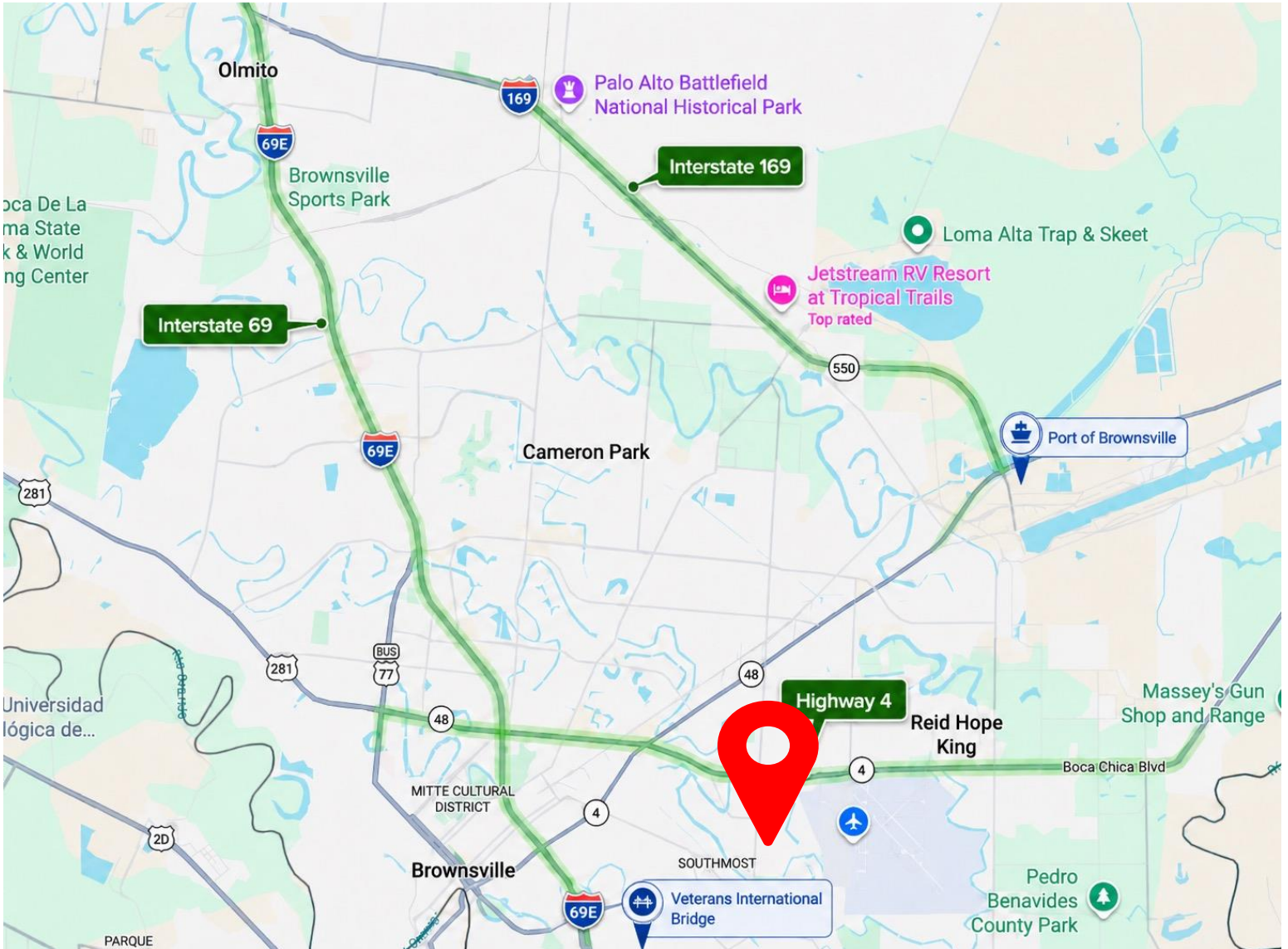

**Alejandro Garza**

Brokerage Services

- 📞 (956) 346 3176
- ✉ alex@icollc.com
- 🌐 icollc.com
- 📍 3521 Old Port Isabel Rd. Brownsville, TX 78526

**WAREHOUSE SPACE  
AVAILABLE**

