

Steilacoom Center

Professional Office Space

210 Wilkes St
Steilacoom, WA 98388
www.cbre.com/tacoma



Steilacoom Center

210 Wilkes St, Steilacoom WA 98388



Steilacoom Center

Property Details

Professional office space, located in the heart of historic Steilacoom, located next to the United States Post Office. Within walking distance to Anderson Island Ferry, farmers market, restaurants, and Pioneer Orchard Park- featuring breathtaking views of the bay.

+ Available Suites

- Suites 208: 1,091 SF Office
- Suite 206: 688 SF Retail

+ Lease Rate

- Contact broker

+ Zoning

- General Commercial, City of Steilacoom

+ Individual office space available

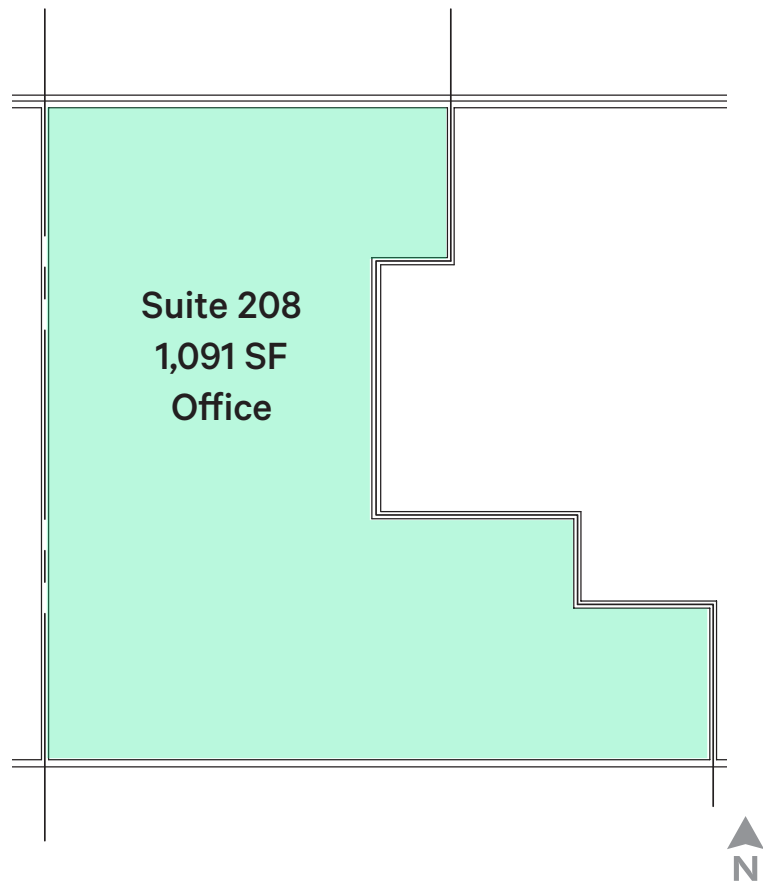
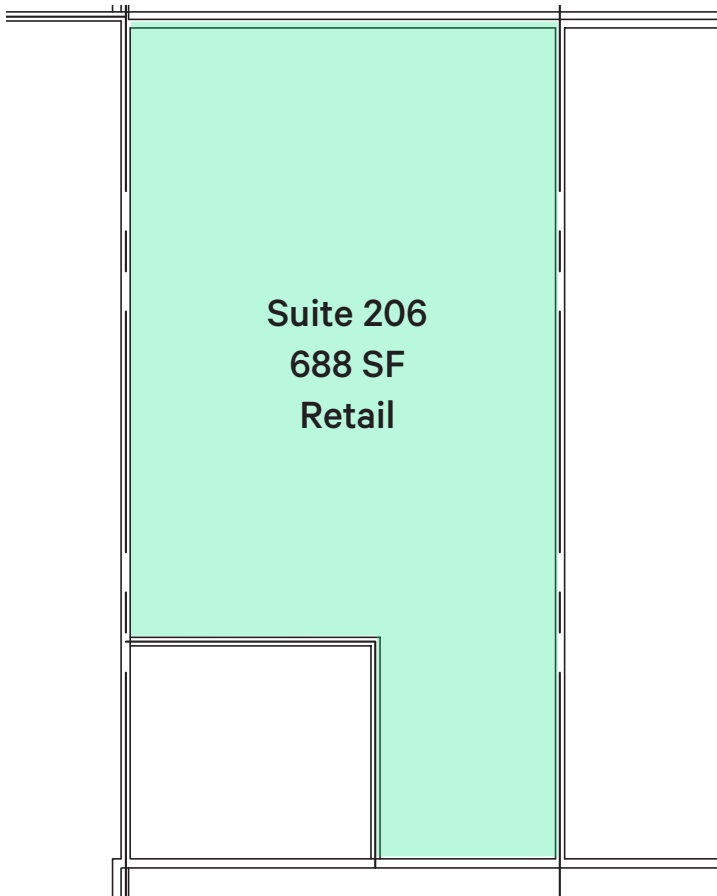
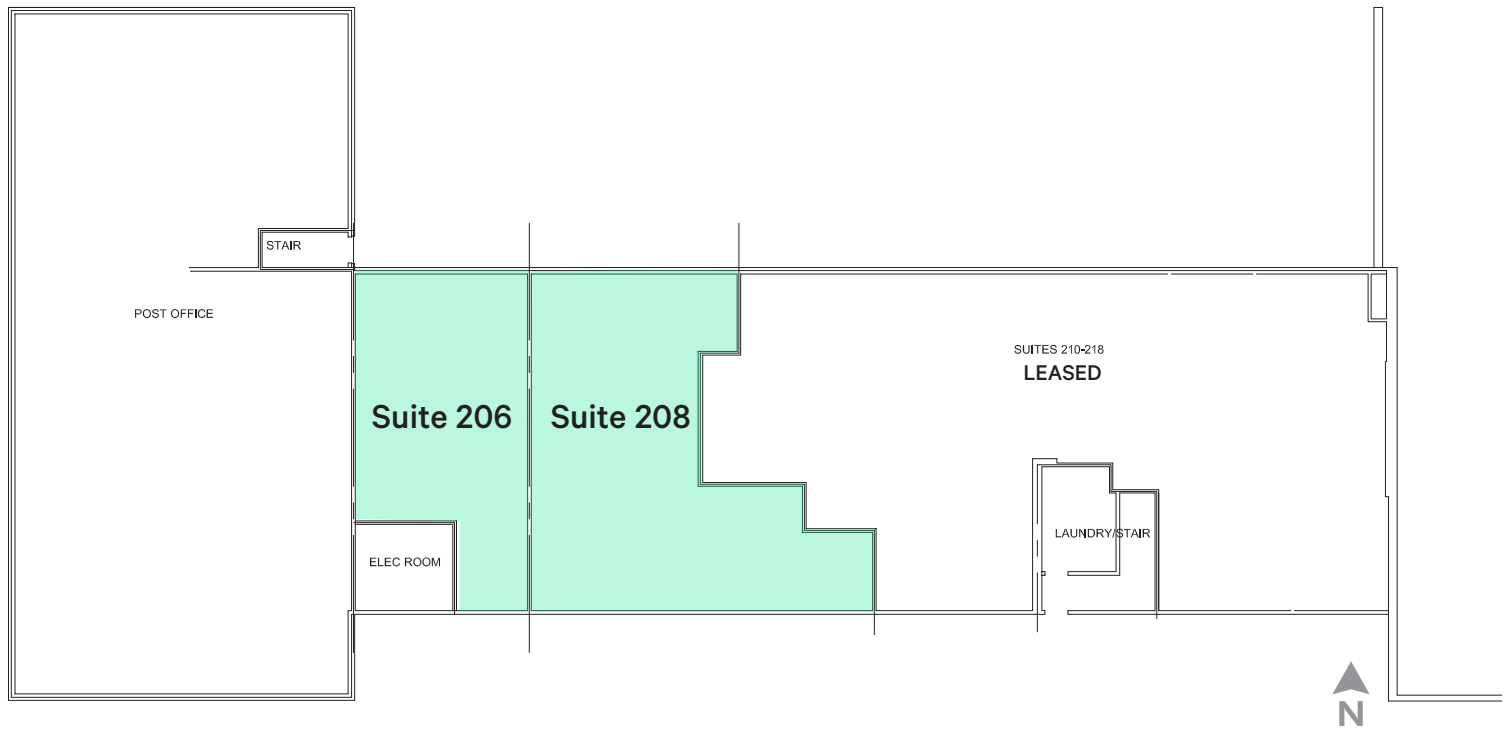

Steilacoom Center

210 Wilkes St, Steilacoom WA 98388

For Lease



Demographics	1 Mile	3 Miles	5 Miles
Population	6,326	35,930	116,098
Average Household Income	\$131,836	\$111,346	\$103,692
Daytime Population	5,115	30,048	113,059

Source: ESRI 2022

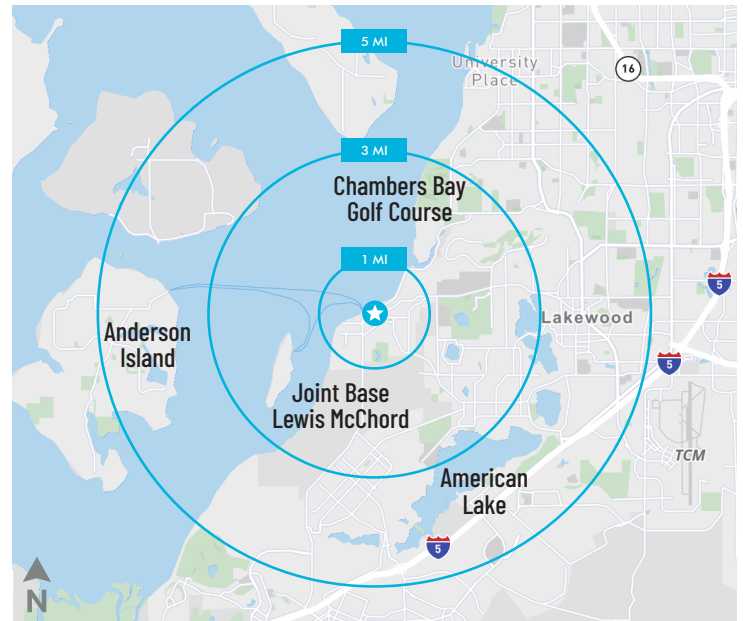

Contact Us

Leon Titus

Associate
 +1 253 596 0042
 leon.titus@cbre.com

CBRE, Inc.

+1 253 576 6355
 710 Market Street
 Tacoma, WA 98409

© 2024 CBRE, Inc. All rights reserved. This information has been obtained from sources believed reliable, but has not been verified for accuracy or completeness. You should conduct a careful, independent investigation of the property and verify all information. Any reliance on this information is solely at your own risk. CBRE and the CBRE logo are service marks of CBRE, Inc. All other marks displayed on this document are the property of their respective owners, and the use of such logos does not imply any affiliation with or endorsement of CBRE. Photos herein are the property of their respective owners. Use of these images without the express written consent of the owner is prohibited. SD 6.5.24