



ETON BUSINESS PARK

21121-21125 OSBORNE ST.
CANOGA PARK, CA

SPACE AVAILABLE | 10,022 SF

\$15,935 MG
PER MONTH (\$1.59 PSF)

6 MONTHS HALF RENT
(SUBJECT TO TENANT'S
CREDIT AND MINIMUM
3-YEAR LEASE TERM)



NEWMARK

Jeff Abraham, SIOR
Executive Managing Director
t 818-921-8528
jeff.abraham@nmrk.com
CA RE License #01830909

Javier Galvan
Associate Director
t 818-921-8532
javier.galvan@nmrk.com
CA RE License #02116539

Corporate License #01355491

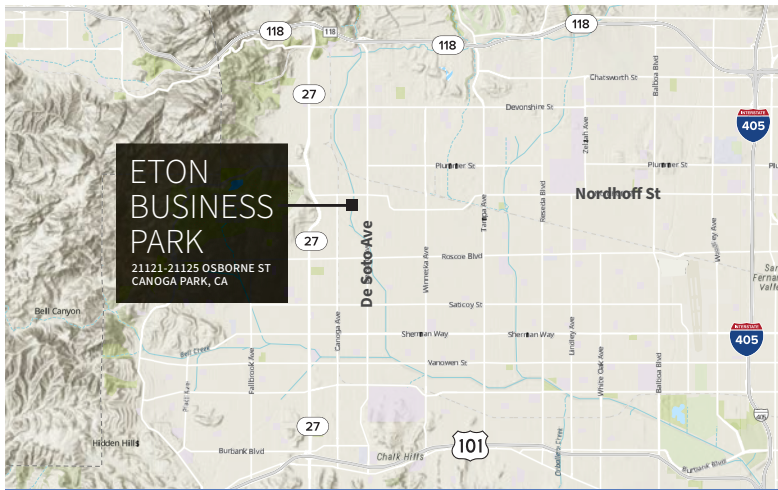

ETON BUSINESS PARK
 21121-21125 OSBORNE ST
 CANOGA PARK, CA

REGIONAL MAP

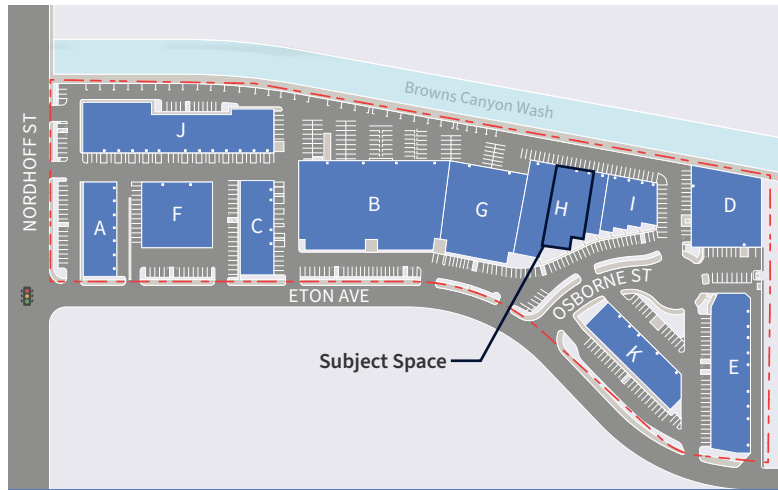

SITE PLAN

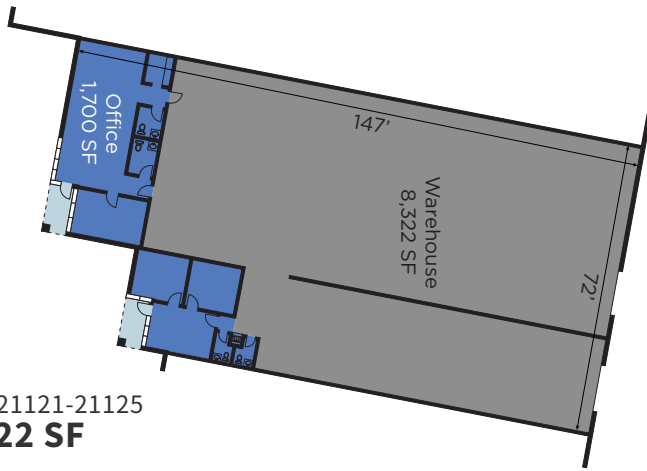

SUITE 21121-21125
10,022 SF

FLOOR PLAN



INTERIOR PHOTO

SUITE ATTRIBUTES



2 rear ground level loading doors



15-foot minimum warehouse clearance



Clear span warehouse



1,700 SF functional office space



Two panels: 250 Amps, 277/480 Volts and 100 Amps, 120/208 Volts



3.5 miles from 118 Freeway and 5.2 miles from 101 Freeway



2.00:1,000 SF parking (20 spaces)



20 minutes from 405 Freeway, providing access to Greater Los Angeles



3 miles from Westfield Topanga



Jeff Abraham, SIOR
 Executive Managing Director
 t 818-921-8528
 jeff.abraham@nrmk.com
 CA RE License #01830909

Javier Galvan
 Associate Director
 t 818-921-8532
 javier.galvan@nrmk.com
 CA RE License #02116539

Corporate License #01355491