

INDUSTRIAL SPACE FOR LEASE

30,240 SF

Warm Springs Distribution Center 12

7660 Dean Martin Drive

Suite 202-203

Las Vegas, NV 89139

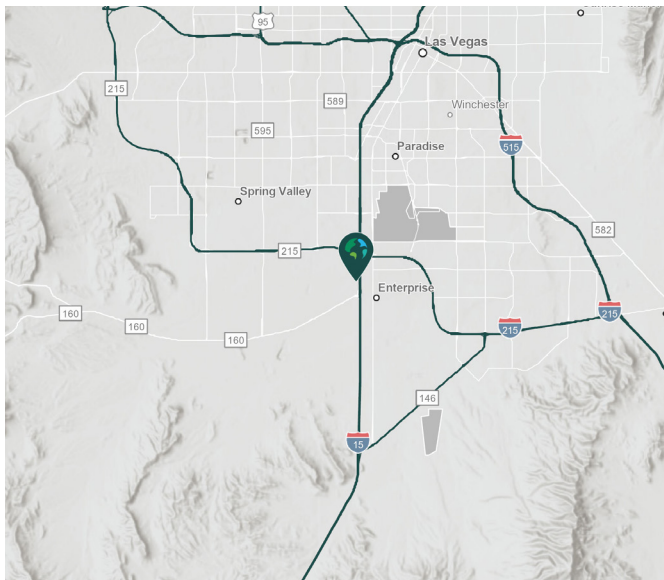

- Conveniently located in the heart of the Las Vegas Southwest submarket with easy access to the I-15 and I-215 Freeways, Harry Reid International Airport, Town Square and the Las Vegas Strip.

- Easy access to the I-15 and I-215 Freeways.



## Property Features

Available Space	30,240 SF	Car Parking Spaces	Pro Rata Share
Office SF	2,832 SF	Electrical Service	200 amps, 120/208 V
Clear Height	24'	Sprinkler System	ESFR with a 25.2K factor operating at 20 psi
Dock Doors	6		
Pit Levelers	2	Lighting	LED Motion Sensor
Drive-in Doors	2	Zoning	IP (Industrial Park)



Unlock the full potential of your  
**warehouse with one strategic,  
 single-source partner.**

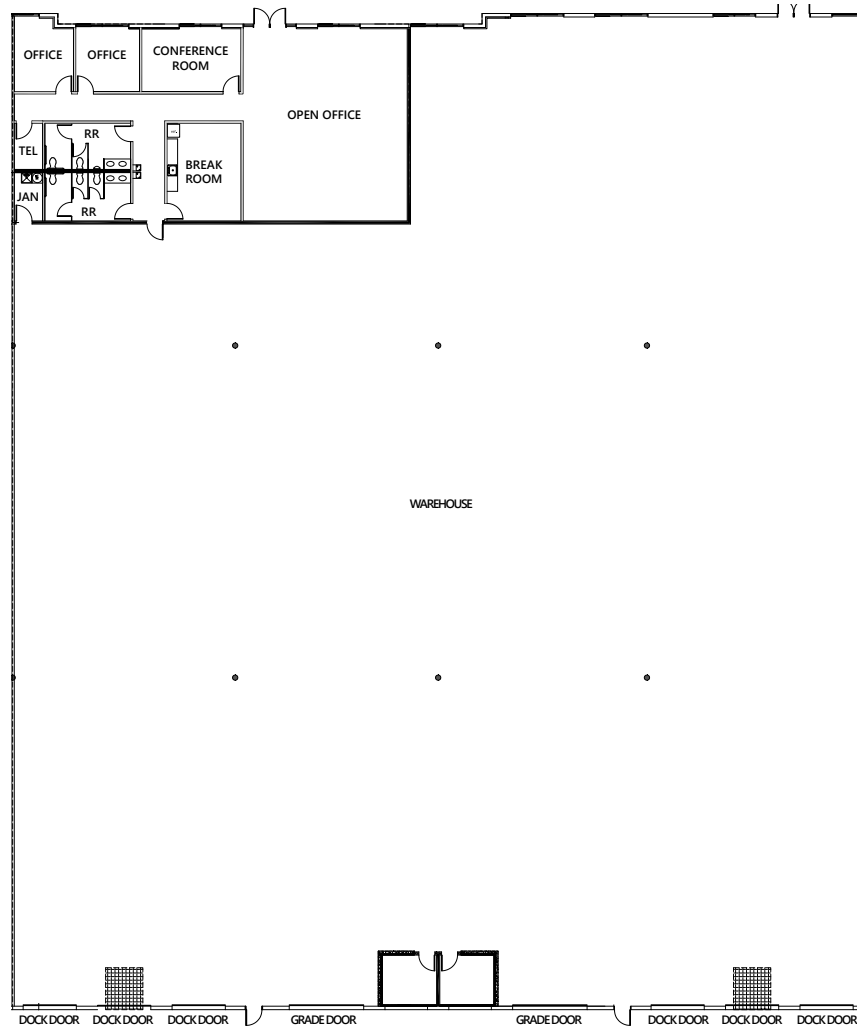

**C&W Las Vegas**  
**Nick Abraham, SIOR**  
 nick.abraham@cushwake.com  
 ph +1 702 605 1620

**C&W Las Vegas**  
**Greg Tassi, SIOR**  
 greg.tassi@cushwake.com  
 ph +1 702 605 1713





**Prologis**  
**Renee Carroll**  
 rcarroll@prologis.com  
 ph +1 702 891 9503

**Prologis**  
**Johana Gonzalez**  
 jgonzalez2@prologis.com  
 ph +1 702 891 9510

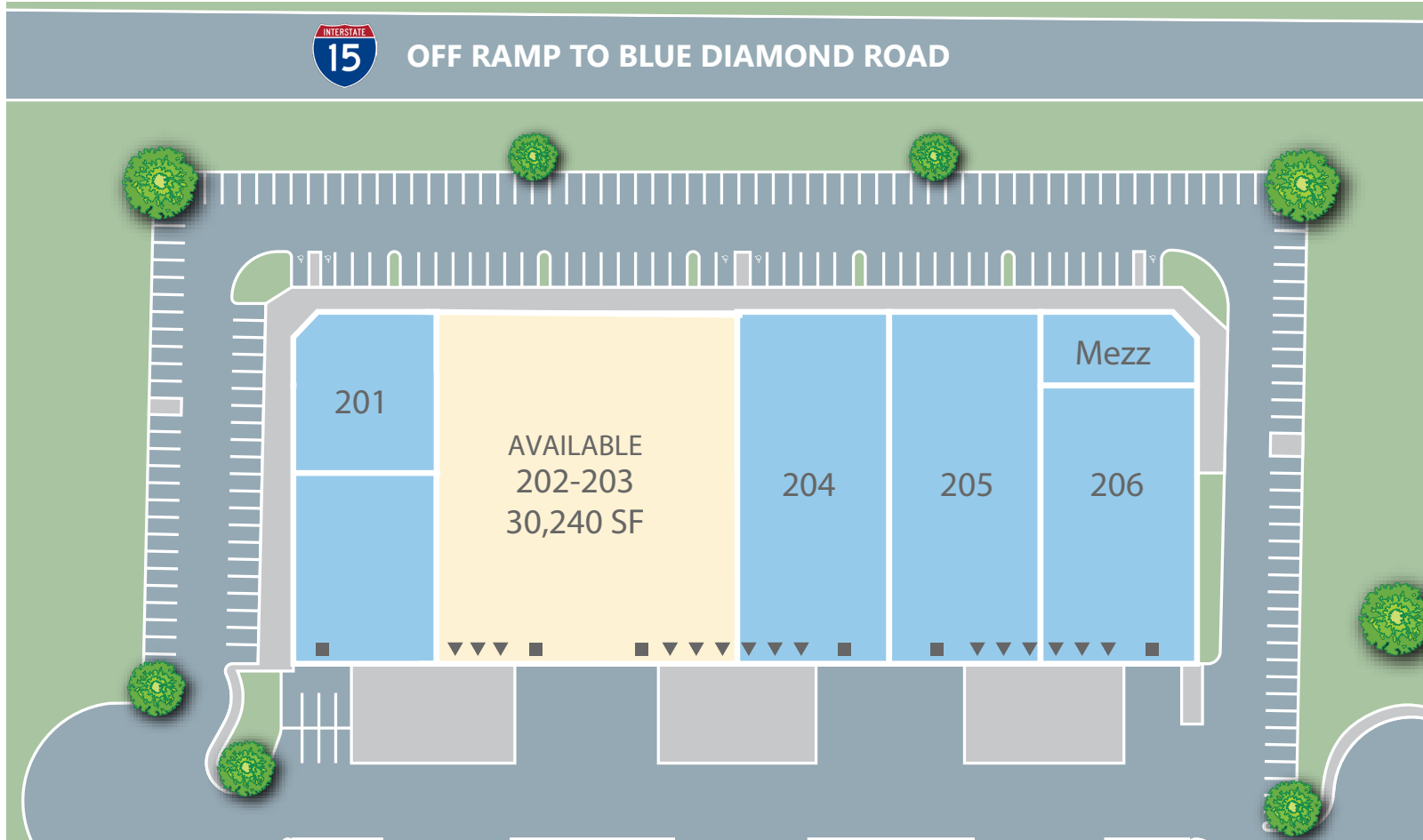

Unlock the full potential of your warehouse with one strategic, single-source partner.



-  NORTH
-  DOCK DOOR
-  DRIVE-IN DOOR
-  AVAILABLE
-  LEASED



**C&W Las Vegas**  
**Nick Abraham, SIOR**  
 nick.abraham@cushwake.com  
 ph +1 702 605 1620

**C&W Las Vegas**  
**Greg Tassi, SIOR**  
 greg.tassi@cushwake.com  
 ph +1 702 605 1713

**Prologis**  
**Renee Carroll**  
 rcarroll@prologis.com  
 ph +1 702 891 9503

**Prologis**  
**Johana Gonzalez**  
 jgonzalez2@prologis.com  
 ph +1 702 891 9510