

**barnsdales™**  
GROUP

## Retail To Let

£9,750 per annum

1,035 sq ft

**High Croft, Hoyland,  
Barnsley, S74 9AF**

## Retail To Let, Barnsley

- Town center location
- Bluechip tenant neighbours
- Busy market area
- Free Parking nearby

[www.barnsdales.co.uk](http://www.barnsdales.co.uk)



## High Croft, Hoyland, Barnsley, S74 9AF

### Summary

- Rent: £9,750 per annum

### Further information

- [View details on our website](#)

### Contact & Viewings

James Humphreys  
07944 938 254  
james.humphreys@barnsdales.co.uk



### Description

Fantastic retail opportunity available in the Heart of Hoyland town centre located just on the access of Hoyland Market. The property provides very clean open plan commercial space with high clear height suitable for racking out storage space.

The property could be used and adapted for a variety of retail businesses and all enquiries are welcomed. Car parking is available directly in front of the property and is free to use for the first 40 minutes of your stay.

Neighbouring tenants include Boyes and Ladbrokes generating a good amount of regular footfall.

### Location

The property is located centrally to Highcroft, Hoyland just of the B6097 carriageway.

### Viewings

Viewings strictly by prior appointment with the agents:

James Humphreys  
Surveyor

D: 01302 304430  
M: 07944 938 254  
E: James.Humphreys@barnsdales.co.uk

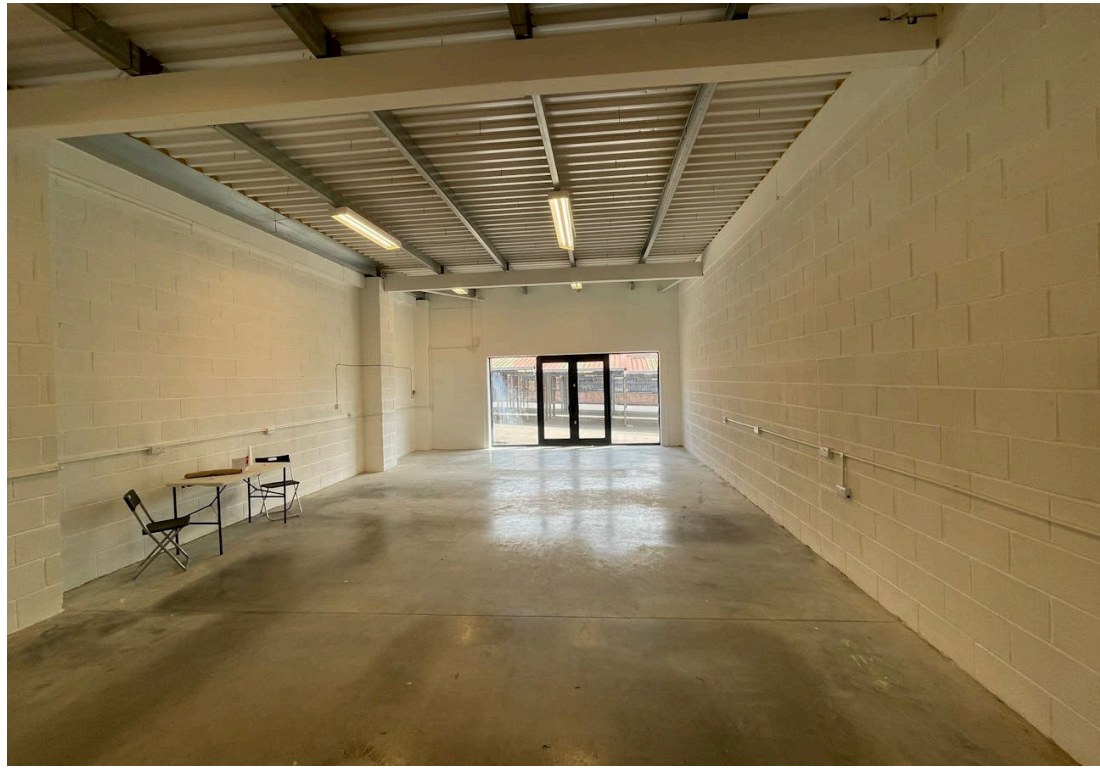

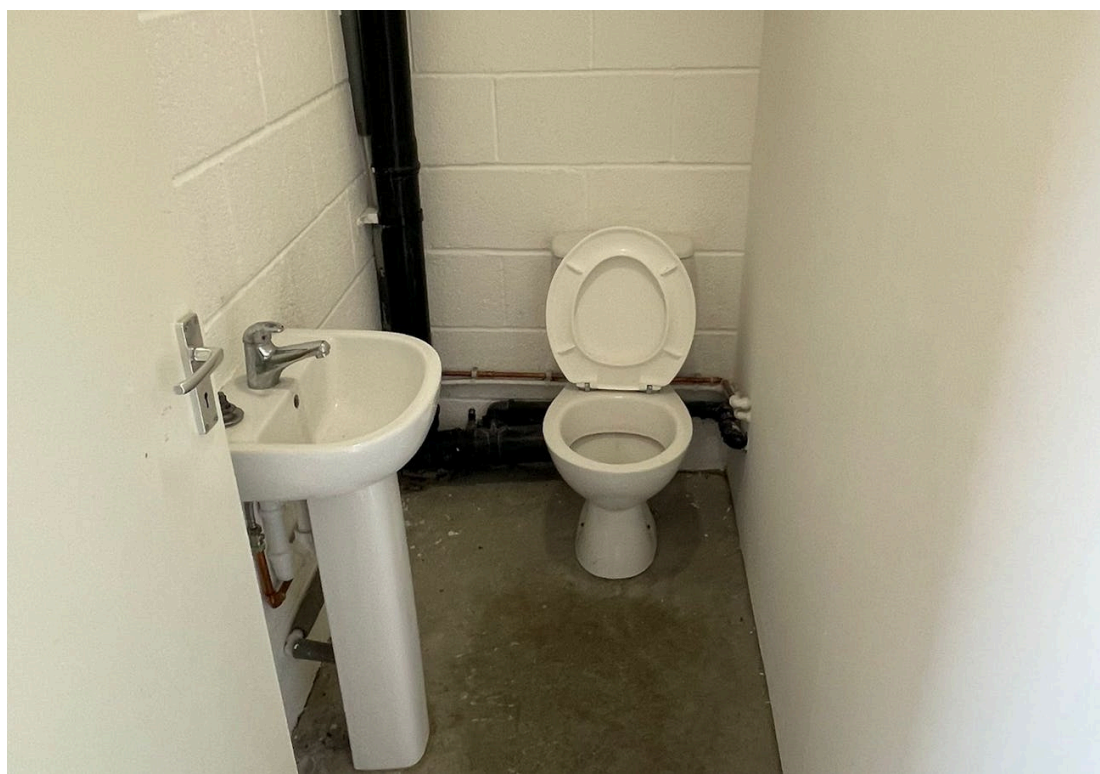

# HOYLAND market

BOYES

*For good value!*

Community  
Shop

L  
Ladbrokes



Bargain Booze

Stamp

Market Place

