

For Lease

25,200 SF AVAILABLE

WEST BY NORTHWEST BUSINESS PARK

6315 West by Northwest Blvd. | Suite 400
Houston, TX 77040



Park Overview

- Master-planned business park
- Outstanding corporate identity
- Attractive glass storefront entry
- Convenient access to Hwy. 290 and Beltway 8
- End-cap space



For leasing information, please contact Stream Realty Partners
JACK RATHE | jack.rathe@streamrealty.com | 972.655.9067-
MEG ZSCHAPPEL | meg.zschappel@streamrealty.com | 832.316.1053
NATALIE GILBERT | natalie.gilbert@streamrealty.com | 713.332.3413



For Lease

25,200 SF AVAILABLE

WEST BY NORTHWEST BUSINESS PARK

6315 West by Northwest Blvd. | Suite 400
Houston, TX 77040

Suite 400 Overview

- 25,200 SF available
- 23,905 SF warehouse
- 1,295 SF office
- ESFR sprinkler system
- 40'x45' bays
- 24' clear height
- 5 dock-high 9'x10' loading doors
- One (1) ramp
- Fenced truck apron

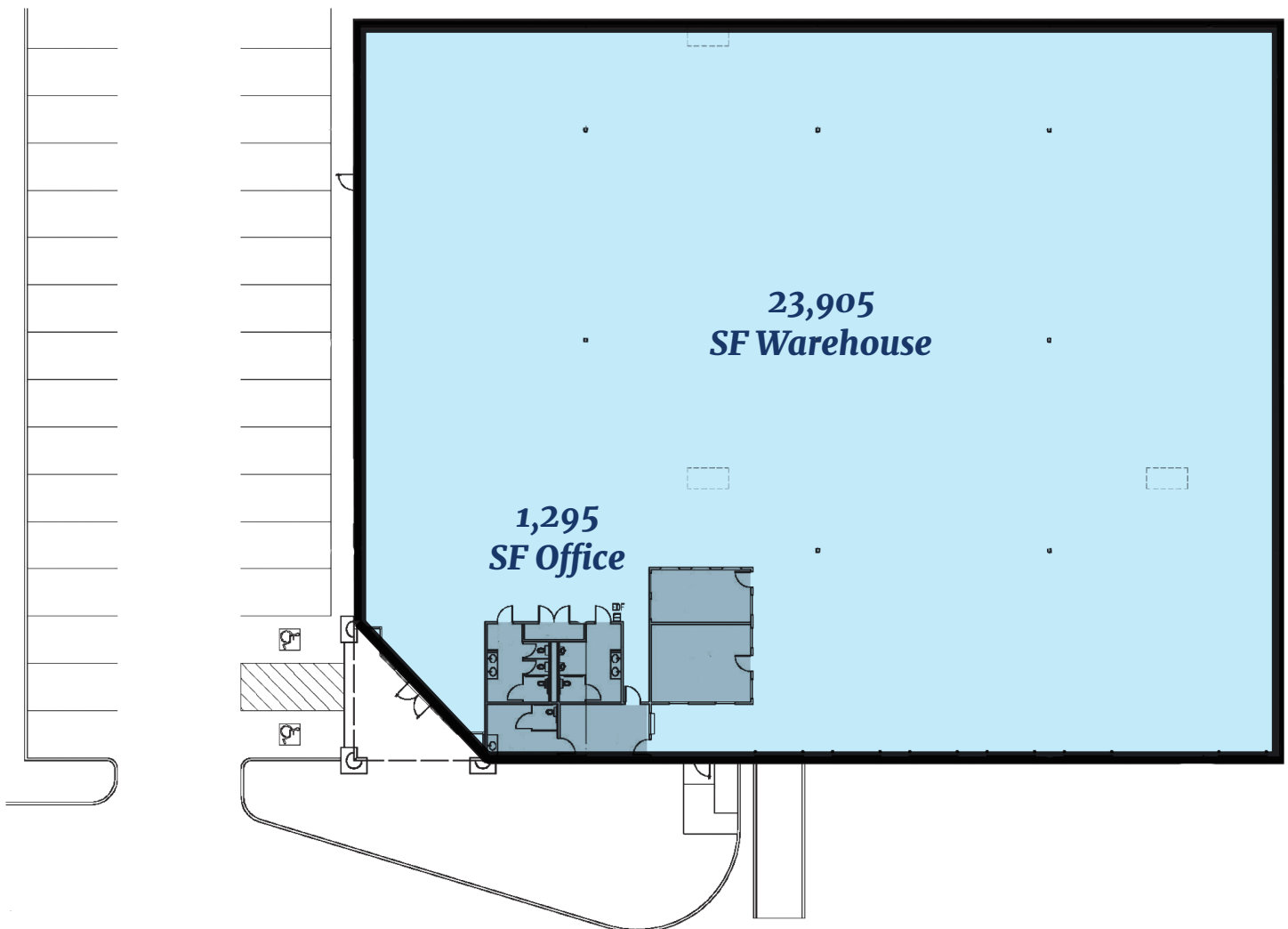

For leasing information, please contact Stream Realty Partners
JACK RATHE | jack.rathe@streamrealty.com | 972.655.9067-
MEG ZSCHAPPEL | meg.zschappel@streamrealty.com | 832.316.1053
NATALIE GILBERT | natalie.gilbert@streamrealty.com | 713.332.3413



For Lease

25,200 SF AVAILABLE

WEST BY NORTHWEST BUSINESS PARK

6315 West by Northwest Blvd. | Suite 400
Houston, TX 77040



For leasing information, please contact Stream Realty Partners
JACK RATHE | jack.rathe@streamrealty.com | 972.655.9067-
MEG ZSCHAPPEL | meg.zschappel@streamrealty.com | 832.316.1053
NATALIE GILBERT | natalie.gilbert@streamrealty.com | 713.332.3413

