

35TH AVE DISTRIBUTION CENTER



±40,710 SF
INDUSTRIAL SPACE AVAILABLE
1601-1605 S 35th Ave, Phoenix Arizona

CBRE



AVAILABLE SPACE

35TH AVE DISTRIBUTION CENTER

NOT TO SCALE
ALL MEASUREMENTS
ARE APPROXIMATE

■ DOCK HIGH
□ GRADE LEVEL

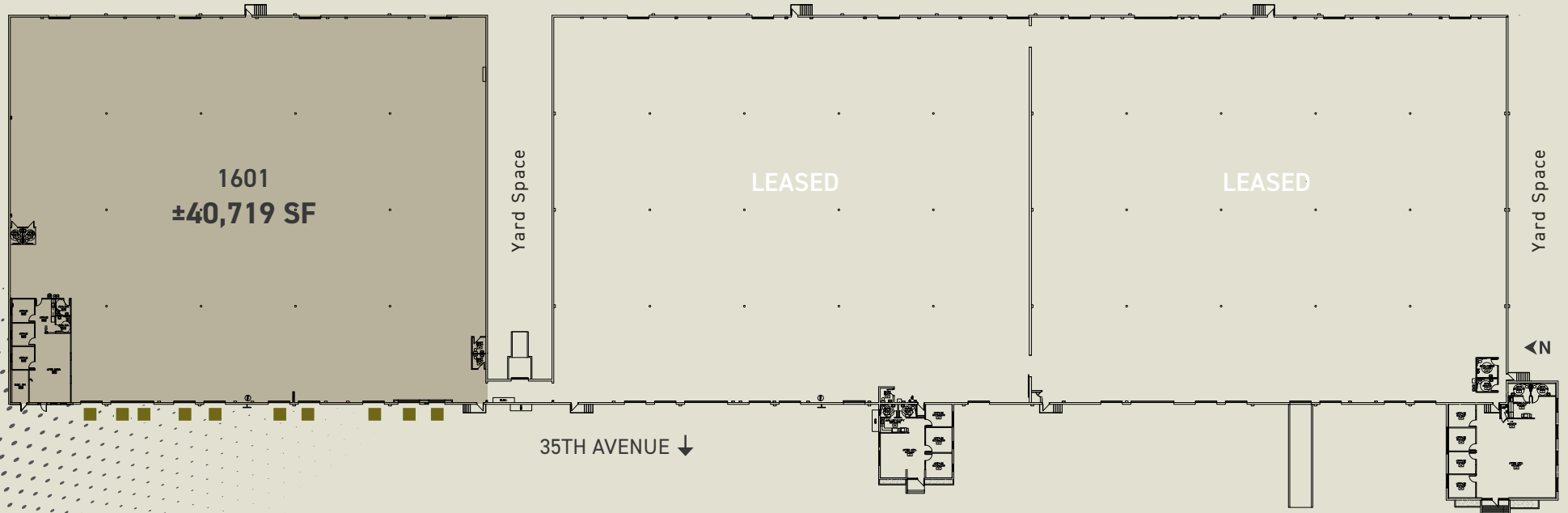

Property Features



±125,091 SF Building



Southwest Gas Service



Century Link & Cox Internet



ESFR Sprinklers



R-30 Roof Deck Insulation



Fenced & Secured Lot

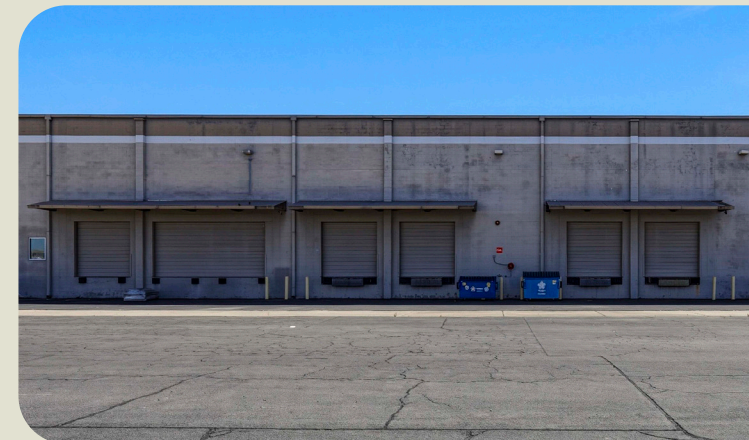

+40,719 SF AVAILABLE

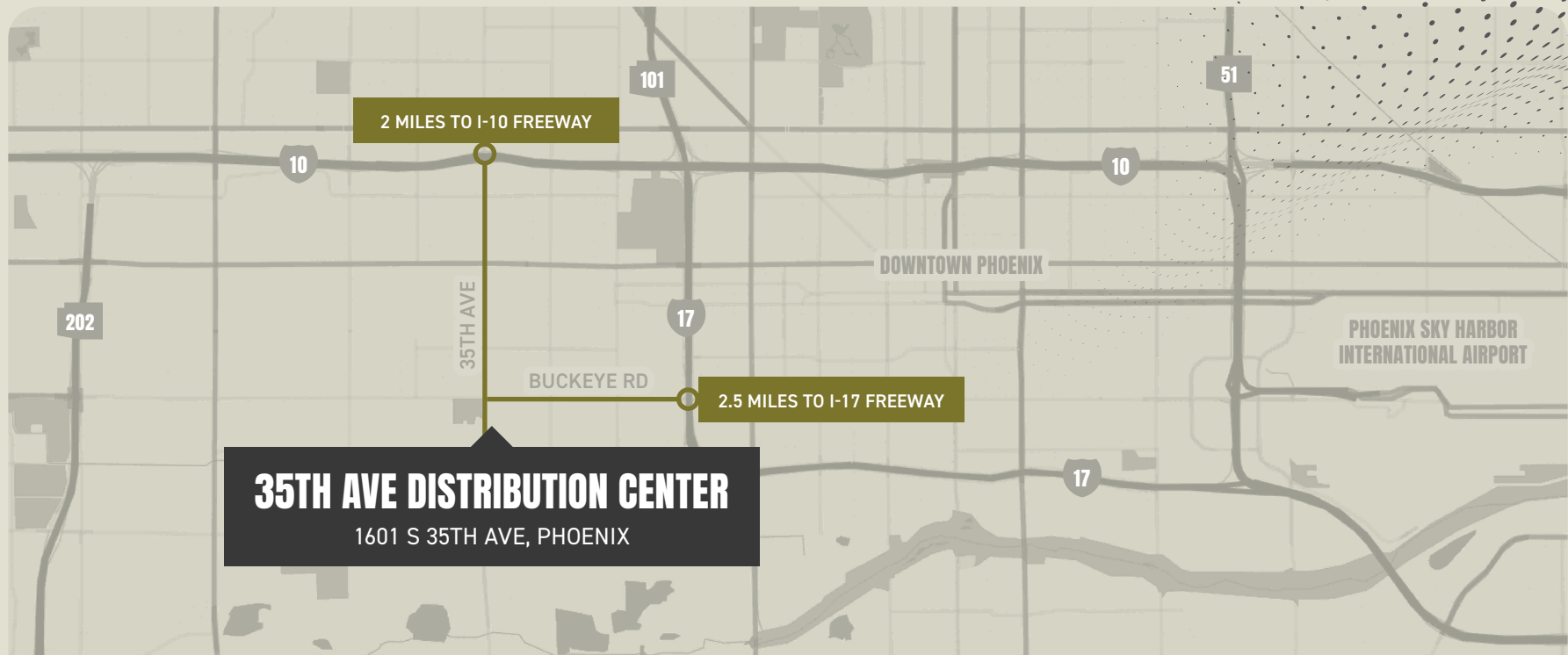

CONTACT US

JONATHAN TEETER

Senior Vice President
+1 602 810 8373
jonathan.teeter@cbre.com

JOHN GRADY

Vice Chairman
+1 480 276 5970
john.grady@cbre.com

ANDREW MCCURDY

Associate
+1 602 558 7997
andrew.mccurdy@cbre.com

CBRE



© 2026 CBRE, Inc. All rights reserved. This information has been obtained from sources believed reliable but has not been verified for accuracy or completeness. CBRE, Inc. makes no guarantee, representation or warranty and accepts no responsibility or liability as to the accuracy, completeness, or reliability of the information contained herein. You should conduct a careful, independent investigation of the property and verify all information. Any reliance on this information is solely at your own risk. CBRE and the CBRE logo are service marks of CBRE, Inc. All other marks displayed on this document are the property of their respective owners, and the use of such marks does not imply any affiliation with or endorsement of CBRE. Photos herein are the property of their respective owners. Use of these images without the express written consent of the owner is prohibited.