

Penta Pacific Properties

9500 Norwalk Blvd Santa Fe Springs, CA 90670 | 562-699-1922

Available SF 6,344 SF

Industrial Condo For Sale

Building Size 6,344 SF



Property Name: Brea Industrial Complex
Address: 950 W Central Ave, Unit D, Brea, CA 92821
Cross Streets: W Central Ave/N Puente St

Industrial Condo / 19' Min. Clear
 Corner Unit / Sprinklered / Racks Included
 1 Oversized GL Door (14' x 14')
 Easy Access to 57 Fwy
 400A / 120/208V / 3PH

Sale Price: \$2,531,888.00
Sale Price/SF: \$399.10
Available SF: 6,344 SF
Prop Lot Size: 1.84 Ac / 80,257 SF
Taxes: \$18,014 / 2025
Yard: No
Zoning: M-1

Sprinklered: Yes
Clear Height: 19'
GL Doors/Dim: 1 / 14'x14'
DH Doors/Dim: 0
A: 400 V: 120/208 O: 3 W:
Construction Type:
Const Status/Year Blt: Existing / 1985

Whse HVAC: No
Parking Spaces: 12 / **Ratio:** 1.9:1
Rail Service: No
Specific Use: Warehouse/Distribution

Office SF / #: 2,615 SF / 5
Restrooms: 2
Office HVAC: Heat & AC
Finished Ofc Mezz: 0 SF
Include In Available: No
Unfinished Mezz: 200 SF
Include In Available: Yes
Possession: COE
Vacant: No
To Show: Call broker
Market/Submarket: OC North
APN#: 938-90-104

Listing Company: Penta Pacific Properties
Agents: [Douglas Wells 562-908-6012](mailto:douglas.wells@pentapacific.com)

Listing #: 45174180

Listing Date: 07/01/2026

FTCF: CB000N00S250/OAA

Notes: 3 private offices + 2 restrooms + coffee bar; 2 showrooms may be used for offices. (See reverse.) HOA. Warehouse racks included in the sale.

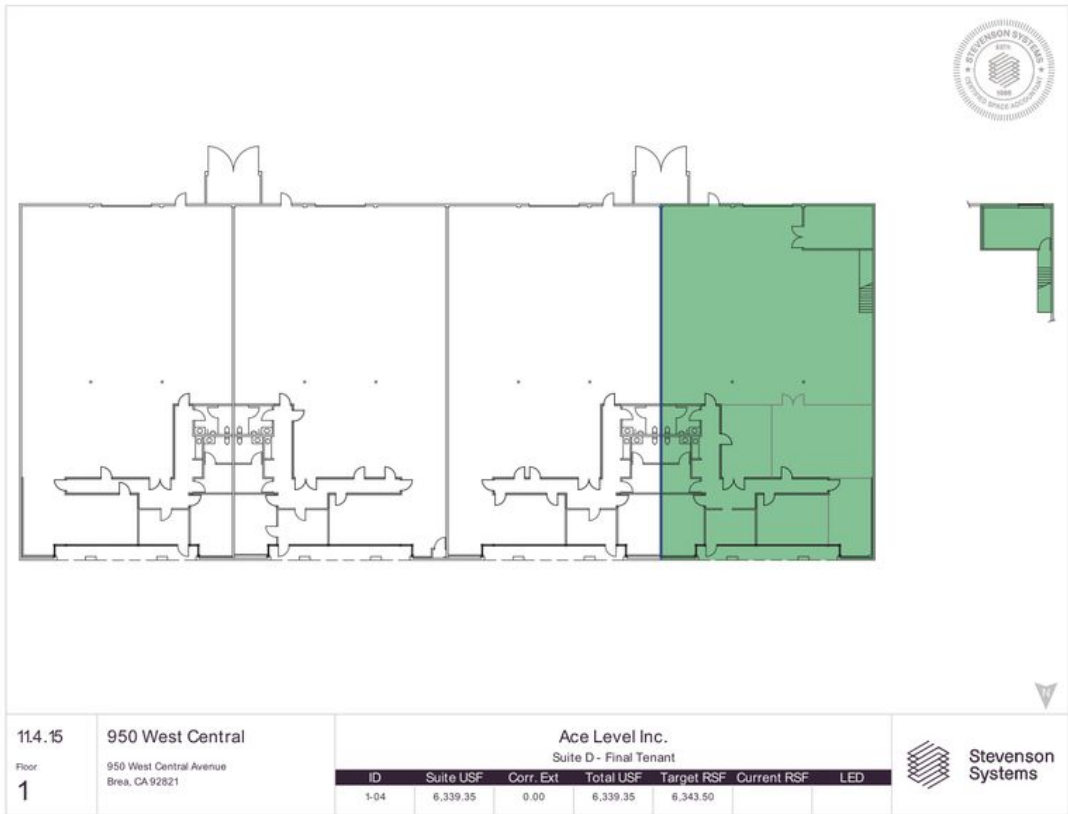

© Stevenson Systems Inc. (2015) 95002