

MEDICAL SPACE AVAILABLE FOR LEASE



IRONWOOD VILLAGE SUITES *FOR LEASE*

9953 N 95th St, Suite 105, Scottsdale, AZ 85258

PROPERTY FEATURES / HIGHLIGHTS

- ±2,710 SF available
- \$30.00/SF NNN lease rate
- 0.7 Miles from HonorHealth Scottsdale Shea Medical Center
- Easy access to Loop 101 Freeway and Shea Blvd
- 3 Reserved parking spaces
- Upgraded modern interior finishes
- Perfect for Medical Users



FLOORPLAN - SUITE 105



VIEW VIRTUAL TOUR

±2,710 SF AVAILABLE

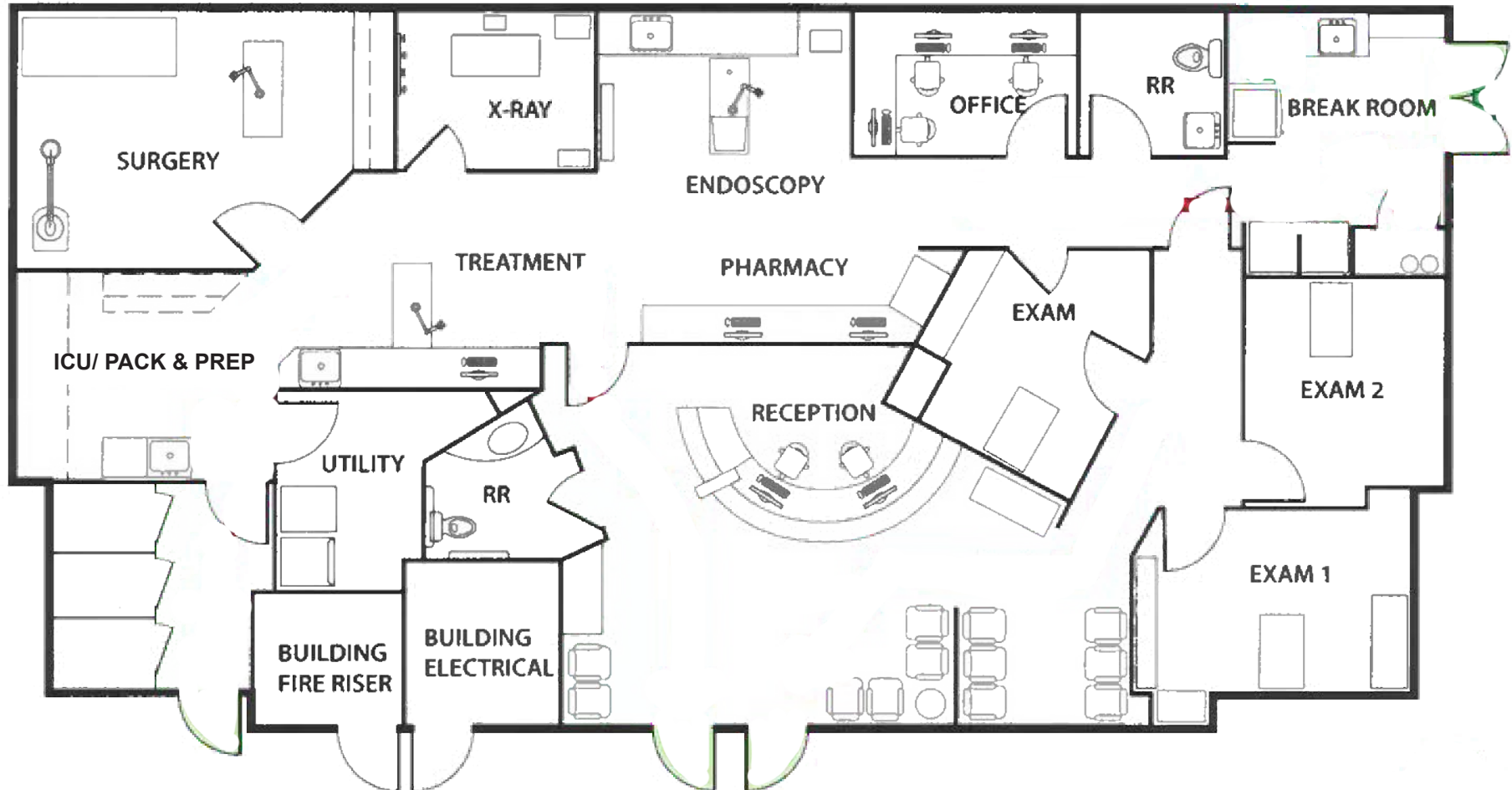

PROPERTY PHOTOS



IRONWOOD VILLAGE SUITES

9953 N 95th St, Suite 105, Scottsdale, AZ 85258

KATHLEEN MORGAN

Managing Director

T (602) 809-1048

Kathleen.morgan@transwestern.com

KEVIN SMIGIEL

Vice President

T (602) 550-9295

Kevin.smigiel@transwestern.com

VINCE FEMIANO

Managing Director

T (602) 791-3310

Vince.femiano@transwestern.com

ANDREW OLIVET

Associate

T (602) 370-2685

Andrew.olivet@transwestern.com

The information provided herein was obtained from sources believed reliable; however, Transwestern makes no guarantees, warranties or representations as to the completeness or accuracy thereof. The presentation of this property is submitted subject to errors, omissions, change of price or conditions, prior sale or lease, or withdrawal without notice. Copyright © 2025 Transwestern



TRANSWESTERN