

**TERMINAL 1 -  
PORT OF VANCOUVER**  
VANCOUVER, WASHINGTON

**4 RETAIL SPACES  
AVAILABLE**

**LINCOLN  
PROPERTY  
COMPANY**



# BUILDING OVERVIEW

Available together or individually, the Terminal 1 building features four retail spaces that will be delivered in Q3 of 2024. The building is currently 100% leased to ZoomInfo Technologies (ZI) as their World Headquarters, which will create 2,500 to 3,000 new jobs. Just steps away, the building is part of Terminal 1, a mixed-use development that includes:

- The newly completed AC Marriott, featuring 150 guest rooms, 4,000 square feet of meeting space, and a riverside bar.
- The proposed Terminal 1 Public Market, which will encompass 40,000 square feet of retail and restaurants.
- A riverside amphitheater that will host events and concerts.
- A public boat dock that will provide locals with opportunities for boating, kayaking, paddleboarding, and swimming.



## AVAILABLE SUITES:

**Space 102** - 1,600 RSF

**Space 106** - 4,250 RSF

**Space 104** - 2,480 RSF

**Space 108** - 3,530 RSF



## BUILDING FEATURES

- » Complete Perimeter Storefront
- » Exposed Concrete Ceilings\*
- » 14'+ Clear Ceiling Height
- » Slab to be Provided by Tenant
- » 2 Points Of Entry
- » Exterior Canopies
- » Exterior Seating Potential
- » Gas Stub-In
- » Cold Water Stub-In
- » 4" Grease Waste Line
- » Power & Data Stub-In
- » Lighting to be Provided by Tenant
- » HVAC to be Provided by Tenant

\*Some portions of ceiling may not be exposed



# BUILDING SNAPSHOT



# AVAILABLE SUITES

## RETAIL SPACE 108

 **SIZE:** 3,530 SF

 **FRONTAGE:** Columbia Way & Quayside Place

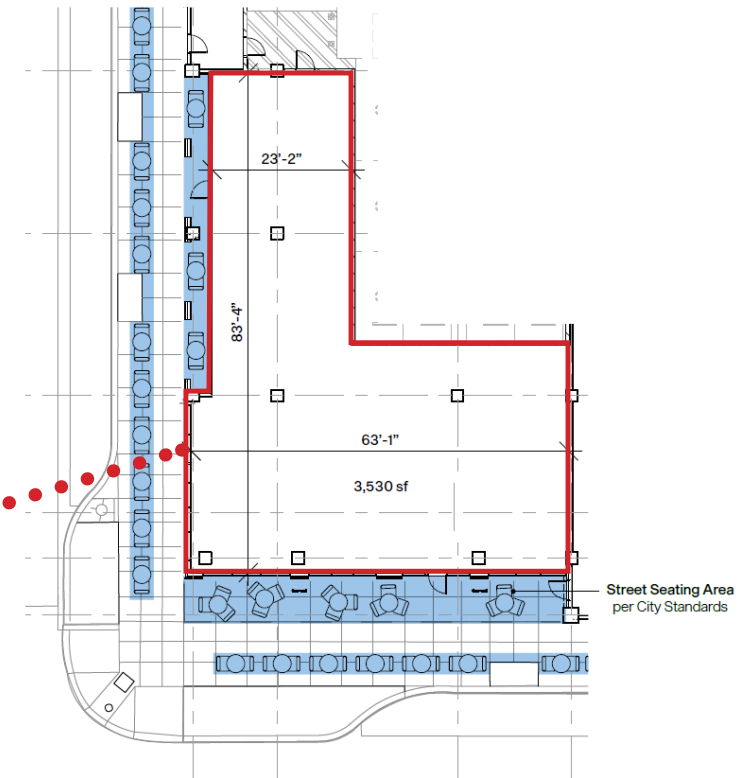
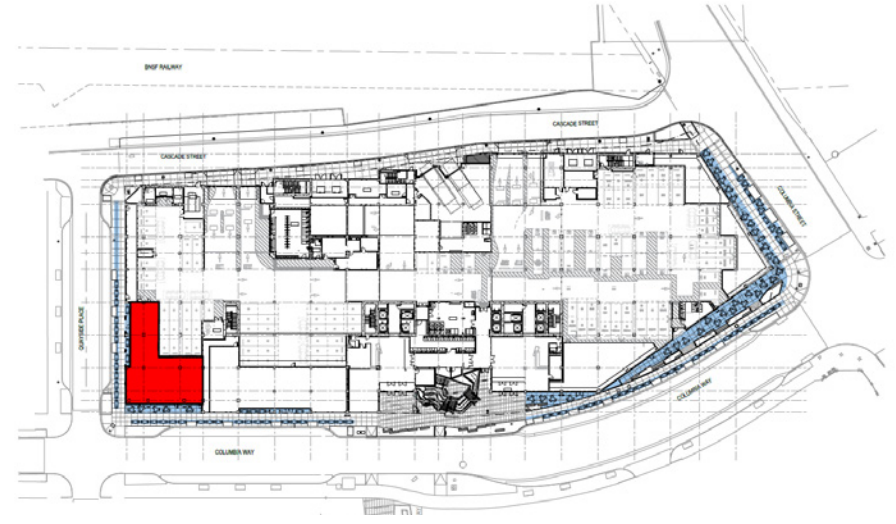

# THE WATERFRONT

## VANCOUVER, WASHINGTON

The Waterfront is a 20-block, 32-acre riverfront development with unparalleled views of the Columbia River. The development connects downtown Vancouver, exclusively Terminal 1, to the waterfront with a 5-minute walk.

Situated in a highly-desirable location, The Waterfront has become part of Vancouver's urban core and is transforming the immediate area into one of Washington's most dynamic live-work-play environments with intrinsic qualities to fuel its growth and momentum well into the foreseeable future. The State-of-the-art green spaces, including walking and biking trails, public parks, and natural habitats, make this an attractive place to visit and stay.

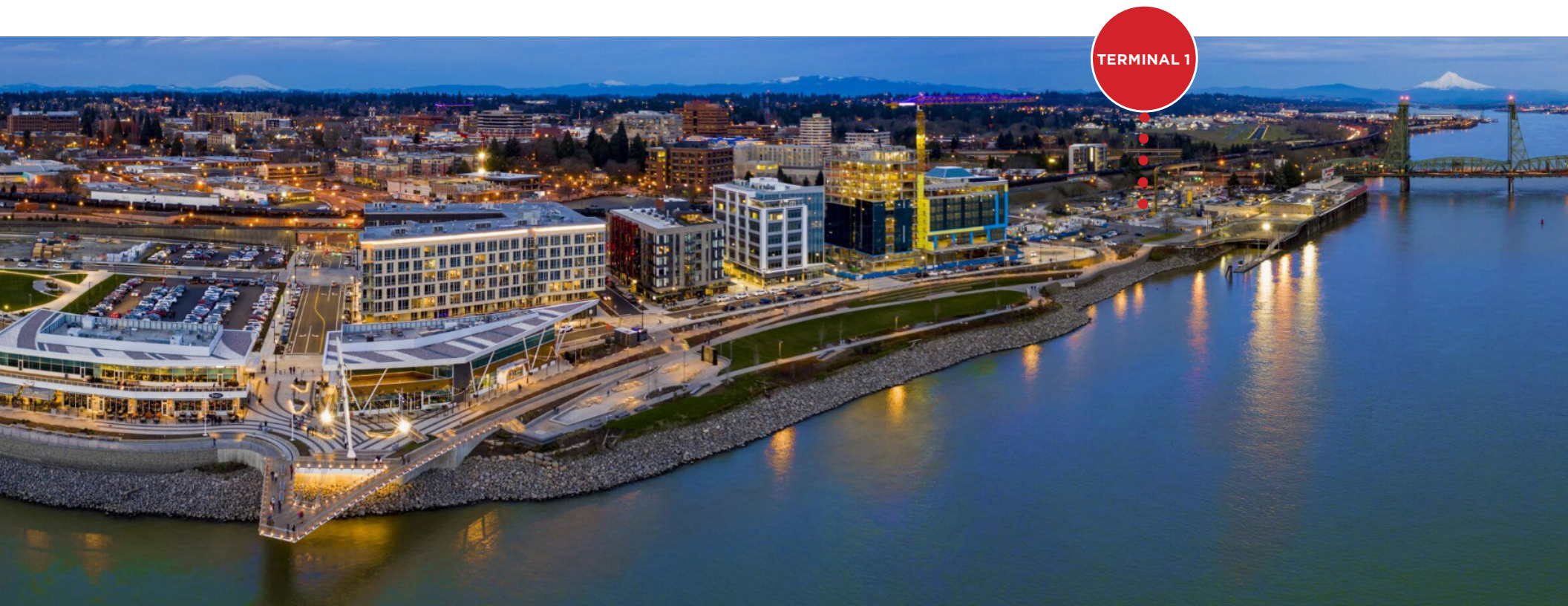
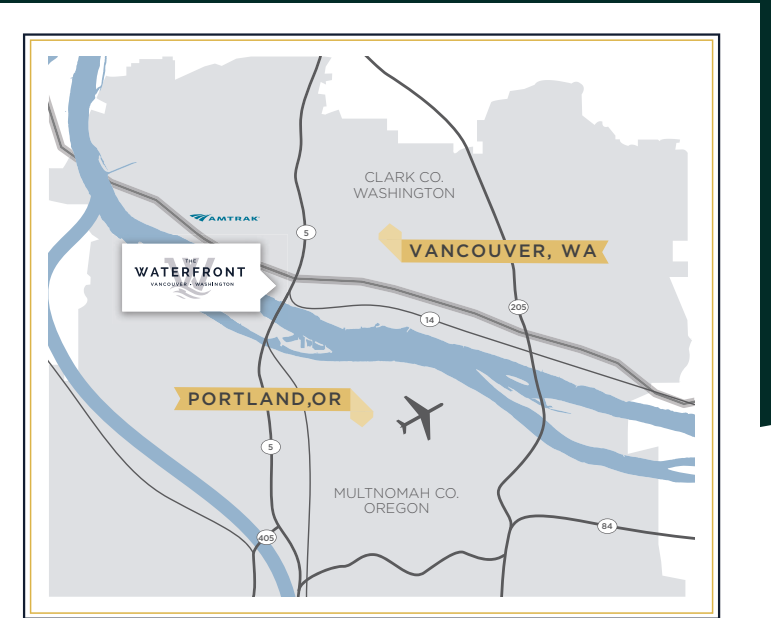

# THE WATERFRONT

VANCOUVER • WASHINGTON

DOWNTOWN VANCOUVER

DOWNTOWN PORTLAND



**MODERA VANCOUVER**  
(BLOCK 21)  
Mill Creek Residential  
14-story, 285 apartments,  
underground parking  
Construction to start Spring 2023

**BLOCK 19**  
Alliance Residential  
7-story, 180 apartments,  
underground parking  
Anticipated to open 2024

**BROADSTONE CLARO**  
(BLOCK 17)  
Alliance Residential Company  
7-story, 178 unit  
apartment building  
Anticipated to open Dec. 2022

**RIVERWEST** (BLOCK 8)  
HSP Properties  
• Airfield Estates  
• Charles Schwab  
• Orangetheory Fitness  
• People's Community  
• Federal Credit Union  
206 Apartments over Retail

**REDIVIVA** (BLOCK 6 WEST)  
Gramor Development  
• Barnard Griffin Winery  
• Brian Carter Cellars  
• Pepper Bridge Winery &  
Amavi Cellars  
• Stack 571 Burger &  
Whiskey Bar  
• Valo & Massalto  
63 Apartments over Retail

**THE COLUMBIA AT THE WATERFRONT**  
(BLOCK 20)  
Jackson Square Properties  
248 apartments

**BLOCK 15**  
Interior Park

BLOCK 14  
TEMP SURFACE  
PARKING

BLOCK 10  
TEMP SURFACE  
PARKING

**BLOCK 7**  
Proposed 830-space, 8-story  
parking garage and 11,200 SF of  
ground floor retail  
Anticipated to open 2024

**THE MURDOCK** (BLOCK 6 EAST)  
Gramor Development  
• OnPoint CCU  
• Ruse Brewing Crust Collective  
• The Yard Milkshake Bar  
Class A Office Over Retail

**WATERFRONT PARK**

**THE SPRINGS LIVING AT THE WATERFRONT**  
(BLOCK 18)  
Planned for 250 apartments  
Anticipated to open 2024

BLOCK 16

BLOCK 11  
TEMP SURFACE  
PARKING

BLOCK 7  
TEMP SURFACE  
PARKING

BLOCK 5  
TEMP SURFACE  
PARKING

**BLOCK 3**  
Summit Development  
High-Rise Residential  
180 Apartment Units  
Anticipated to open 2023

**THE DON** (BLOCK 12)  
Gramor Development  
• Maryhill Winery  
• Twigs Bistro & Martini Bar  
• Waterfront Taphouse  
• Willamette Valley Vineyards

**HOTEL INDIGO & KIRKLAND TOWER** (BLOCK 4)  
Kirkland Development  
• 13 Coins  
• El Gaucho  
• Evoke Winery  
138 Room Hotel Indigo and  
40 Unit Condominium Building

**THE JEAN** (BLOCK 9)  
Gramor Development  
• DosAlas Latin Kitchen & Tequila Bar  
• WildFin American Grill

**GRANT STREET PIER**  
Cable-Stayed Pier

**WATERFRONT PARK**  
Headwaters Wall Water Feature

**TERMINAL 1**  
Port of Vancouver  
Zoom Info expansion into  
366,000 sf to occupy by 2024  
Vancouver Landing

**BLOCK 1 & 2**  
Lincoln Property Company  
Proposed mixed-use  
24,500 SF retail/restaurant,  
171,000 SF office, 200 apartments  
Anticipated to open 2024

**AC HOTEL BY MARRIOTT**  
Port of Vancouver  
150 Rooms

- PHASE 3 - PLANNED
- PHASE 1 & 2 - OPEN/UNDER CONSTRUCTION
- AVAILABLE FOR SALE

# TERMINAL 1 - PORT OF VANCOUVER 4 RETAIL SPACES AVAILABLE

VANCOUVER, WASHINGTON

LINCOLN  
PROPERTY  
COMPANY

[WWW.LPC.COM](http://WWW.LPC.COM)

FOR ADDITIONAL INFORMATION,  
PLEASE CONTACT:

**LEE MORRISON**  
**SENIOR VICE PRESIDENT**

1211 SW Fifth Avenue  
Suite 700

Portland, OR 97204

O. 503.224.1193 | M. 916.716.9534

[LMorrison@LPC.com](mailto:LMorrison@LPC.com)

