

COLONIAL GARDENS

15080 W. Colonial Drive | Winter Garden, FL 32826
Pre-Leasing Retail Strip Center & Outparcels



LQ Commercial
REAL ESTATE SERVICES

LQCRE.COM

GOOGLE TOUR

1.0 - 2.81 AC
For Ground Lease
Or Build To Suit



CALL FOR SHOP SPACE &
PAD/BUILD-TO-SUIT RATES



TOTAL GLA:
20,000 SF



FROM 2,000 - 7,000 SF +
1.0 - 2.81 AC PAD SITES



DAILY TRAFFIC:
55,000 CARS PER DAY

- Pre-leasing *Colonial Gardens* retail strip center in Winter Garden, FL (Orlando MSA).
- 20,000 GLA (from 2,000 - 7,000 SF), with estimated Q327 delivery.
- Pad sites from 1.0 - 2.81 AC also for ground lease or build-to-suit.
- 563' + Frontage along W. Colonial Drive / State Road 50.
- Signalized, hard corner with strong SR 50 visibility and 55,000 cars per day.



5-MI TOTAL POP
103,437



5-MI AVG HH INCOME
\$151,778



5-MI HOUSEHOLDS
36,575



5-MI # EMPLOYEES
37,993

[PROPERTIES.LQCRE.COM/COLONIAL-GARDENS](https://properties.lqcre.com/colonial-gardens)



Maitland, FL 32751
500 Winderley Pl #104
LQCRE.COM

Julia Sosa
Founding Principal - Orlando
D: 407.775.4358
C: 407.257.8246
jsosa@lqcre.com

Tom Heer
Senior Associate
D: 407.775.4361
C: 407.399.6748
theer@lqcre.com

Information obtained from owner(s) or other sources deemed reliable. We have no reason to doubt its accuracy, but cannot guarantee it. All properties subject to change or withdrawal without notice.

COLONIAL GARDENS

15080 W. Colonial Drive | Winter Garden, FL 32826
Pre-Leasing Retail Strip Center & Outparcels



LQ Commercial
REAL ESTATE SERVICES

LQCRE.COM

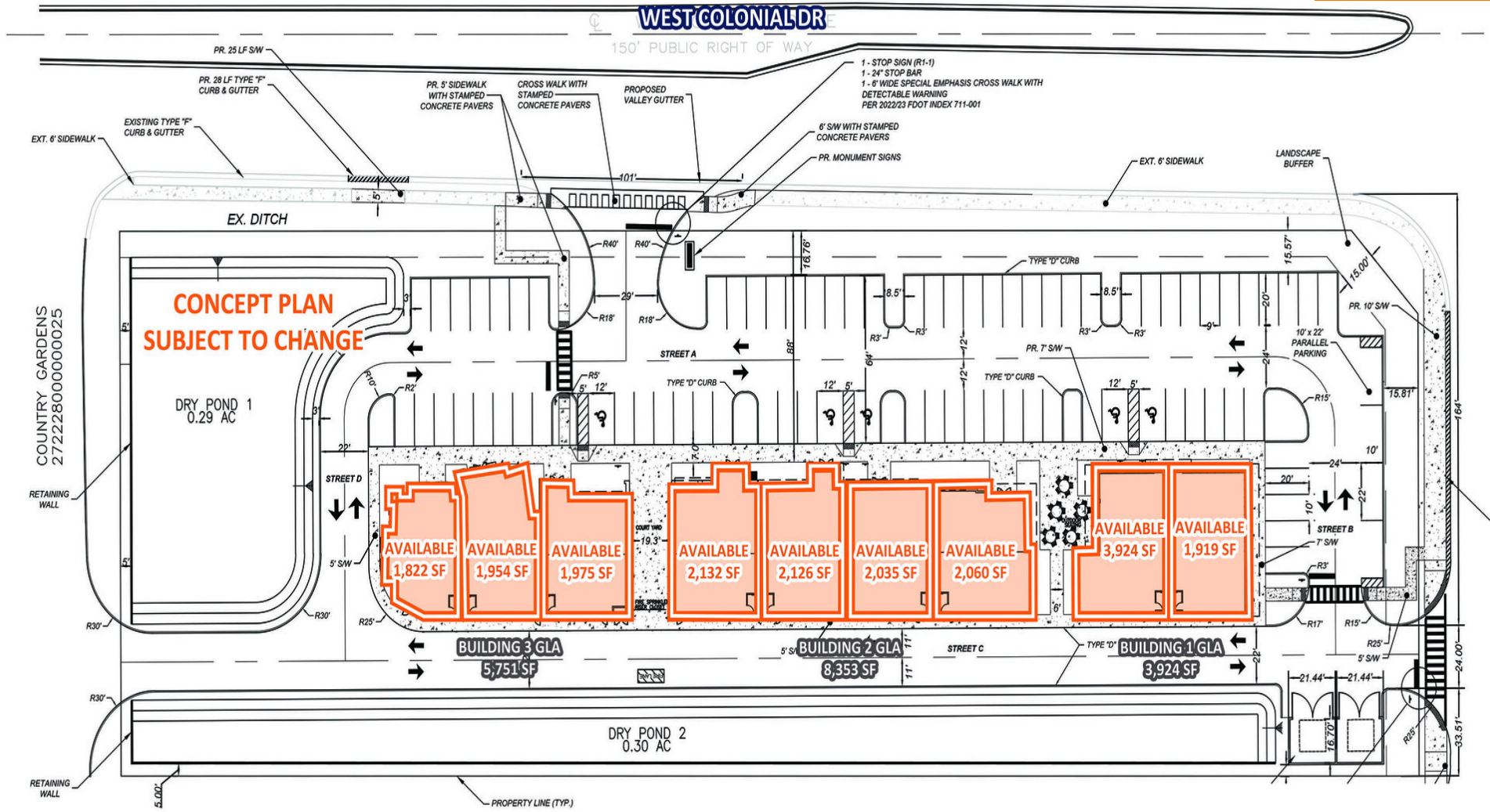

Maitland, FL 32751
500 Winderley Pl #104
LQCRE.COM

Julia Sosa
Founding Principal - Orlando
D: 407.775.4358
C: 407.257.8246
jsosa@lqcre.com

Tom Heer
Senior Associate
D: 407.775.4361
C: 407.399.6748
theer@lqcre.com

COLONIAL GARDENS

15080 W. Colonial Drive | Winter Garden, FL 32826
Pre-Leasing Retail Strip Center & Outparcels



LQ Commercial
REAL ESTATE SERVICES

LQCRE.COM



Maitland, FL 32751
500 Winderley Pl #104
LQCRE.COM

Julia Sosa

Founding Principal - Orlando

D: 407.775.4358

C: 407.257.8246

jsosa@lqcre.com

Tom Heer

Senior Associate

D: 407.775.4361

C: 407.399.6748

theer@lqcre.com

Information obtained from owner(s) or other sources deemed reliable. We have no reason to doubt its accuracy, but cannot guarantee it. All properties subject to change or withdrawal without notice.

COLONIAL GARDENS

15080 W. Colonial Drive | Winter Garden, FL 32826
Pre-Leasing Retail Strip Center & Outparcels



LQ Commercial
REAL ESTATE SERVICES

LQCRE.COM

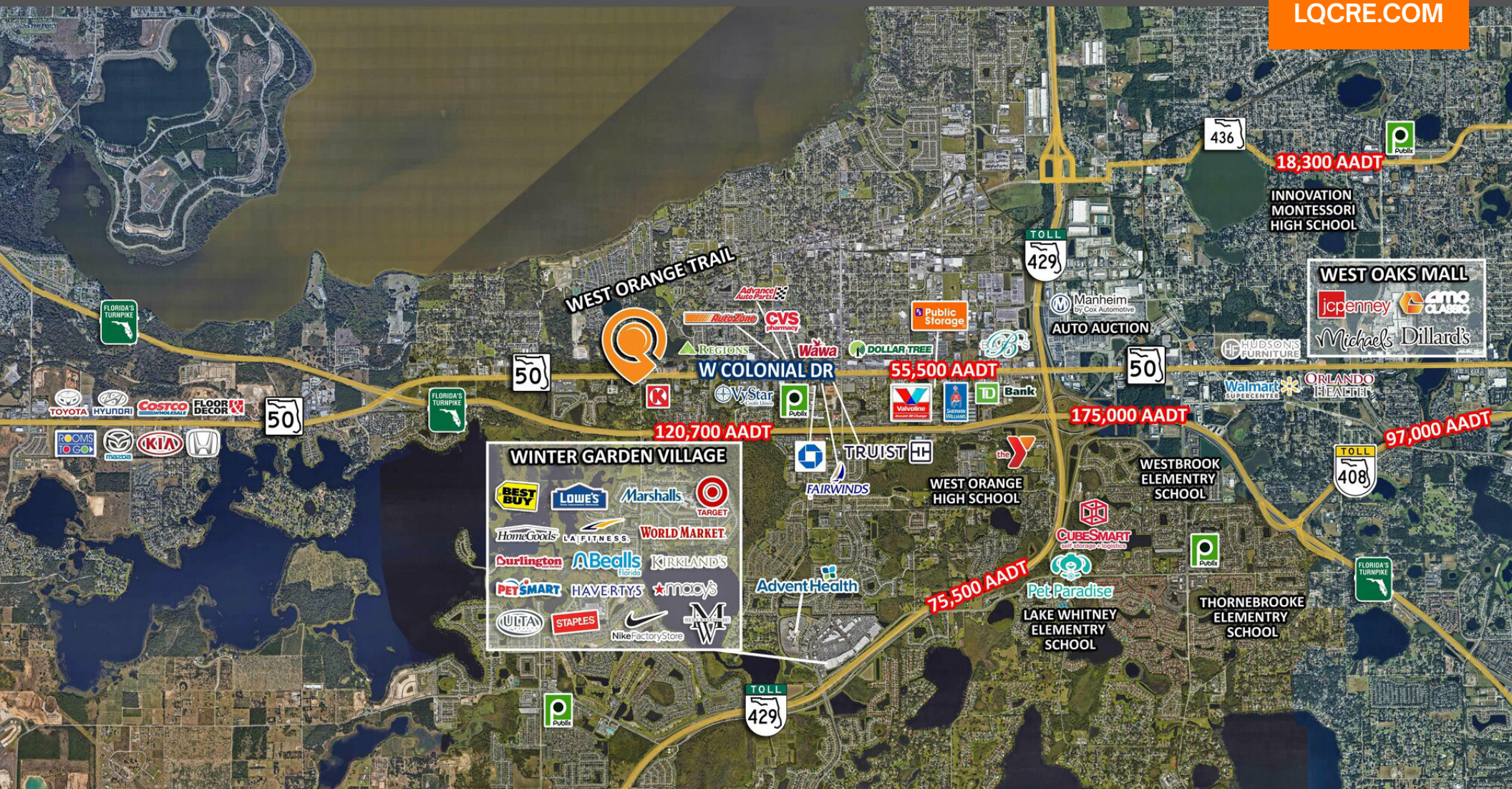

LQ Commercial
REAL ESTATE SERVICES

Maitland, FL 32751
500 Winderley Pl #104
LQCRE.COM

Julia Sosa

Founding Principal - Orlando
D: 407.775.4358
C: 407.257.8246
jsosa@lqcre.com

Tom Heer

Senior Associate
D: 407.775.4361
C: 407.399.6748
theer@lqcre.com