



at home



The Home Décor Super

Space for Lease

905 S. 24th Street W
Billings, MT 59102

Leasing Contact

Kevin Cremer

SVP, Leasing

+1 406 2814925

kevin.cremer@jll.com

MT License # RRE-RBS-LIC-87915

101,584 SF Retail Box (Former At Home)

Highlights:

- 8.228 Acres with 448 Parking Stalls
- 340' Frontage and 299' Depth
- 20' Clear Height
- 3 Bay Loading Dock
- Adjacent to Former Costco
- Rimrock Mall is 1 mile away
- King Ave ADT is 28,731
- Located near the Interstate on the corner of King Ave W. and 24th



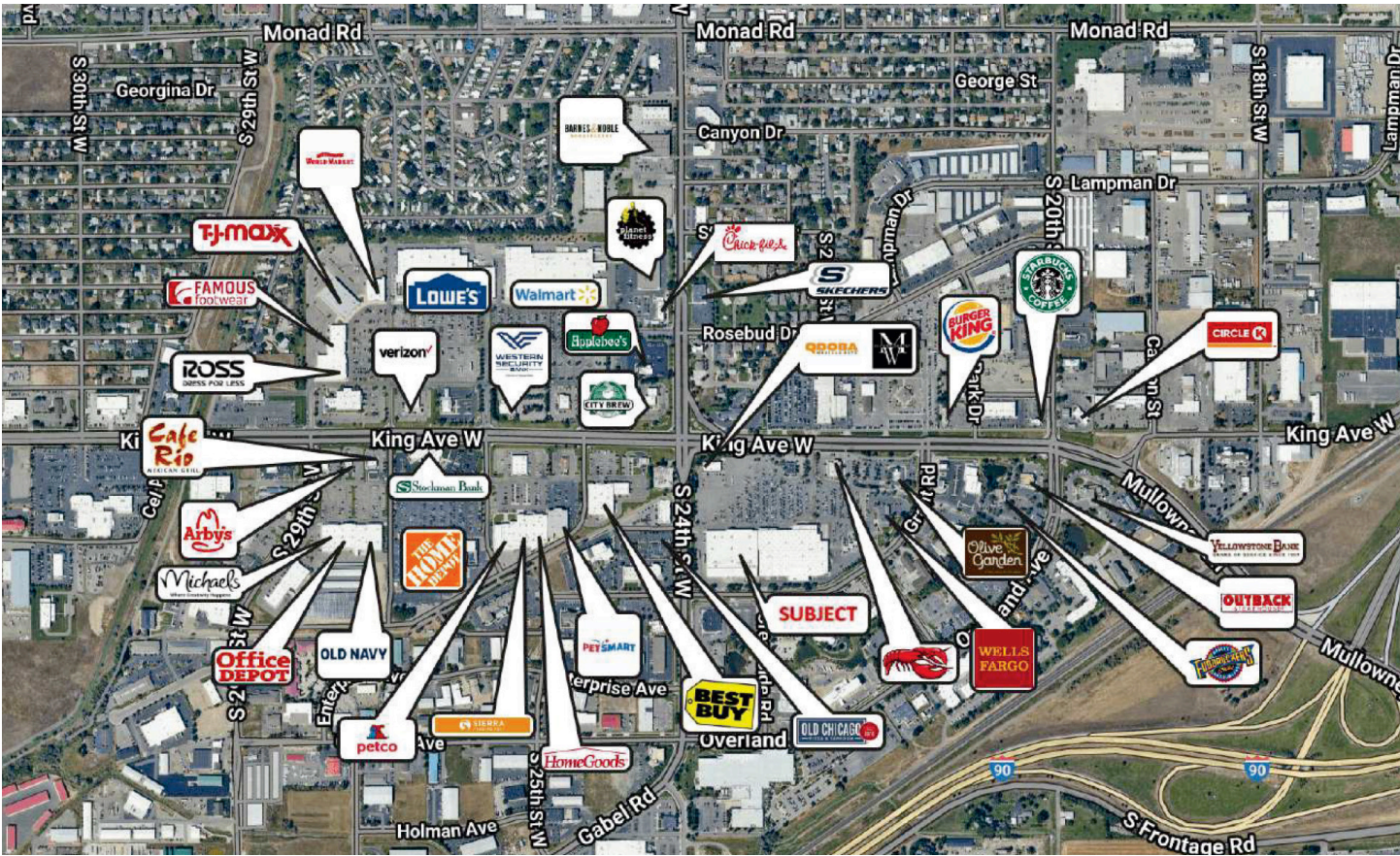

Site plan

905 S. 24th Street W
Billings, MT 59102

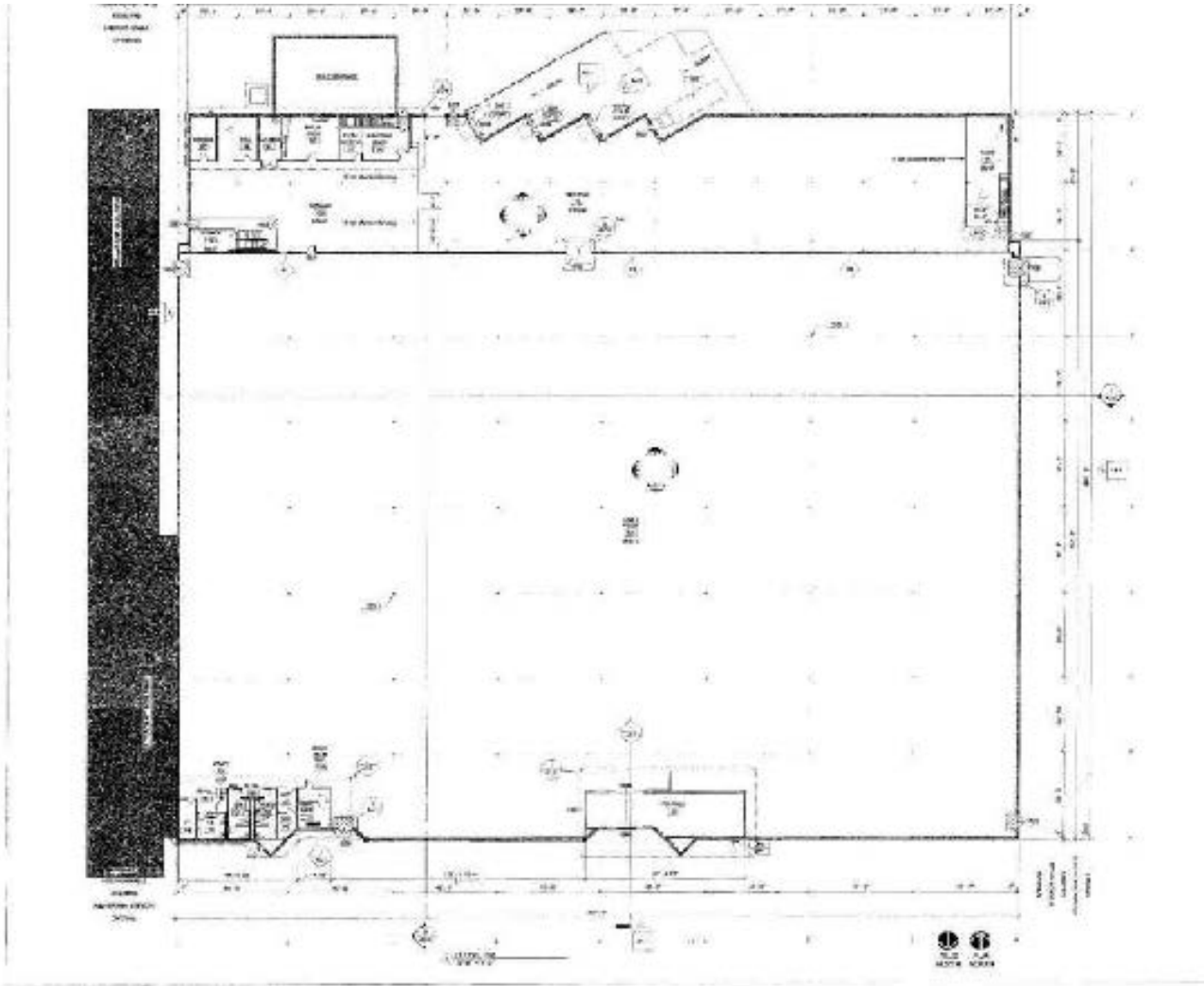

Area Profile	3-mile radius	10-mile radius	20-mile radius
Est. Population	57,382	150,126	173,533
Est. Households	25,893	61,873	71,024
Avg. Household Income	\$92,083	\$101,196	\$102,026
Median Age	39.3	39.5	39.8

Source: Esri, 2026



Although information has been obtained from sources deemed reliable, JLL does not make any guarantees, warranties or representations, express or implied, as to the completeness or accuracy as to the information contained herein. Any projections, opinions, assumptions or estimates used are for example only. There may be differences between projected and actual results, and those differences may be material. JLL does not accept any liability for any loss or damage suffered by any party resulting from reliance on this information. If the recipient of this information has signed a confidentiality agreement with JLL regarding this matter, this information is subject to the terms of that agreement. ©2020. Jones Lang LaSalle IP, Inc. All rights reserved.